

# OFFERING MEMORANDUM

980 Little East Neck Road | West Babylon, New York 11704

**FOR SALE & LEASE**



Commercial



# EXECUTIVE SUMMARY

980 Little East Neck Road | West Babylon, New York 11704

<b>Building Size:</b>	11,163 SF	<b>Lot Size:</b>	0.503 Acres
<b>Available SF For Lease:</b>	4,000 SF	<b>Zoning:</b>	E Business
<b>Year Built:</b>	1959	<b>Sale Price:</b>	\$3,000,000

## Property Overview

Completely renovated in 2025, this highly functional mixed-use industrial property offers a rare opportunity for owner-users in West Babylon. The property features approximately 11,163 SF with a strong blend of warehouse, office, and showroom space, including 16' clear ceilings, three overhead doors, and 600 amp power.

## Property Highlights

- Ideal Uses: Electrical / Plumbing / HVAC Contractor / Kitchen Showroom
- Showroom & Warehouse Combination
- Corner Parcel with Strong Visibility
- Immaculate Condition- Move in Ready

*Exclusively represented by:*

**Michael Gronenthal**

Licensed Associate Real Estate Broker  
516.439.6789 Email: michael.gronenthal@elliman.com

**Dennis Gandley**

Licensed Real Estate Salesperson  
631.858.2406 Email: dennis.gandley@elliman.com

# PROPERTY DETAILS

980 Little East Neck Road | West Babylon, New York 11704

**Sale Price** **\$3,000,000**

**Lease Rate** **\$25 SF/Yr**

## Location Information

<b>Street Address</b>	980 Little East Neck Road
<b>City, State, Zip</b>	West Babylon, NY 11704
<b>County</b>	Suffolk
<b>Township</b>	Town of Babylon

## Building Information

<b>Building Size</b>	11,163 SF
<b>Completely Renovated</b>	2025
<b>Ceiling Heights</b>	16' Clear in the Warehouse
<b>Heating</b>	Gas
<b>Power</b>	600 Amps
<b>Loading</b>	Three (3) Overhead Doors
<b>Warehouse</b>	+/- 7,000 SF
<b>Office / Showroom</b>	+/- 4,000 SF

## Property Information

<b>Property Type</b>	Industrial / Retail - Office
<b>Zoning</b>	E Business
<b>Lot Size</b>	.503 Acres
<b>Property Taxes</b>	\$36,821.68
<b>APN #</b>	0100-138-00-01-00-092-001
<b>Corner Parcel</b>	Yes
<b>Sanitary</b>	Sewer

*Exclusively represented by:*

**Michael Gronenthal**

Licensed Associate Real Estate Broker  
516.439.6789 Email: michael.gronenthal@elliman.com

**Dennis Gandley**

Licensed Real Estate Salesperson  
631.858.2406 Email: dennis.gandley@elliman.com





# ADDITIONAL PHOTOS

980 Little East Neck Road | West Babylon, New York 11704



Exclusively represented by:

**Michael Gronenthal**

Licensed Associate Real Estate Broker  
516.439.6789 Email: michael.gronenthal@elliman.com

**Dennis Gandley**

Licensed Real Estate Salesperson  
631.858.2406 Email: dennis.gandley@elliman.com

# ADDITIONAL PHOTOS

980 Little East Neck Road | West Babylon, New York 11704



*Exclusively represented by:*

**Michael Gronenthal**

Licensed Associate Real Estate Broker  
516.439.6789 Email: [michael.gronenthal@elliman.com](mailto:michael.gronenthal@elliman.com)

**Dennis Gandley**

Licensed Real Estate Salesperson  
631.858.2406 Email: [dennis.gandley@elliman.com](mailto:dennis.gandley@elliman.com)



# REGIONAL MAP

980 Little East Neck Road | West Babylon, New York 11704

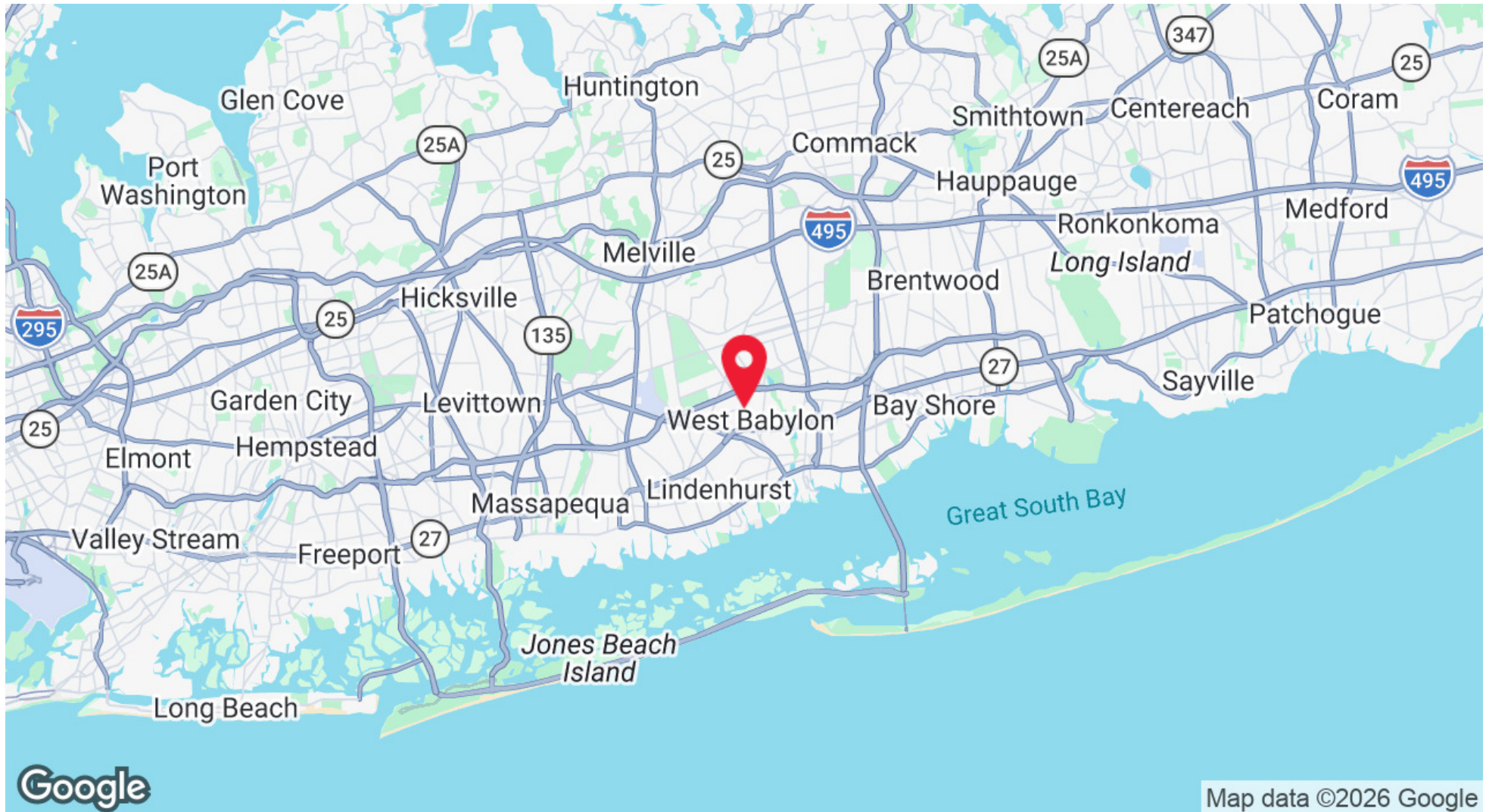

Exclusively represented by:

**Michael Gronenthal**

Licensed Associate Real Estate Broker  
516.439.6789 Email: michael.gronenthal@elliman.com

**Dennis Gandley**

Licensed Real Estate Salesperson  
631.858.2406 Email: dennis.gandley@elliman.com

# PARCEL MAP

980 Little East Neck Road | West Babylon, New York 11704

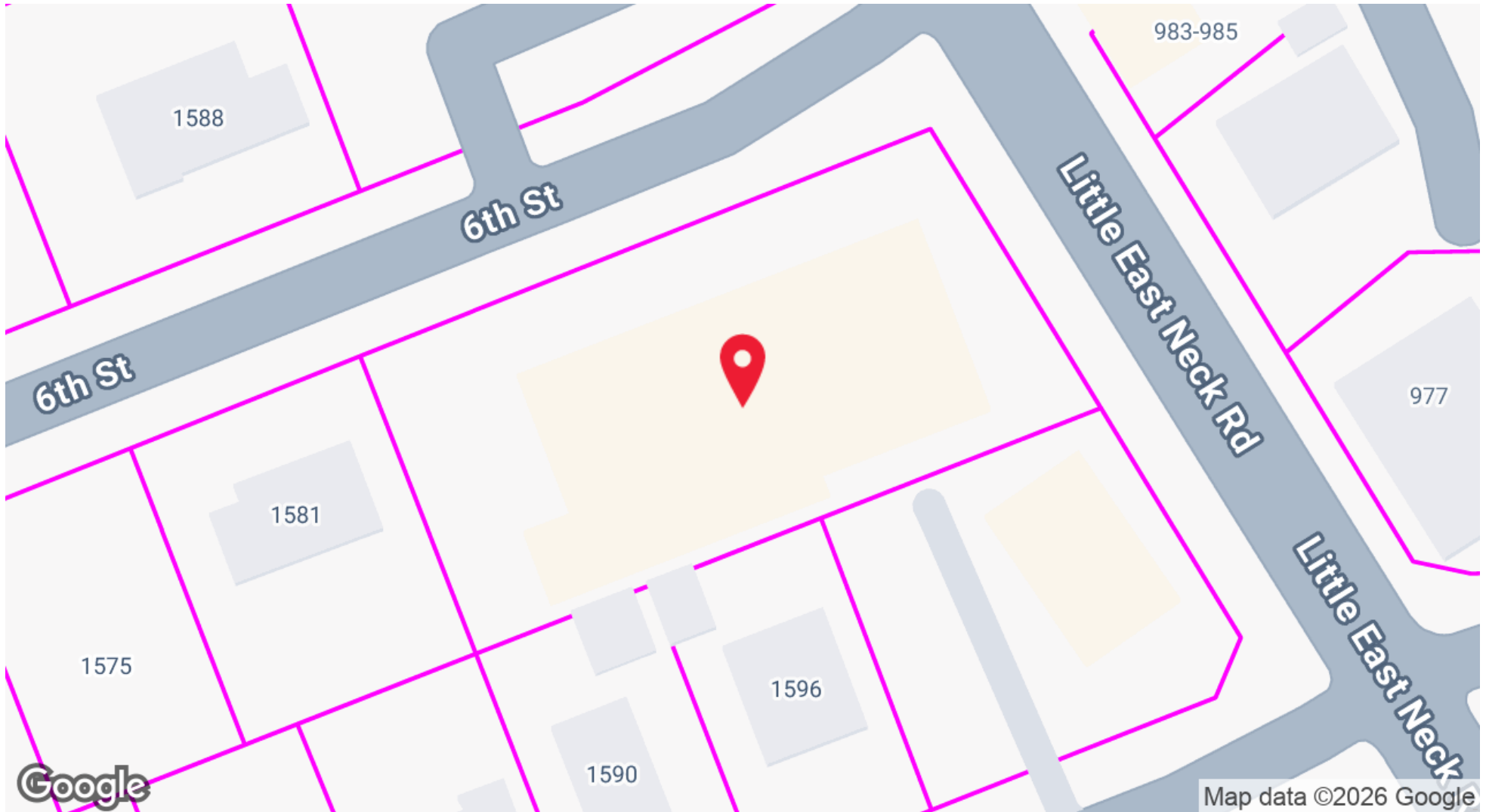

Exclusively represented by:

**Michael Gronenthal**

Licensed Associate Real Estate Broker  
516.439.6789 Email: michael.gronenthal@elliman.com

**Dennis Gandley**

Licensed Real Estate Salesperson  
631.858.2406 Email: dennis.gandley@elliman.com

# DEMOGRAPHICS MAP & REPORT

980 Little East Neck Road | West Babylon, New York 11704

Population	1 Mile	3 Miles	5 Miles
<b>Total Population</b>	21,498	129,880	295,415
<b>Average Age</b>	40.7	41.1	41.2
<b>Average Age (Male)</b>	39.7	39.4	39.5
<b>Average Age (Female)</b>	41.2	42.6	42.6

Households & Income	1 Mile	3 Miles	5 Miles
<b>Total Households</b>	6,533	41,316	94,958
<b># of Persons per HH</b>	3.3	3.1	3.1
<b>Average HH Income</b>	\$155,423	\$154,008	\$163,260
<b>Average House Value</b>	\$524,479	\$521,587	\$560,991

2023 American Community Survey (ACS)

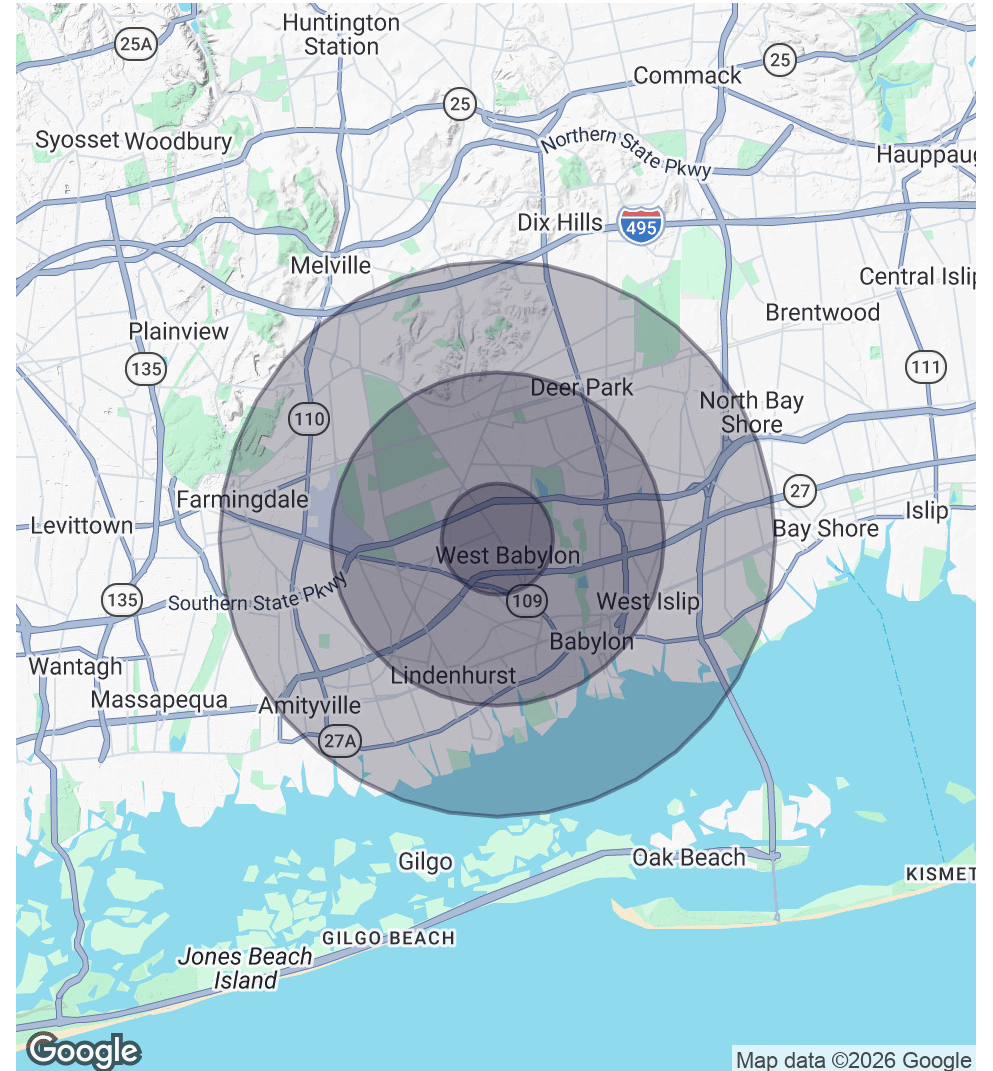

Exclusively represented by:

**Michael Gronenthal**

Licensed Associate Real Estate Broker  
516.439.6789 Email: michael.gronenthal@elliman.com

**Dennis Gandley**

Licensed Real Estate Salesperson  
631.858.2406 Email: dennis.gandley@elliman.com

980 Little East Neck Road | West Babylon, New York 11704

## EXCLUSIVELY REPRESENTED BY:



**Michael Gronenthal**

Licensed Associate Real Estate Broker

516.439.6789

Email: michael.gronenthal@elliman.com



**Dennis Gandley**

Licensed Real Estate Salesperson

631.858.2406

Email: dennis.gandley@elliman.com



**Commercial**

550 Smithtown Bypass Suite 117

Smithtown, NY 11787

631.858.2405

ellimancommercial.com



## We Are Commercial Real Estate

550 Smithtown Bypass Suite 117  
Smithtown, NY 11787  
631.858.2405  
ellimancommercial.com

Commercial real estate involves more than just property listings. To get the most effective results, you need to partner with a company that has a full complement of services and an in-depth team of professionals to help with all your needs. Douglas Elliman's team of commercial real estate experts is committed to unrivaled performance standards when working with tenants, investors, purchasers and owners. We represent all major property types including office, industrial, retail, apartment and land. We treat each assignment with commitment and focus, from a single transaction in a local market to national and multi-market assignments. We help negotiate contracts, coordinate construction and provide both property management as well as ongoing advisory service to satisfy your changing real estate needs. Our breadth of market knowledge, unprecedented network and use of innovative technology extend to all types of property transactions. For information on our services please contact us today.