



Overland & Ayres

2455 OVERLAND AVENUE
LOS ANGELES, CA 90064

JAY LUCHS
GENNY CHANG
CARLY GELLER

Executive Vice Chairman
Managing Director
Director

310-407-6585
310-407-6588
310-593-0760

jay.luchs@nmrk.com
genny.chang@nmrk.com
carly.geller@nmrk.com

CA RE Lic. #01260345
CA RE Lic. #01467375
CA RE Lic. #02153582

JAYLUCHS.COM
NEWMARK
PACIFIC



ADDRESS
2455 Overland Avenue
Los Angeles, CA 90064

USE
Retail/Fitness/Office

SIZE
Approximately 1,903 SF

RENT
Available upon Request

PROJECT OVERVIEW

Newly signed! Pilates-inspired fitness studio BodyRok

Overland & Ayres is an exquisite, new mixed-use project, featuring 201 residential units and retail/commercial space in West LA.

Adjacent to UCLA's new 700,000 SF multi-billion dollar Research Park and 235,000 SF of Creative Office space.

CEILING HEIGHTS

15'-5"

PARKING

Designated parking available in attached structure

JAY LUCHS
GENNY CHANG
CARLY GELLER

Executive Vice Chairman
Managing Director
Director

310-407-6585
310-407-6588
310-593-0760

jay.luchs@nmrk.com
genny.chang@nmrk.com
carly.geller@nmrk.com

CA RE Lic. #01260345
CA RE Lic. #01467375
CA RE Lic. #02153582

JAYLUCHS.COM
NEWMARK
PACIFIC



Overland & Ayres is a new community at the threshold of LA's bright future. Sophisticated apartment homes and three-story townhomes offering a premium amenity set — from podium pool to outdoor fitness lawn — and convenient access to LA's best neighborhoods.

RESIDENTIAL AMENITIES

Complemented by world-class amenities like the podium pool, fitness club, rooftop lounge, dog park and spa, plus dedicated co-working spaces. Overland & Ayres lays an effortless foundation for an active and inspired lifestyle.



JAY LUCHS
GENNY CHANG
CARLY GELLER

Executive Vice Chairman
Managing Director
Director

310-407-6585
310-407-6588
310-593-0760

jay.luchs@nmrk.com
genny.chang@nmrk.com
carly.geller@nmrk.com

CA RE Lic. #01260345
CA RE Lic. #01467375
CA RE Lic. #02153582

JAYLUCHS.COM
NEWMARK
PACIFIC

AYRES AVENUE

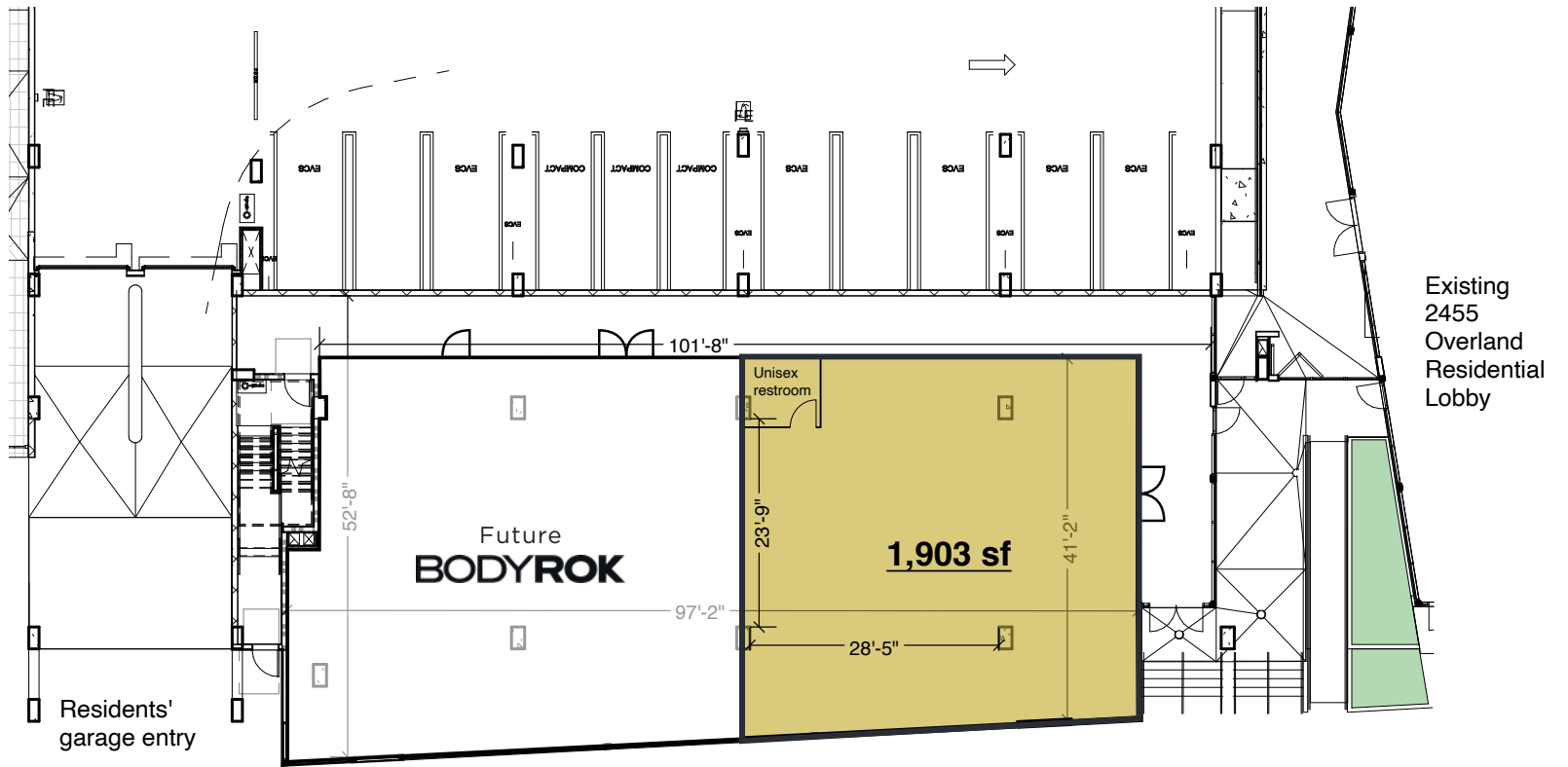

JAY LUCHS
GENNY CHANG
CARLY GELLER

Executive Vice Chairman
Managing Director
Director

310-407-6585
310-407-6588
310-593-0760

jay.luchs@nmrk.com
genny.chang@nmrk.com
carly.geller@nmrk.com

CA RE Lic. #01260345
CA RE Lic. #01467375
CA RE Lic. #02153582

JAYLUCHS.COM
NEWMARK
PACIFIC



Overland & Ayres

The information contained herein has been obtained from sources deemed reliable but has not been verified and no guarantee, warranty or representation, either express or implied, is made with respect to such information. Terms of sale or lease and availability are subject to change or withdrawal without notice.

Corporate RE Lic. #01796698

JAY LUCHS
GENNY CHANG
CARLY GELLER

Executive Vice Chairman
Managing Director
Director

310-407-6585
310-407-6588
310-593-0760

jay.luchs@nmrk.com
genny.chang@nmrk.com
carly.geller@nmrk.com

CA RE Lic. #01260345
CA RE Lic. #01467375
CA RE Lic. #02153582

JAYLUCHS.COM
NEWMARK
PACIFIC