

# 2ND + SENECA SUBLEASE

1191 2nd Ave | Suite 450 | Seattle WA 98101





## Call Brokers for Rates

 4,345 SF

 Open floor plan with 3 private offices and 1 large conference room

 Kitchenette

 Lots of natural light

 On-site bike storage, fitness center & shower facilities

 Expiration date: 1/31/2029



# 2ND + SENECA SUBLEASE

1191 2nd Ave | Suite 450 | Seattle WA 98101

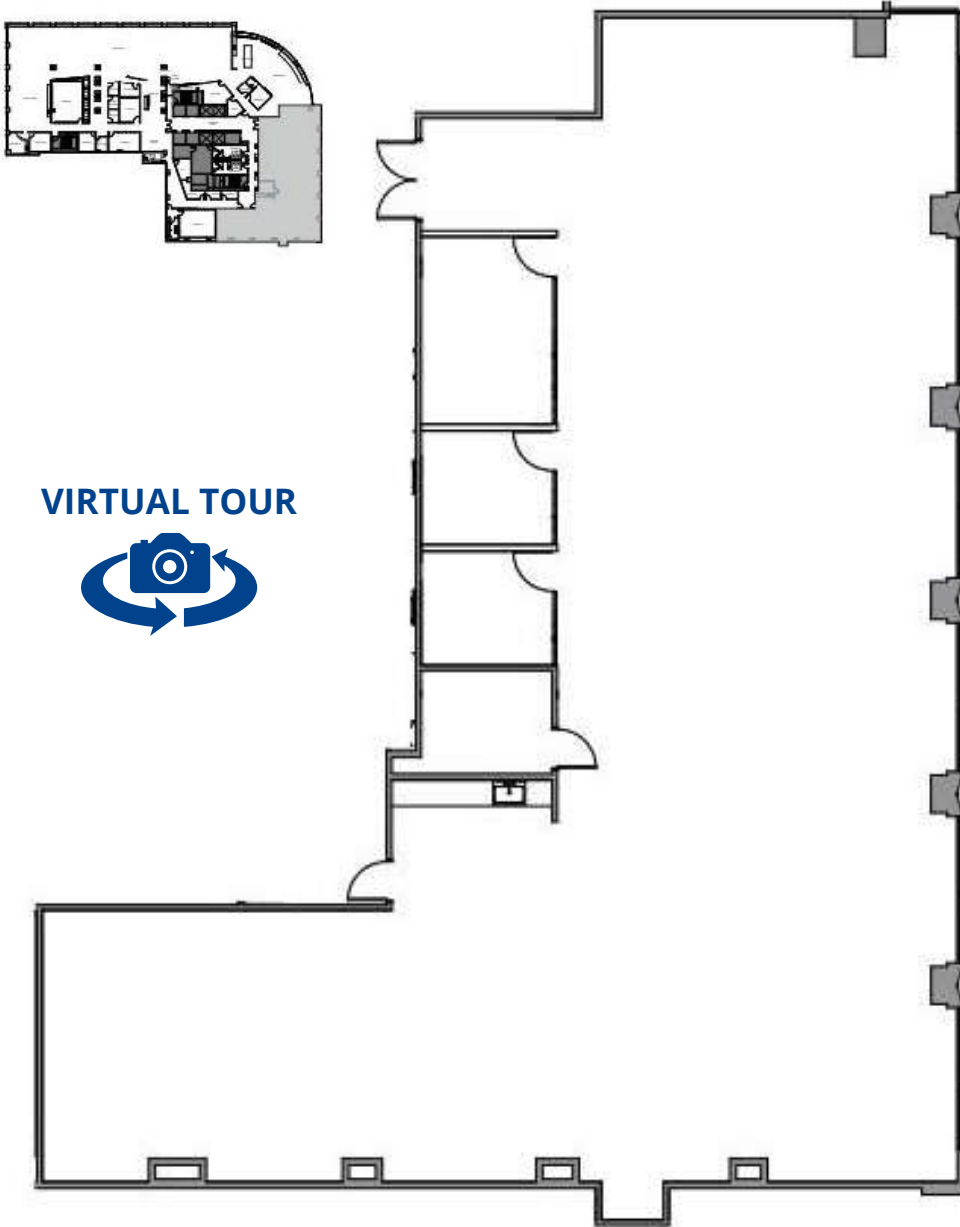

# BE IN THE HEART OF DOWNTOWN SEATTLE

Place your company amongst a wide variety of amenities, including shopping, dining, museums, theaters, and other entertainment and cultural venues. Downtown Seattle's walkable layout and ample options for public transportation provide easy access to activity hubs, the waterfront, and surrounding neighborhoods.



Pike Place Market

Japonessa Sushi

2ND + SENECA

Diller Room

Potbelly

Von's 1000 Spirits

Dough Zone

The Crab Pot

Post Alley Pizza

Donburi House

Red Bows Restaurant

Elliott's Oyster House

All Water Seafood

Homegrown

Skalka

Okinawa Teriyaki

Cafe Hitchcock

Premier Meat Pies

Metropolitan Grill

Ivar's

Owl N' Thistle

**JOE CONNER**

Vice President

+1 425 698 7142

joe.conner@colliers.com

**CONNOR MCCLAIN**

Senior Vice President

+1 206 624 7417

connor.mcclain@colliers.com

**COLLIERS SEATTLE**

601 Union Street, Suite 5300

Seattle, WA 98101

colliers.com

