

FOR SALE/LEASE

RARE 10,850 SF FLEX BUILDING ON 1.1 ACRES



24196 S Barlow Rd
Purchase **\$1,100,000**
Lease **\$9/SF NNN**

Contact

Graham Cole Peterson

Direct: 503.319.4267

GrahamColePeterson@gmail.com

Office: 503.249.1709



Portland Office
Oregon City Office

2105 NE Cesar E Chavez Blvd. Suite 220 Portland, Oregon 97212
502 7th Street Suite 208, Oregon City, OR 97045

FOR SALE/LEASE

- 10,850 SF Total Building
- 1.1 Acre Lot
- Full woodworking/cabinet production facility
- 3,000 SF Insulated Clear Span Metal Shop
- 2,000 SF of Office Heated and Cooled
- Paint room
- Clear Height 10-18'
- Insulated and Heated
- 5 Grade Level Doors
- 240V 200 Amp 3 Phase
- Shared well water and Septic
- Equipment available

-5 minutes to I-5

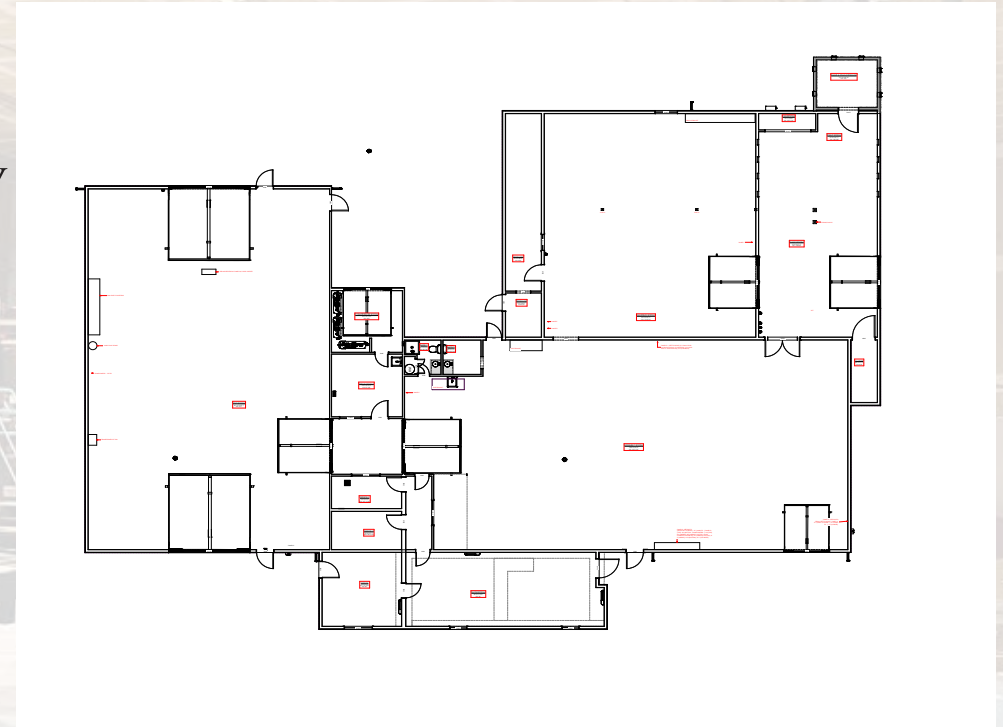

24196 S Barlow Rd, Clackamas County

Contact

Graham Cole Peterson

Direct: 503.319.4267

GrahamColePeterson@gmail.com

Office: 503.249.1709



Portland Office
Oregon City Office

2105 NE Cesar E Chavez Blvd. Suite 220 Portland, Oregon 97212
502 7th Street Suite 208, Oregon City, OR 97045

PHOTOS



Contact

Graham Cole Peterson

Direct: 503.319.4267

GrahamColePeterson@gmail.com

Office: 503.249.1709



Portland Office
Oregon City Office

2105 NE Cesar E Chavez Blvd. Suite 220 Portland, Oregon 97212
502 7th Street Suite 208, Oregon City, OR 97045

LOCATION



WILSONVILLE

SITE

99E

CANBY

Contact

Graham Cole Peterson

Direct: 503.319.4267

GrahamColePeterson@gmail.com

Office: 503.249.1709



Portland Office
Oregon City Office

2105 NE Cesar E Chavez Blvd. Suite 220 Portland, Oregon 97212
502 7th Street Suite 208, Oregon City, OR 97045