



Centrally Located



Office Spaces



Conference Room



Reception



Walk Score



NOW LEASING

RENTAL RATES

\$18/RSF

Full Service (Less Janitorial)

SPACE AVAILABLE

Ste 201: 2,258 RSF

Ste 203: 1,237 RSF

SKYWALK OPPORTUNITY

502 W Riverside, Spokane, WA 99201

THE NUMERICA BUILDING

Beautiful office space in the heart of Downtown, conveniently located on the Skywalk system steps away from shopping and dining. Parking available in the adjacent Parkade.

AMENITIES

- ✓ 5 Private Offices
- ✓ Copy Room
- ✓ Conference Room
- ✓ Huge Windows
- ✓ Breakroom
- ✓ On the Skywalk

***Available October 2026**

Information is deemed reliable but not guaranteed. Broker not responsible for changes errors or commissions. All square footages are for conveniences only. All information should be verified prior to leasing or purchasing property.

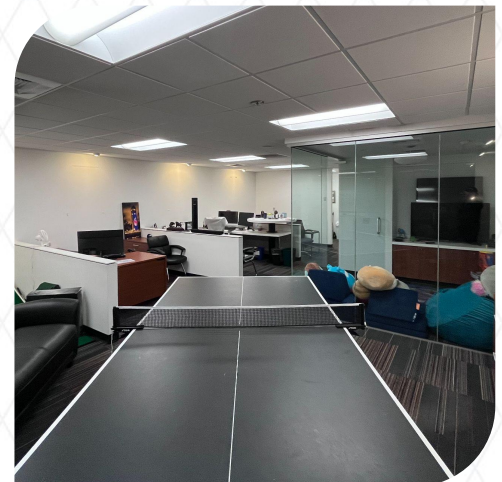

FLOOR PLAN

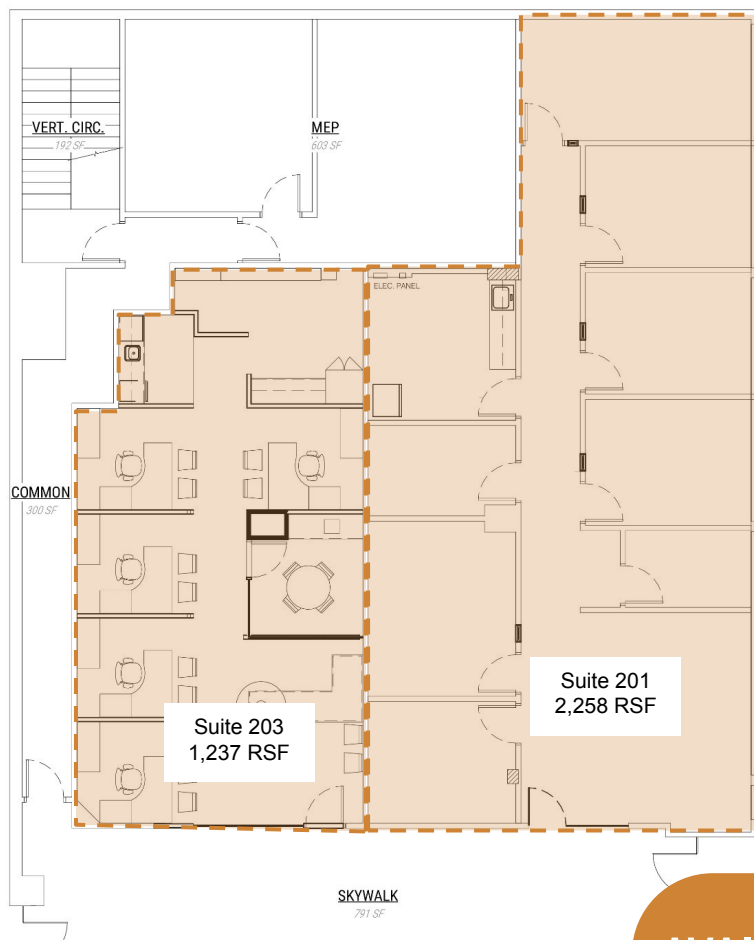

AVAILABLE SPACES

Suite 201

- 2,258 RSF

Suite 203

- 1,237 RSF

Information is deemed reliable but not guaranteed. Broker not responsible for changes errors or commissions. All square footages are for conveniences only. All information should be verified prior to leasing or purchasing property.