

HISTORIC RIVOLI THEATER | 1941 SAN PABLO AVENUE

±18,235 SF GROUND FLOOR RETAIL



maven

NADINE WHISNANT
510.413.7813
nadine@mavenproperties.com
DRE #00966437

PETER MIKACICH
415.288.7815
peter.mikacich@colliers.com
DRE #01133104

Colliers

1941 SAN PABLO AVENUE

LOCATION



SITUATED ON SAN PABLO AVE, ONE OF THE EAST BAY'S MAJOR CORRIDORS. THE SITE IS IN THE HEART OF BERKELEY'S INTERNATIONAL FOOD DISTRICT WHICH IS HOME TO A DIVERSE VARIETY OF LOCAL BUSINESSES, INTERNATIONAL RESTAURANTS, MARKETS, ARTISTS, AND RETAILERS. EASILY ACCESSIBLE FROM I-80 (1/2 MILE) AND APPROXIMATELY 1 MILE FROM DOWNTOWN BERKELEY.

Cal
 ~45K STUDENTS
 ~15K FACULTY & STAFF
 (2022)

Walk Score: **97**
Walker's Paradise

Bike Score: **100**

Transit Score: **62**
Good Transit

1941 SAN PABLO AVENUE

SITE PLAN

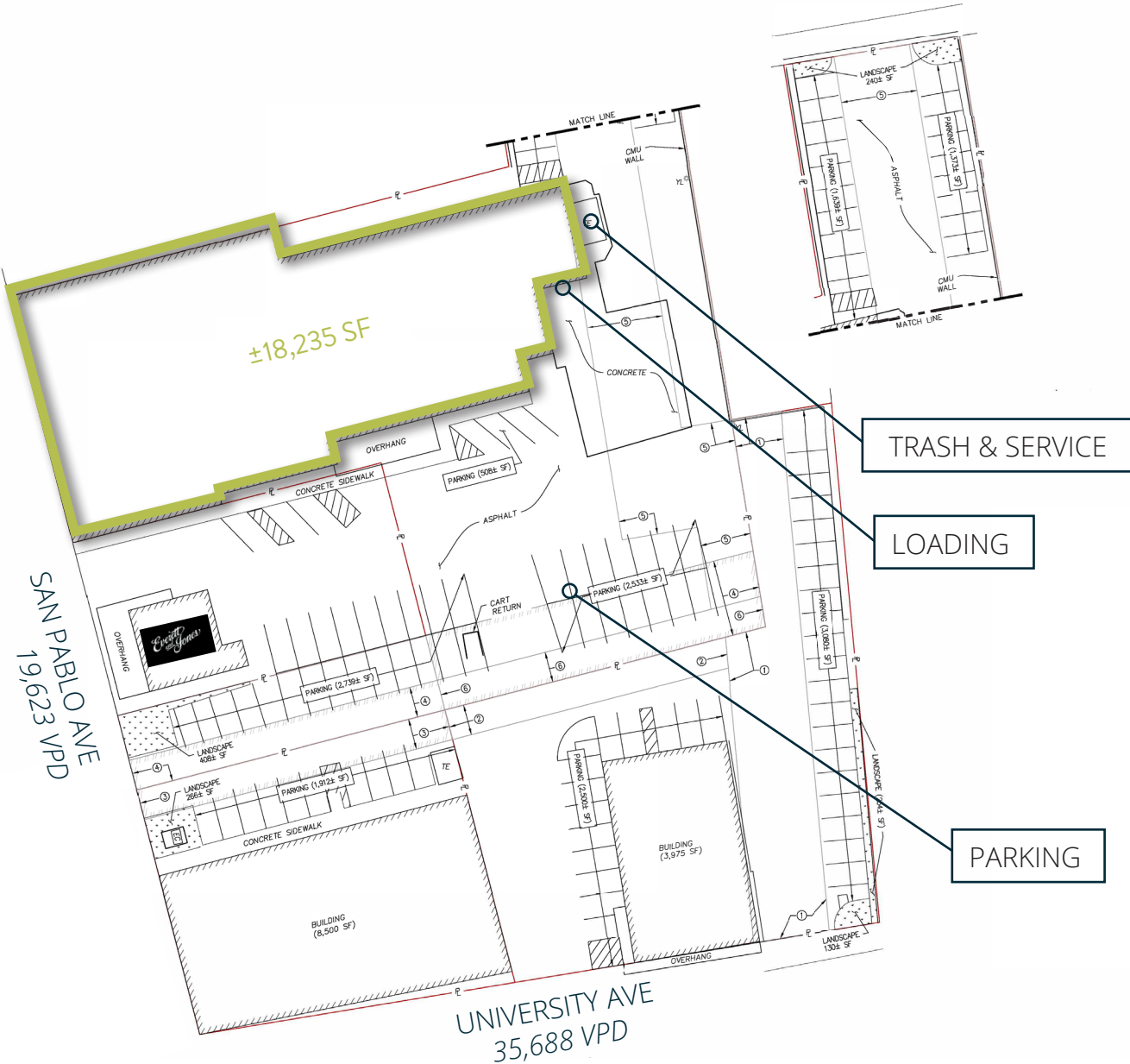

	1 MILE	3 MILE	5 MILE
POPULATION	31,501	208,453	384,248
EMPLOYEES	16,120	120,373	224,805
HOUSEHOLDS	13,380	84,027	161,551
MEDIAN AGE	38	36	38
AVG HH INCOME	\$166,385	\$172,285	\$168,950

- ### BUILDING SPECS
- 1200 AMPS, 120/208V, 3 PHASE POWER
 - 4" WATER MAIN
 - SPRINKLERED (2003/UPDATED 2008)
 - ±100 PARKING SPACES

This document/email has been prepared by Maven & Colliers for advertising and general information only. Maven & Colliers makes no guarantees, representations or warranties of any kind, expressed or implied, regarding the information including, but not limited to, warranties of content, accuracy and reliability. Any interested party should undertake their own inquiries as to the accuracy of the information. Mavens & Colliers excludes unequivocally all inferred or implied terms, conditions and warranties arising out of this document and excludes all liability for loss and damages arising there from. This publication is the copyrighted property of Maven & Colliers and/or its licensor(s). © 2026. All rights reserved. This communication is not intended to cause or induce breach of an existing listing agreement.

1941 SAN PABLO AVENUE

FLOOR PLAN & DETAILS

- APPROXIMATELY $\pm 18,235$ SF ON THE GROUND FLOOR PLUS $\pm 4,000$ SF MEZZANINE WITH UP TO 36 FT CEILING HEIGHT
- RAISED LOADING DOCK IN REAR WITH FREIGHT ELEVATOR
- 3 VEHICULAR ACCESS POINTS - SAN PABLO AVE, UNIVERSITY AVE, & HEARST AVE
- ZONED C-W (WEST BERKELEY COMMERCIAL)

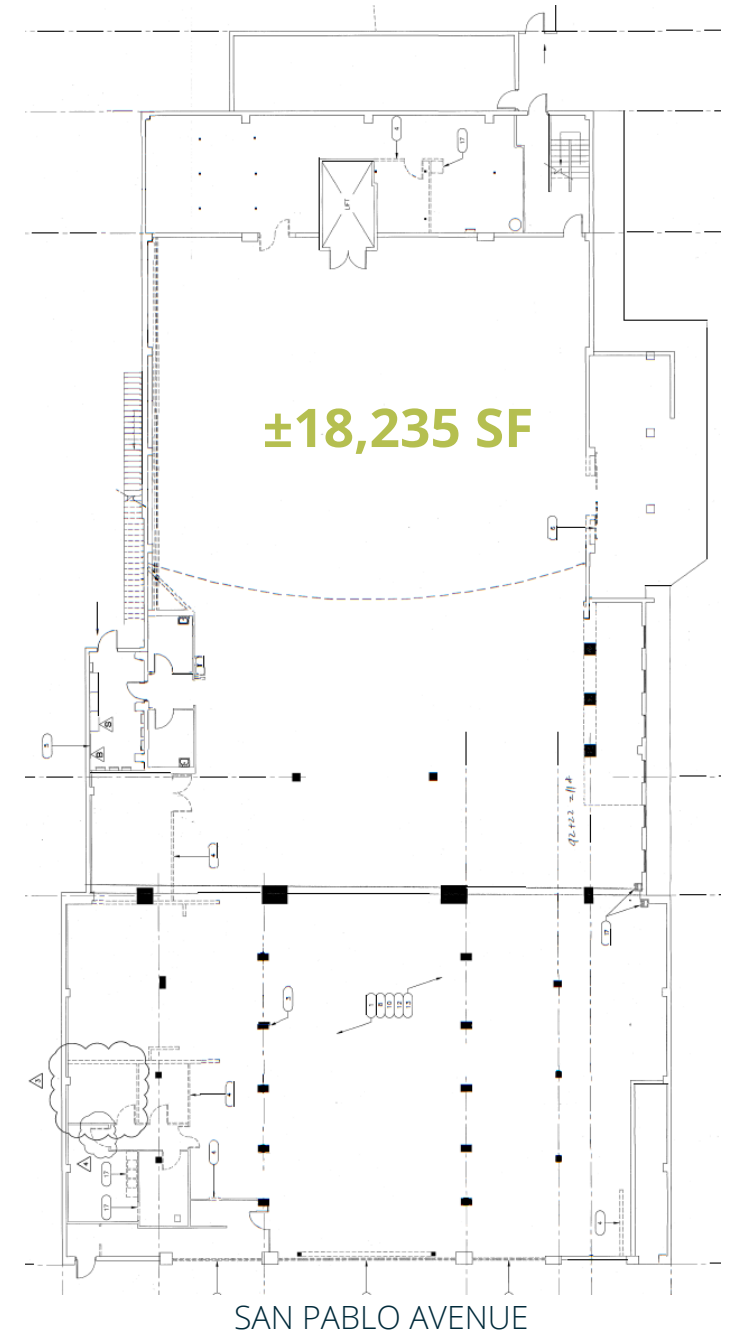



Contact

maven

NADINE WHISNANT

510.214.6412

nadine@mavenproperties.com

DRE #00966437

Colliers

PETER MIKACICH

415.288.7815

peter.mikacich@colliers.com

DRE #01133104

NOTICE: This information has been secured from sources we believe to be reliable but we make no representations, warranties, express or implied, as to the accuracy of the information. Listing broker has been given enough information to provide only a preliminary interest in the property. The materials are not to be considered fact. The information contained herein is not a substitute for thorough due diligence investigation. References to square footage, zoning, use, or age are approximate. Please contact the San Francisco Planning Department to verify zoning at (415) 558-6378, as neither broker or landlord represent that this space is suitable for your use. Tenant or Buyer must verify the information at their own expense and bears all the risk for any inaccuracies. By receiving these materials you are agreeing to the disclaimers set forth herein. DRE#01878802

466 Green Street Suite #203

San Francisco, CA 94133

415-781-770

www.mavenproperties.com