



STAR METALS

ATLANTA

15 story, 267,000 SQ FT Class A+ office





IN A CLASS BY ITSELF

Featuring timeless design created for beauty and function, Star Metals' Class A+ office building showcases upscale features, social and collaborative spaces, start of the art finishes, panoramic views and a cohesive design sensibility that inspires and transforms.





ICONIC ARCHITECTURE

15 story, 267,000 SF
Class A+ office

Varying floor plate sizes
ranging from 18,000 to
36,000 SF

Myriad of floor plan
options, styles, layouts
and build-outs

16'-18' ceilings with floor-
to-ceiling windows

Gorgeous 360 degree
panoramic views of
Buckhead, Midtown &
Downtown

Dramatic double-height
lobby with ground floor
retail, food and beverage,
and entertainment
options



WELCOME
TO THE BEST OF
EVERYTHING



WELLNESS & SUSTAINABILITY

- » LEED Certified sustainable design
- » Energy efficient green roofs and terraces
- » Collaborative common indoor and outdoor spaces
- » Touch free transponder parking garage access
- » WiredScore Platinum Certified technology





H J G F D S A N B E J T S D A M I R D S N J A Z J D S B A J H A D C O B Y M A S U R J X P
H U P Y N O L U I W R L P U R Y I W Y P K H I W T L P R U R T M L P C I N S O Y L R N W F E L P O W S
R F B G V C P P O H D M K R E O S A C R F M G V J C K P H O K R O F M P V R K P J O K C P S





UNPARALLELED AMENITIES

With a deep understanding of the new urban lifestyle and the balance between people and nature, Star Metals' modern conveniences and sustainable design are essential to the offices, residences, hotel rooms, and retail shops of this innovative project.

- » Private outdoor & landscaped tenant terraces on each floor
 - » 10,000 SQ FT tenant amenity terrace
 - » 30-person conference center, board room & lounge
 - » 9,000 SQ FT rooftop restaurant & bar terrace with panoramic views
 - » Fully-equipped fitness center, locker rooms & shower facilities
 - » Secured bike storage
 - » Star Metals exclusive Marta shuttle
 - » Electric car charging stations
 - » 24/7 high-tech security (front desk, surveillance cameras and card-key access only)
- » On-Site Restaurants & Retail
 - Wagamama
 - Planthouse
 - Flight Club
 - Prevail Coffee
 - Sweetgreen
 - Savi Provisions

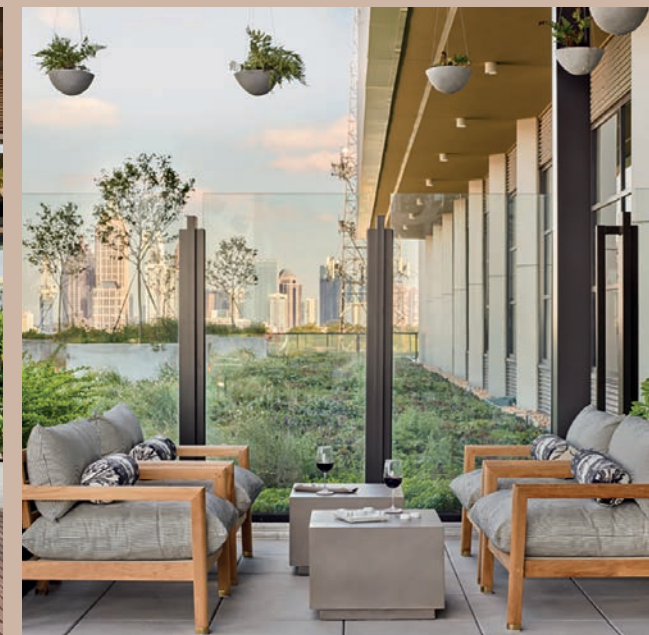

LOCATION

Activated on-site retail, entertainment & restaurants + over 55 shopping and dining option within a 5 minute walk!

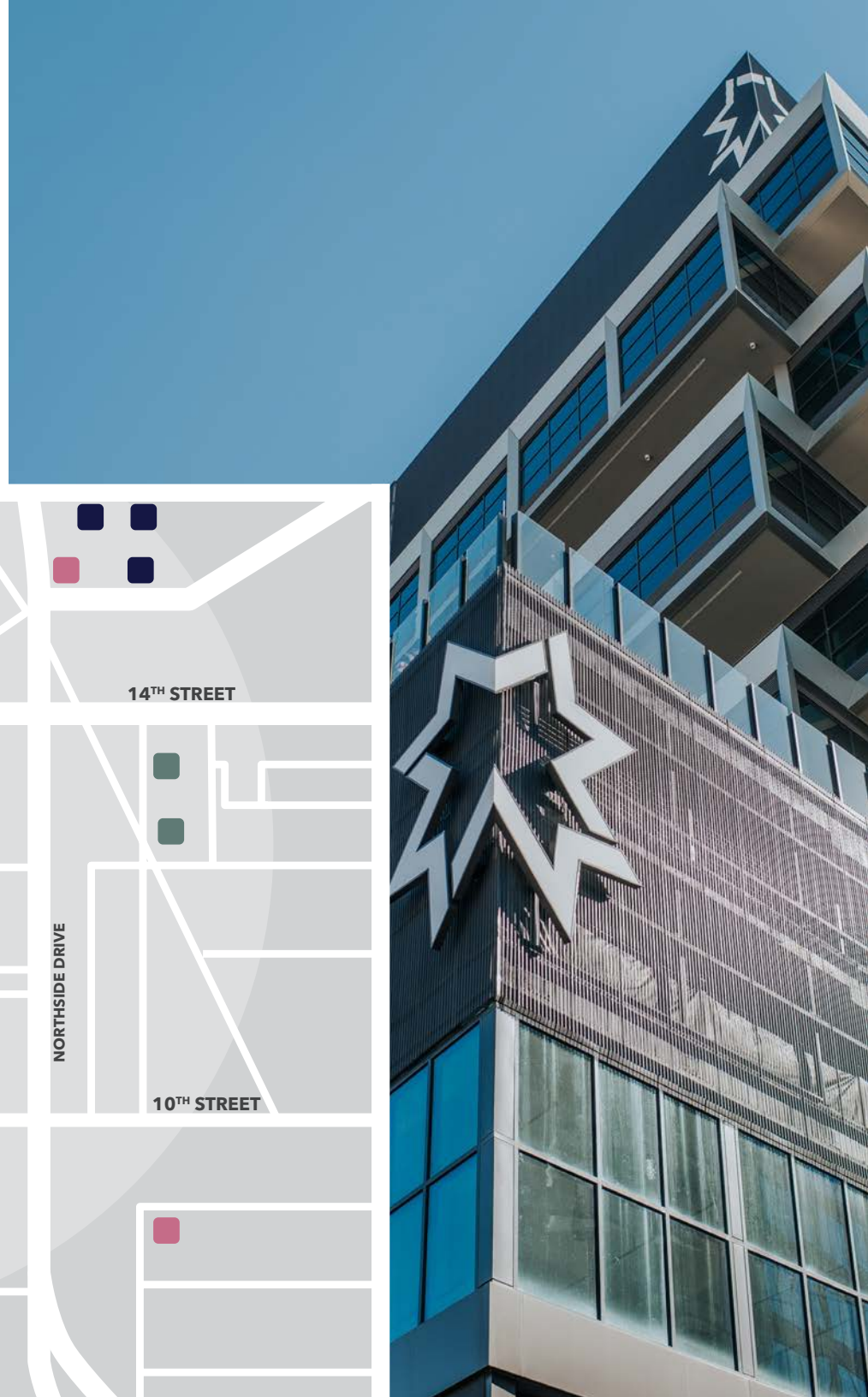
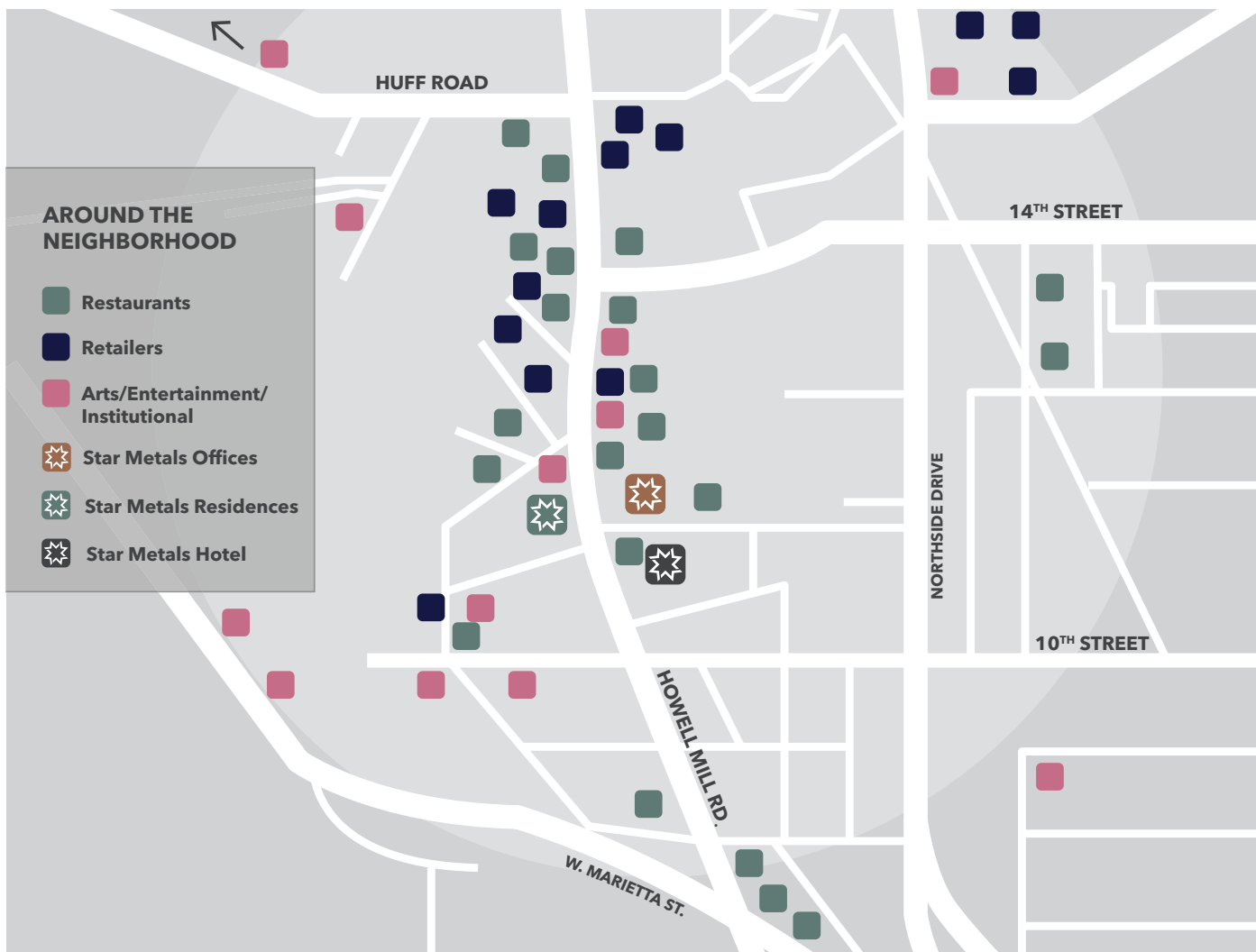



FOR LEASING INFORMATION, CONTACT:

Jeff Bellamy
404 995 2221
jeff.bellamy@jll.com

Brooke Dewey
+1 404 995.2138
brooke.dewey@jll.com

REINVENTING
ATLANTA'S
WORKPLACE



ALLEN MORRIS COMPANY

www.StarMetalsAtlanta.com

Although information has been obtained from sources deemed reliable, neither Owner nor JLL makes any guarantees, warranties or representations, express or implied, as to the completeness or accuracy as to the information contained herein. Any projections, opinions, assumptions or estimates used are for example only. There may be differences between projected and actual results, and those differences may be material. The Property may be withdrawn without notice. Neither Owner nor JLL accepts any liability for any loss or damage suffered by any party resulting from reliance on this information. If the recipient of this information has signed a confidentiality agreement regarding this matter, this information is subject to the terms of that agreement. ©2023. Jones Lang LaSalle IP, Inc. All rights reserved.