

OFFERING MEMORANDUM



368 CENTRAL AVENUE

-3931

368

360

Cellular
WE SELL PHONES



LOCATED IN BUSHWICK
7-UNIT MIXED-USE WALK-UP



This is a confidential document intended solely for your limited use and benefit in determining whether you desire to express any interest in the proposed sale of the real property (the Property) disclosed herein. This document contains selected information pertaining to the Property and does not purport to be all-inclusive or to contain all of the information that a prospective purchaser, investor, mortgagee, lender or lessee may desire. Neither Owner, Cushman & Wakefield Realty of Manhattan, LLC nor any of their respective partners, officers, directors, agents, brokers or employees have made any representation or warranty, expressed or implied, as to the accuracy or completeness of this document or any of its contents, and no legal commitments or obligations shall arise by reason of this document or any of its contents.

CONTACTS

SALES CONTACTS

Nick Kolbus

+1 718 275 5472

nick.kolbus@cushwake.com

Dylan Walsh

+171 8307 6517

dylan.walsh@cushwake.com

Jonathan Squires

+1 212 660 7775

jonathan.squires@cushwake.com

Dimitri Venekas

+1 212 709 0778

dimitri.venekas@cushwake.com

Kieran Baker

+1 516 974 6694

kieran.baker@cushwake.com

Cushman & Wakfield is pleased to offer exclusively to market 368 Central Avenue, in Bushwick, Brooklyn. With 4,875 SF of built space, the mixed-use building with be delivered with all 5 residential units VACANT at closing. The property consists of five (5) apartments, four two (2) bedroom one (1) bath units and one studio unit.

Both retail spaces are on month-to-month leases (occupied by a salon and barber shop) and can be delivered vacant for an end-user or pocket tenant. The property benefits from protected tax class 2B status and is zoned R6, allowing for 5,500 buildable square feet as-of-right, and 9,750 with the UAP bonus

HIGHLIGHTS

- All 5 apartments vacant at close
- Retail on MTM leases (option to be delivered with signed leases)
- Subway access at Knickerbocker Ave (M) and Halsey Street (J) and Myrtle-Wyckoff (M, L) trains
- Protected Tax Class 2B
- Low annual taxes of \$10,147
- Gas boiler

TAX MAP

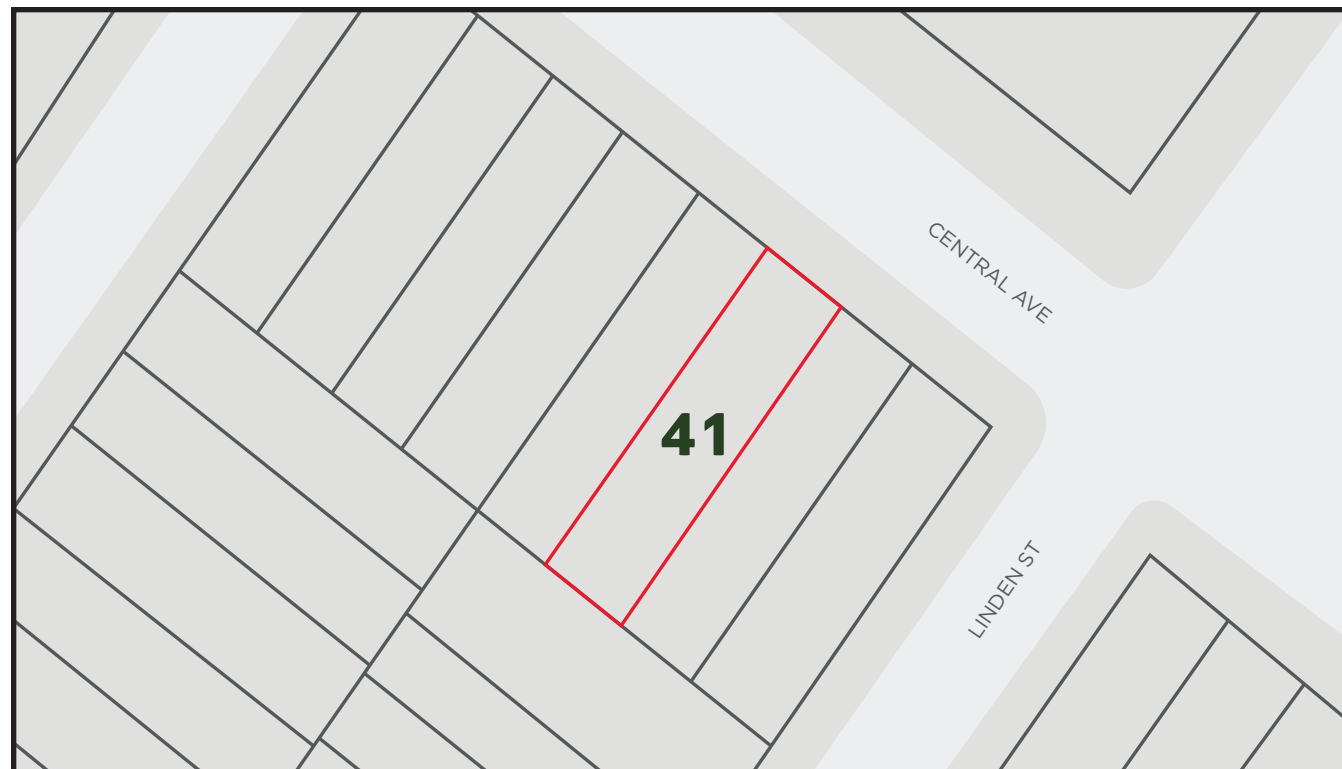

368 CENTRAL AVENUE



ASKING PRICE:
\$2,100,000

FINANCIAL SUMMARY

Price Per Square Foot:	\$410
Price Per Unit:	\$300,000
Projected Yield on Cost:	7.37%

Property Information		
Address:	368 Central Avenue, Bushwick, Brooklyn 11221	
Description:	Walk-up building	
Block & Lot:	3323 - 41	
Lot Dimensions:	25' x 100'	
Lot SF:	2,500	SF (approx.)
Building Information		
Property Type:	Walkup	
Building Dimensions:	25' x 65'	Irregular
Stories:	3	
Year Built / Last Altered:	1931	
Above Grade Gross SF:	4,875	SF (approx.)
Below Grade Gross SF:		SF (approx.)
Total Gross SF:	4,875	SF (approx.)
Residential Units:	5	
Commercial Units:	2	
Total Units:	7	
Gross Residential SF:	3,650	SF (approx.)
Net Residential SF:	3,103	SF (approx.) 15% loss factor
Avg. Net Unit SF:	621	SF (approx.)
Above Grade Commercial SF:	1,225	SF (approx.)
Zoning Information		
Zoning:	R6	
FAR (As-of-Right):	2.43	
Community Facility FAR:	4.80	
Total Buildable SF (As-of-Right):	6,075	SF (approx.)
Less Existing Structure:	4,875	SF (approx.)
Available Air Rights (As-of-Right):	1,200	SF (approx.)
NYC Financial Information (26/27)		
Total Assessment:	\$82,718	
Annual Property Tax:	\$10,147	
Tax Class:	2B	
Tax Rate:	12.2670%	

368 CENTRAL AVENUE

RESIDENTIAL REVENUE

Unit	Beds	Baths	SF	Lease Exp.	Pro Forma	\$ / SF
1B	Studio	1	500	Vacant	\$2,200	\$53
2L	2	1	650	MTM	\$3,250	\$60
2R	2	1	650	Vacant	\$3,250	\$60
3L	2	1	650	Vacant	\$3,250	\$60
3R	2	1	650	Vacant	\$3,250	\$60
Residential Monthly			3,100		\$15,200	\$59
Residential Annual					\$182,400	\$59
Residential Averages			620		\$3,040	\$59

COMMERCIAL REVENUE

Unit	Tenant	SF	Lease Exp.	Monthly	\$ / SF	Pro Forma	\$ / SF
Retail 1		700	MTM	\$2,100	\$36	\$3,000	\$51
Retail 2		550	MTM	\$1,850	\$40	\$2,500	\$55
Commercial Monthly				1,250	\$3,950	\$38	\$5,500
Commercial Annual					\$47,400	\$38	\$66,000
Commercial Averages				700	\$1,975	\$38	\$2,750

Total Revenue **\$248,400 \$50.95**

Cushman & Wakefield

PROFORMA

RESIDENTIAL REVENUE	NSF	\$ / Unit / Mo.	\$ / SF	Annual Income
Gross Annual Income	3,103	\$0	\$58.79	\$182,400
Other Charges		\$0	0	\$0
Less General Vacancy/Credit Loss (3.0%)		\$0	(\$1.76)	(\$5,472)
Effective Gross Annual Income		\$0	\$57.03	\$176,928

COMMERCIAL REVENUE	NSF	\$ / Unit / Mo.	\$ / SF	Annual Income
Gross Annual Income	1,225	\$1,975	\$53.88	\$66,000
Expense Recovery & Tax Reimbursement		\$0	\$0.00	\$0
Less General Vacancy (5.0%)		(\$99)	\$2.69	(\$3,300)
Effective Gross Annual Income		\$1,876	\$51.18	\$62,700

TOTAL REVENUE	Annual Income
Effective Gross Annual Income	\$55.37 \$239,628

EXPENSES

Type	Projection	% of EGI	\$ / Unit	\$ / SF	Total
Property Taxes	Actual	4.2%	\$1,450	\$2.08	\$10,147
Water and Sewer	\$1,200/ Resi. Unit	2.5%	\$857	\$1.23	\$6,000
Insurance	\$1,200/ Resi. Unit	2.5%	\$857	\$1.23	\$6,000
Fuel	Tenants pay	0.0%	\$0	\$0.00	\$0
Electric (Common Areas)	\$0.30/ GSF	0.6%	\$209	\$0.30	\$1,463
Repairs & Maintenance	\$550/ Resi. Unit	1.1%	\$393	\$0.56	\$2,750
General & Administrative	\$250/ Resi. Unit	0.5%	\$179	\$0.26	\$1,250
Super Salary	\$250/ Month	1.3%	\$429	\$0.62	\$3,000
Management Fee	3.0% / EGI	3.0%	\$193	\$1.47	\$7,189
Total Expenses		15.8%	\$4,566	\$7.75	\$37,798
Net Operating Income					\$201,830

368 CENTRAL AVENUE



Cushman & Wakefield





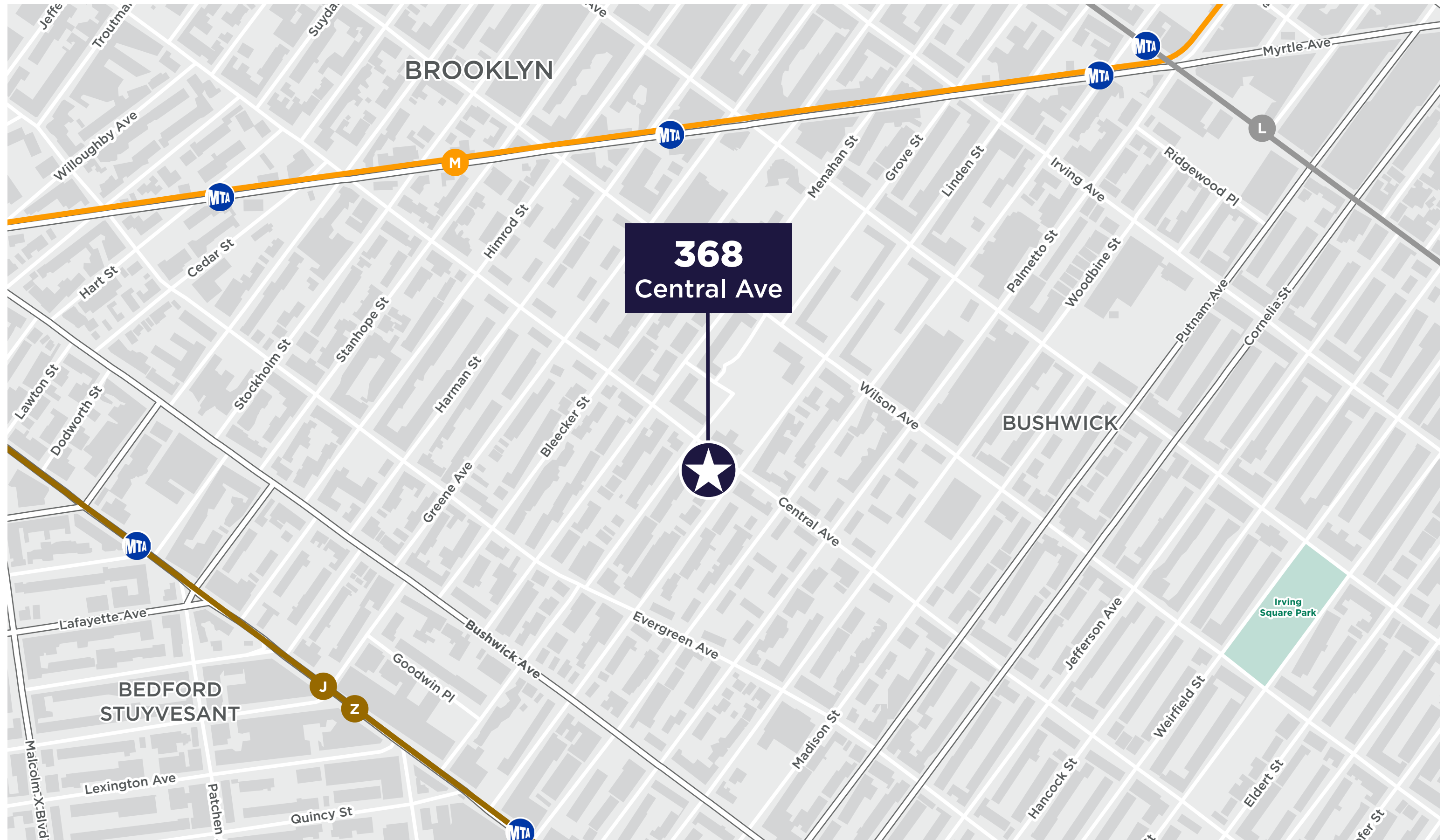

368
Central Ave



368 CENTRAL AVENUE

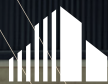

**CUSHMAN &
WAKEFIELD**

SALES CONTACTS

Nick Kolbus

+1 718 275 5472

nick.kolbus@cushwake.com

Dylan Walsh

+171 8307 6517

dylan.walsh@cushwake.com

Jonathan Squires

+1 212 660 7775

jonathan.squires@cushwake.com

Dimitri Venekas

+1 212 709 0778

dimitri.venekas@cushwake.com

Kieran Baker

+1 516 974 6694

kieran.baker@cushwake.com

©2026 Cushman & Wakefield. All rights reserved. The information contained in this communication is strictly confidential. This information has been obtained from sources believed to be reliable but has not been verified. NO WARRANTY OR REPRESENTATION, EXPRESS OR IMPLIED, IS MADE AS TO THE CONDITION OF THE PROPERTY (OR PROPERTIES) REFERENCED HEREIN OR AS TO THE ACCURACY OR COMPLETENESS OF THE INFORMATION CONTAINED HEREIN, AND SAME IS SUBMITTED SUBJECT TO ERRORS, OMISSIONS, CHANGE OF PRICE, RENTAL OR OTHER CONDITIONS, WITHDRAWAL WITHOUT NOTICE, AND TO ANY SPECIAL LISTING CONDITIONS IMPOSED BY THE PROPERTY OWNER(S). ANY PROJECTIONS, OPINIONS OR ESTIMATES ARE SUBJECT TO UNCERTAINTY AND DO NOT SIGNIFY CURRENT OR FUTURE PROPERTY PERFORMANCE. PD-197760-V3