

ANNANDALE PLAZA

Columbia Pike/John Marr Drive, Annandale, VA 22003
Fairfax County



OFFICE/RETAIL FOR LEASE

NEARBY AMENITIES:



Domino's

PROPERTY HIGHLIGHTS:

- Small office and retail suite options in the heart of Annandale
- Flexible lease terms at a great value
- Surrounded by amenities
- At the corner of Columbia Pike and John Marr Drive, just off Little River Turnpike

AVAILABILITY:

OFFICE:

Suite 231: 612 SF

Suite 228: 557 SF

Suite 236: 1,011 SF

Rate: \$21.00 Full Service

RETAIL:

4115 John Marr Dr: 1,500 SF

November 1st availability

Rate: \$34.00 NNN

Marc Tasker, CCIM, SIOR
mtasker@klnb.com
703-268-2735

Keenan Woofter
kwoofter@klnb.com
703-268-2744

8065 Leesburg Pike, Suite 700
Tysons, VA 22182
klnb.com



ANNANDALE PLAZA

Columbia Pike/John Marr Drive, Annandale, VA 22003
Fairfax County

OFFICE SUITES
557-1,011 SF

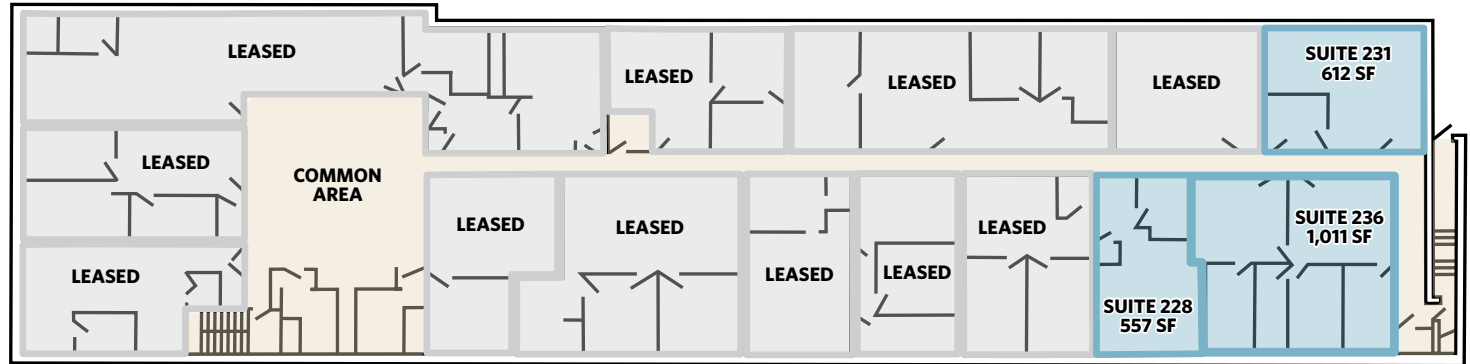

RETAIL SUITE
1,500 SF

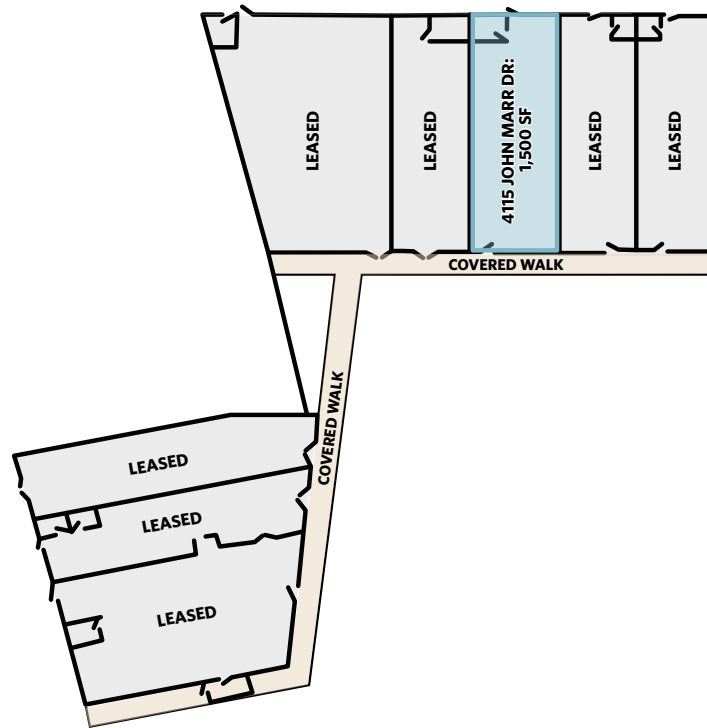

FLOOR PLAN

Marc Tasker, CCIM, SIOR
mtasker@klnb.com
703-268-2735

Keenan Woofter
kwoofter@klnb.com
703-268-2744

8065 Leesburg Pike, Suite 700
Tysons, VA 22182
klnb.com

NAI klnb

ANNANDALE PLAZA

Columbia Pike/John Marr Drive, Annandale, VA 22003
Fairfax County

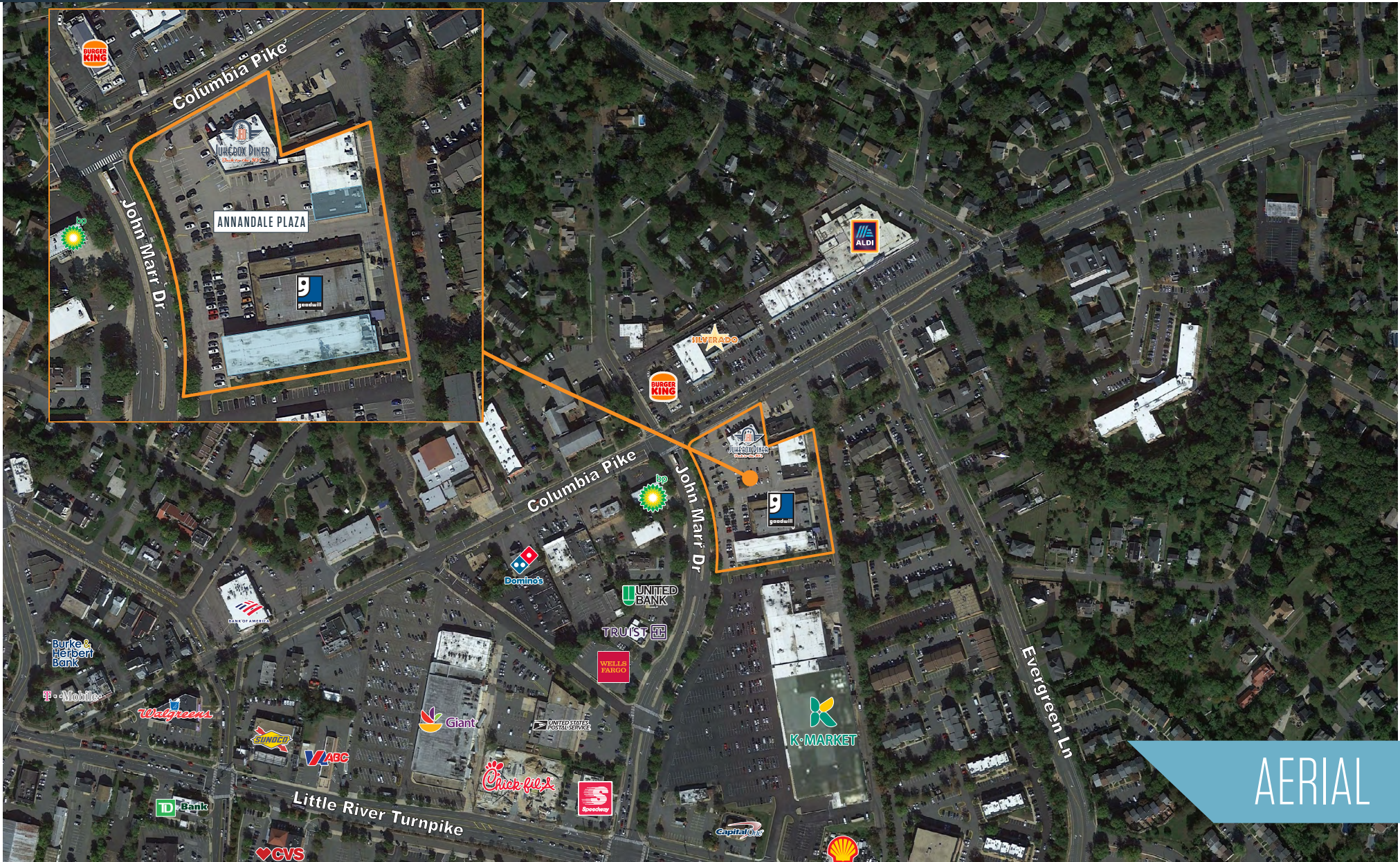

AERIAL

Marc Tasker, CCIM, SIOR
mtasker@klnb.com
703-268-2735

Keenan Woofter
kwoofter@klnb.com
703-268-2744

8065 Leesburg Pike, Suite 700
Tysons, VA 22182
klnb.com

NAI klnb

ANNANDALE PLAZA

Columbia Pike/John Marr Drive, Annandale, VA 22003
Fairfax County

[CLICK TO VIEW PROPERTY WEBSITE](#)

For More Information, Please Contact:

Marc Tasker, CCIM, SIOR

mtasker@klnb.com

703-268-2735

Keenan Woofter

kwoofter@klnb.com

703-268-2744

8065 Leesburg Pike, Suite 700
Tysons, VA 22182

klnb.com



[instagram.com/klnbcre](https://www.instagram.com/klnbcre)



[linkedin.com/company/klnb](https://www.linkedin.com/company/klnb)



[facebook.com/KLNBCRE](https://www.facebook.com/KLNBCRE)

While we have no reason to doubt the accuracy of any of the information supplied, we cannot, and do not, guarantee its accuracy. All information should be independently verified prior to a purchase or lease of the property. We are not responsible for errors, omissions, misuse, or misinterpretation of information contained herein and make no warranty of any kind, express or implied, with respect to the property or any other matters.

NAI klnb