

BLACK DIAMOND TOWN CENTER

W Norvell Bryant Hwy & N Lecanto Hwy | Lecanto, FL 34461

FOR LEASE

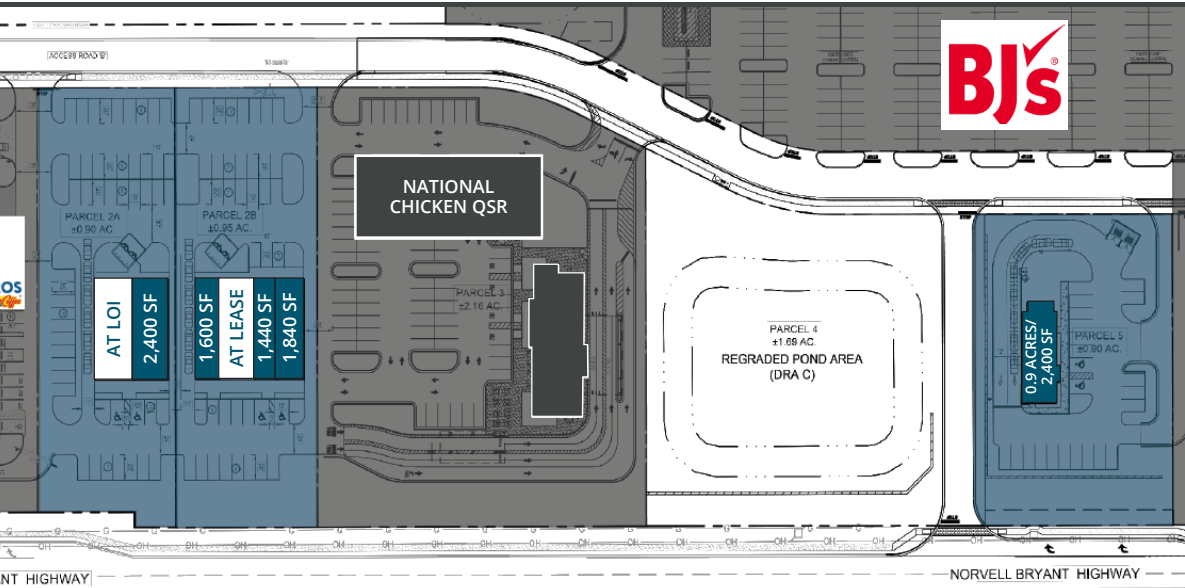

PROPERTY OVERVIEW

- » Site anchored by BJ's Wholesale Club and Dutch Bros, creating a strong daily traffic draw
- » Traffic signal being installed on west side of project
- » Located directly adjacent to other big-box retailer and restaurant sites in market
- » Multiple full access points with a dedicated left-turn lane, ensuring smoother ingress/egress and customer convenience
- » Ideal for national and regional tenants seeking a presence in an expanding Central Florida corridor with limited new retail competition

DEMOGRAPHICS

	3 Mile	5 Mile	Citrus County
Population	21,667	47,340	164,302
Households	9,343	20,818	77,191
Avg. HH Income	\$90,271	\$85,060	\$77,595

TRAFFIC COUNTS AADT

W Norvell Bryant Hwy	19,140 AADT
N Lecanto Hwy	26,338 AADT



FranklinStreet

LICENSED REAL ESTATE BROKER
BROKER OF RECORD: DARRON KATTAN, #BK3256503
DARRON.KATTAN@FRANKLINST.COM

ALEX WRIGHT
MANAGING DIRECTOR

813.682.6135
Alex.Wright@FranklinSt.com

BRONWYN EYEINGTON
ASSOCIATE DIRECTOR

813.577.3830
Bronwyn.Eyeington@FranklinSt.com

BLACK DIAMOND TOWN CENTER | W Norvell Bryant Hwy & N Lecanto Hwy

FLOOR PLAN

	ACRE/SF	AVAILABLE
Space 2.1	2,500 SF	AT LOI
Space 2.2	2,400 SF	AVAILABLE
Space 2.3	1,600 SF	AVAILABLE
Space 2.4	2,400 SF	AT LEASE
Space 2.5	1,440 SF	AVAILABLE
Space 2.6	1,840 SF	AVAILABLE
Parcel 5	0.9 AC/2,400 SF	AVAILABLE

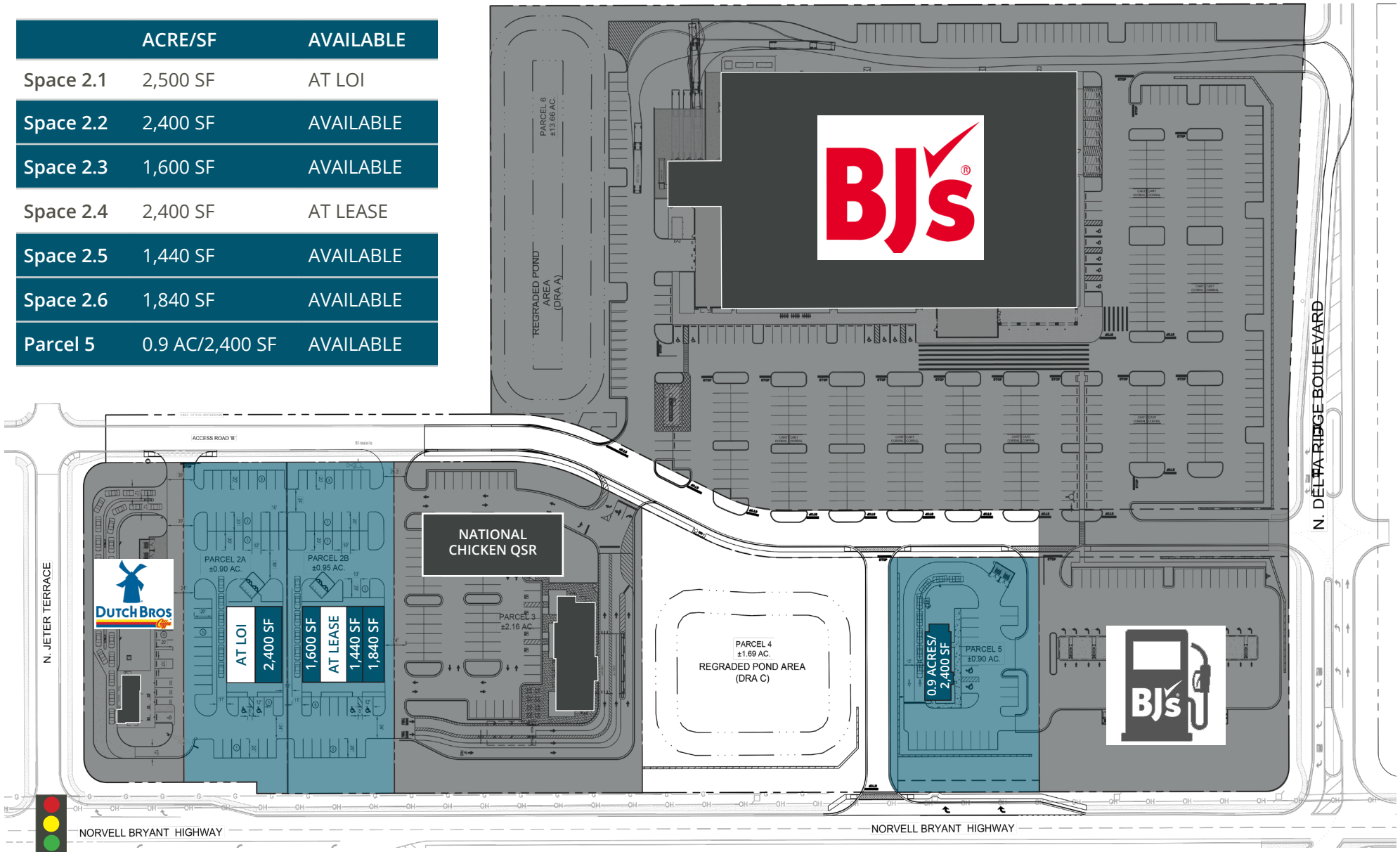



BLACK DIAMOND TOWN CENTER | W Norvell Bryant Hwy & N Lecanto Hwy

MARKET AERIAL



BLACK DIAMOND TOWN CENTER | W Norvell Bryant Hwy & N Lecanto Hwy

MARKET AERIAL

