

FOR LEASE

Sawyer Park Industrial Spaces

63025 OB Riley Rd, Bend, OR 97701

1,350 SF | \$1.10/SF/MO. NNN



HIGHLIGHTS

- Concrete tilt-up building
- Great access to Highway 97, Bend Parkway and Highway 20
- Abundant onsite parking
- Convenient access to the River Trail and Sawyer Park
- Zoned Mixed Employment (ME)

Luke Ross, Broker | Graham Dent, SIOR

600 SW Columbia St., Ste. 6100 | Bend, OR 97702

541.383.2444 | www.CompassCommercial.com

COMPASS
COMMERCIAL

**REAL
ESTATE
SERVICES**

FOR LEASE

Sawyer Park Industrial Spaces

63025 OB Riley Rd, Bend, OR 97701

1,350 SF | \$1.10/SF/MO. NNN

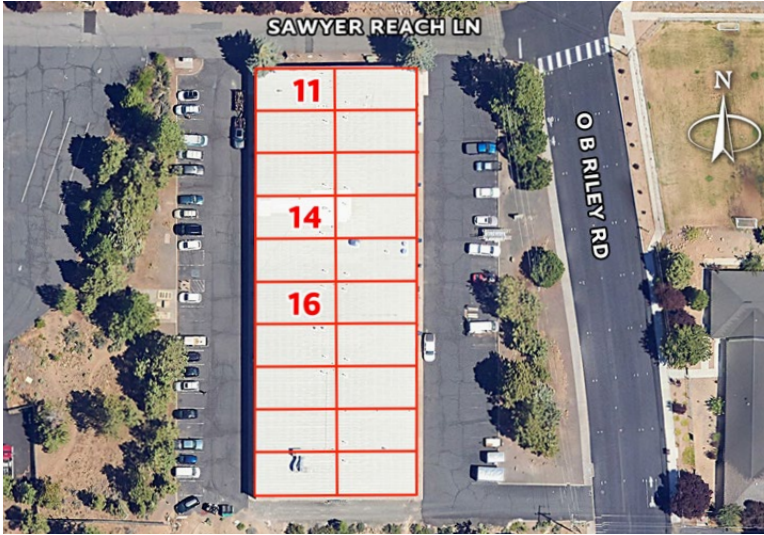

PROPERTY DETAILS

| | |
|-------------|-----------------------|
| Unit 11: | 1,350 SF |
| Unit 14: | 1,350 SF |
| Unit 16: | 1,350 SF |
| Lease Rate: | \$1.10/SF/Mo. NNN |
| NNNs: | Est. at \$0.27/SF/Mo. |
| Available: | Now |



Brokers are licensed in the state of Oregon. This information has been furnished from sources we deem reliable, but for which we assume no liability. This is an exclusive listing. The information contained herein is given in confidence with the understanding that all negotiations pertaining to this property be handled through Compass Commercial Real Estate Services. All measurements are approximate.



Luke Ross
Broker
Cell 541.480.6144
lross@compasscommercial.com



Graham Dent, SIOR
Partner, Broker
Cell 541.639.6515
gdent@compasscommercial.com

COMPASS
COMMERCIAL

REAL ESTATE
SERVICES