

Tenant Plan * Scale: 1/8" = 1'-0"

- ① 9080 STOREFRONT GLASS
- ② 3080 STOREFRONT GLASS
- Ⓐ 3068 STEEL WALK DOOR
- Ⓑ 3070 STOREFRONT DOOR WITH (2) 3070 FIXED GLASS UNITS
- Ⓒ 9080 SGD COMMERCIAL GRADE
- Ⓓ 10 x 10 OHD
- Ⓔ 3070 STOREFRONT GLASS WITH (1) 3070 FIXED GLASS UNIT
- Ⓕ 10 x 14 OHD
- Ⓖ 3068 INTERIOR DOOR

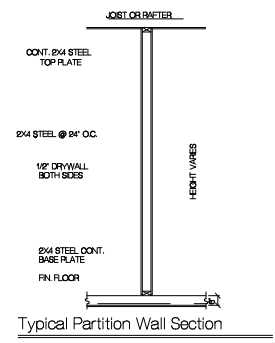
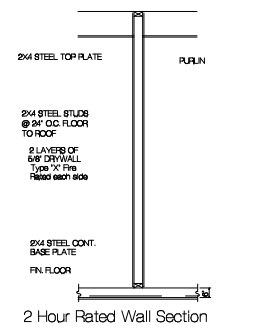

REV. 06/09/99 SCALE AS NOTED DATE 06/26/99 REV. 06/31/99	FACE #	WORKTOOLS UNIT 230 12397 Belcher Road Largo, Florida Proposed Floor Plan	MOSK DEVELOPMENT 7100-123rd Cir. N., #650 Largo, Florida 33773 (813) 539-7587
<h1 style="margin: 0;">SINCLAIR CONSTRUCTION</h1> <p style="margin: 0;">GENERAL CONTRACTOR CGC016941 (727)397-9218 7111 GREENBRIER DRIVE SEMINOLE, FL 33777</p>			

SCOTT T. CRAMER AND ASSOCIATES
 CONSULTING ENGINEERS
 1101 PINELLAS BAYWAY #203
 TERRA VERDE, FLORIDA 33716
 (727) 866-8706