



# For Sale or Lease

## 777 Bible Rd, Lima, OH

---

777 Bible Rd

- 548,750 SF Industrial/Manufacturing Building
- Located in Lima, OH
- Contact brokers for pricing details



# PROPERTY OVERVIEW

The building is a 548,750 SF industrial/manufacturing facility conveniently located within proximity to I-75 in the City of Lima, Ohio.

PROPERTY SUMMARY	
TOTAL BUILDING AREA	548,750 SF
OFFICE SF	14,000 SF
YEAR BUILT	1962
POWER	34.5 kV current line supply; new Siemens switchgear installed in 2019
GRADE LEVEL DOORS	3
DOCK DOORS	23
CEILING HEIGHT	18'7" - 20'9"
FLOOR THICKNESS	6" - 8" throughout most of the building
OCCUPANCY	Available immediately
PRICING DETAILS	Contact Brokers for Details

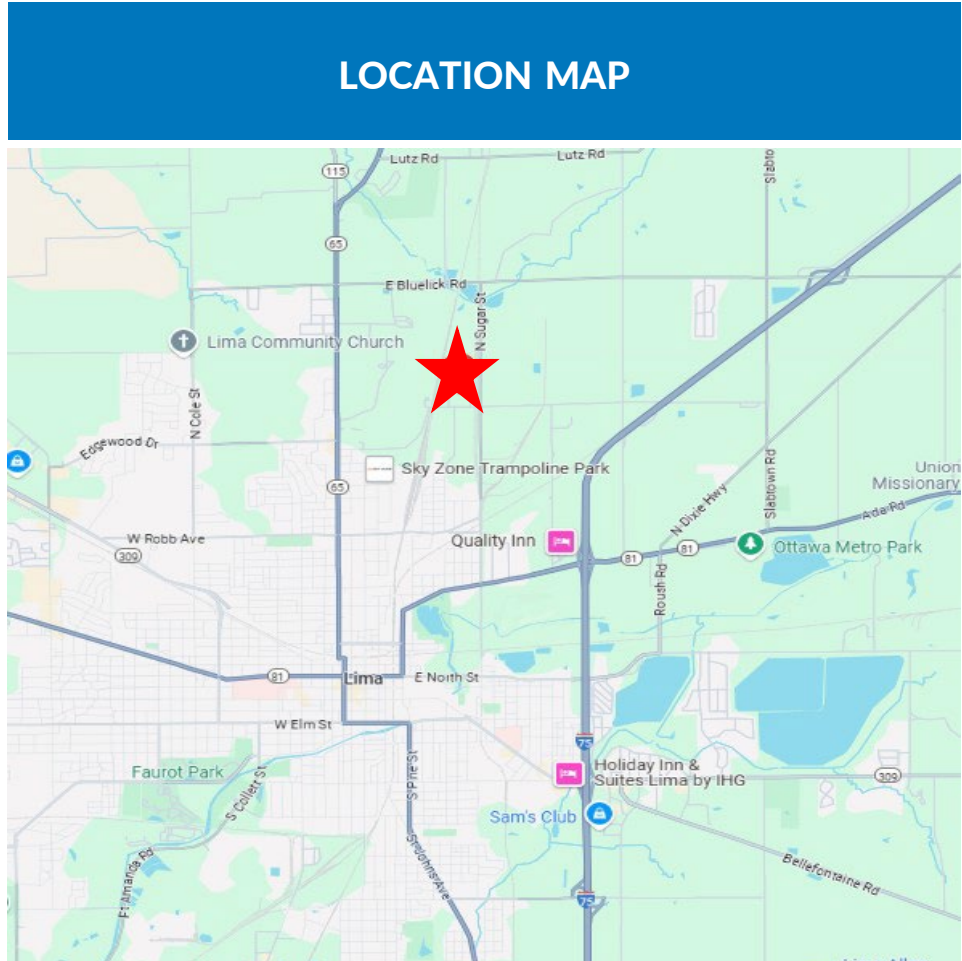

# PROPERTY PHOTOS



# PROPERTY PHOTOS

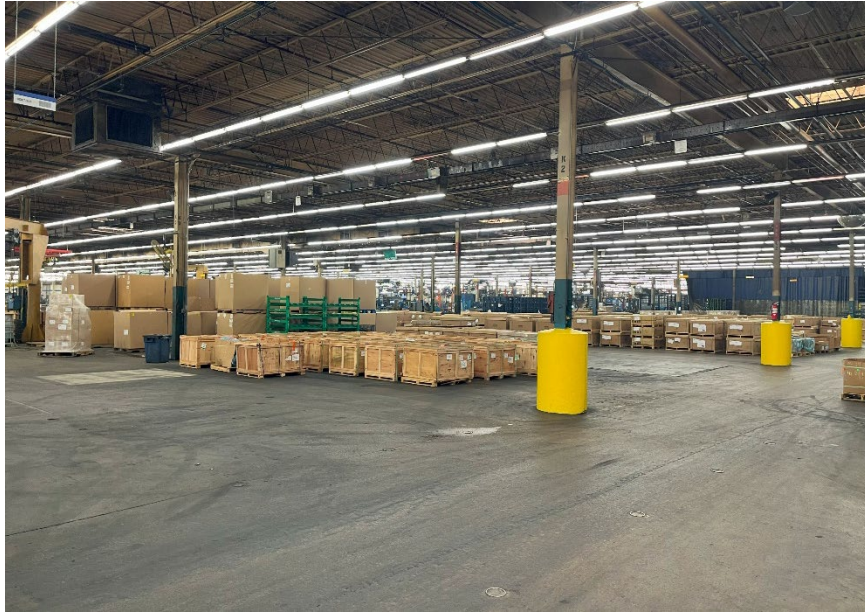

# FLOOR PLAN

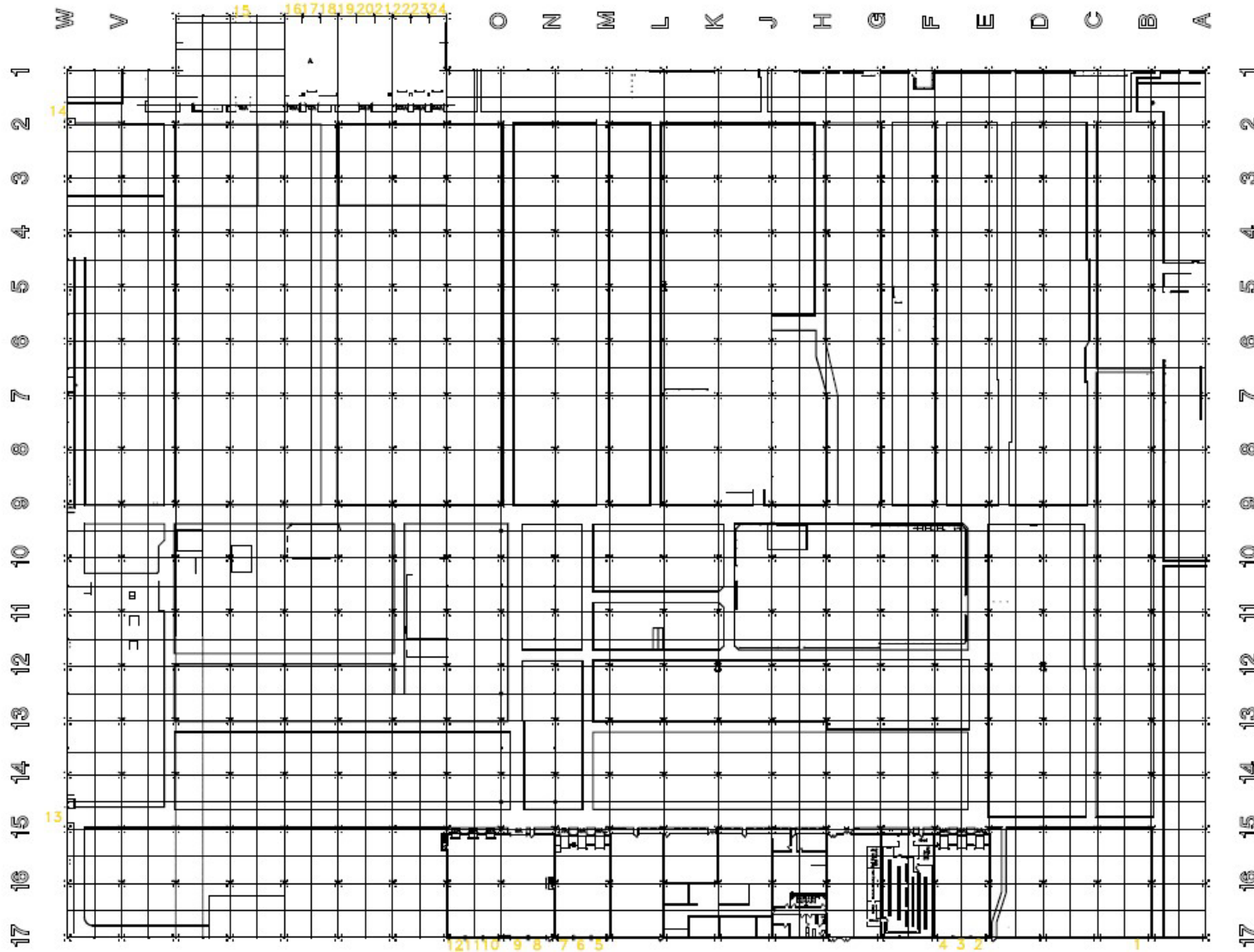

Overhead Door Dimensions		
Dock Door	Inside	Outside
2	8' X 10'	12' X 16'
3	8' X 10'	12' X 16'
4	8' X 10'	12' X 16'
5	8' X 10'	12' X 16'
6	8' X 10'	12' X 16'
7	8' X 10'	12' X 16'
10	8' X 10'	12' X 16'
11	8' X 10'	12' X 16'
12	8' X 10'	12' X 16'
16	10' X 12'	12' X 16'
17	10' X 12'	12' X 16'
18	No inside door	12' X 16'
19	No inside door	12' X 16'
20	10' X 12'	12' X 16'
21	No inside door	12' X 16'
22	10' X 12'	12' X 16'
23	10' X 12'	12' X 16'
24	10' X 12'	12' X 16'
Ground Level Doors		
1	No inside door	8' X 10'
8	No inside door	12' X 16'
9	12' X 16'	12' X 16'
13	No inside door	12' X 16'
14	No inside door	12' X 16'
15	10' X 11'6"	10' X 11'6"



## FOR MORE INFORMATION CONTACT:

---

Erica Holton | PRINCIPAL

Plante Moran Realpoint

[Erica.Holton@plantemoran.com](mailto:Erica.Holton@plantemoran.com)

248-603-5306

Sean Abelarde | SENIOR CONSULTANT

Plante Moran Realpoint

[Sean.Abelarde@plantemoran.com](mailto:Sean.Abelarde@plantemoran.com)

248-885-6595