

Downtown Culver City

2nd Gen Restaurant Space For Lease

9343 Culver Blvd., Culver City, CA 90232



Available

Size: ±2,075 SF
Rent: \$12.00 PSF/Mo., NNN
NNN: ±\$0.50 PSF/Mo.
Available: December 2026

Features

- ▶ Fully built-out 2nd generation restaurant space
- ▶ Large outdoor patio (city-owned)
- ▶ No key money
- ▶ Prior tenant served beer and wine
- ▶ Current interior seating for ±50 people and patio seating for over ±25 people
- ▶ In the heart of Downtown Culver City
- ▶ Over 1,000 public parking spaces within 1 block
- ▶ Across from The Culver Steps with Amazon Studios, Erewhon, Salt & Straw, Sephora and many more
- ▶ Strong demographics with an HHI of ± \$178,413 within two miles
- ▶ *Do not disturb existing tenant*

Prospective tenants are hereby advised that all uses are subject to City approval



Available

±2,075 SF

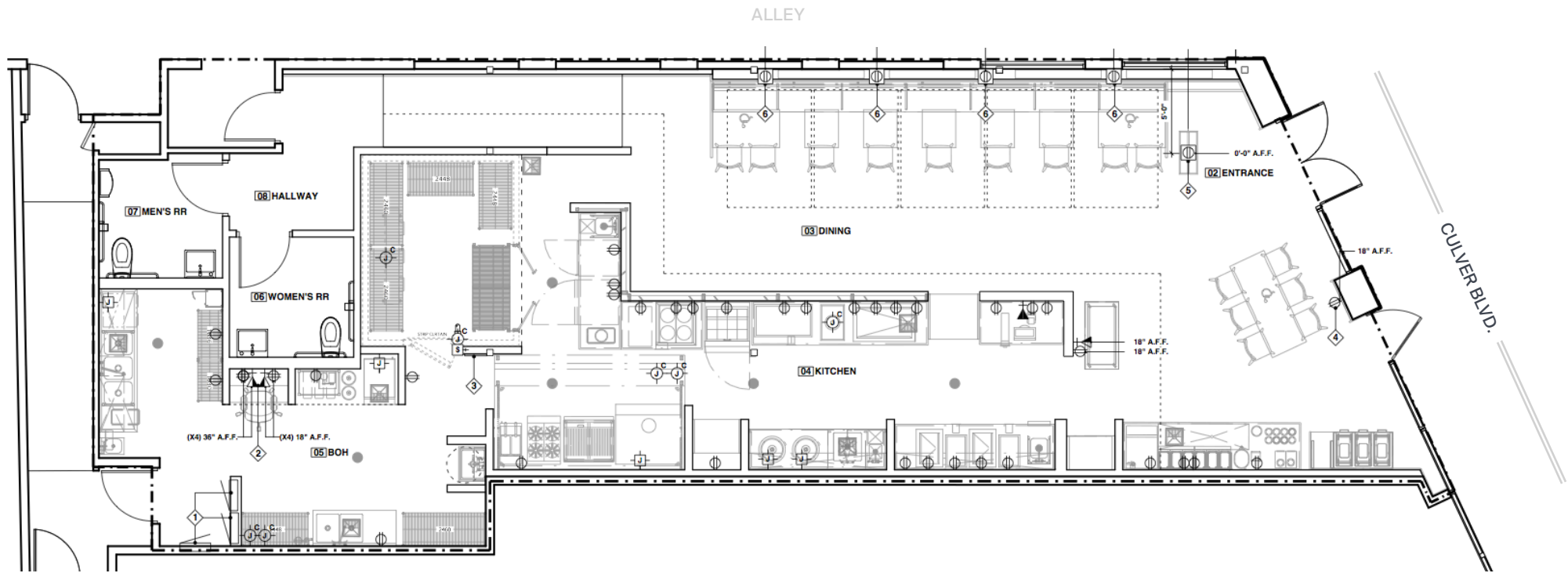

Dining Room

Current interior seating for ±50 people



Kitchen

Grease interceptor in place



Downtown Culver City

Surrounding amenities

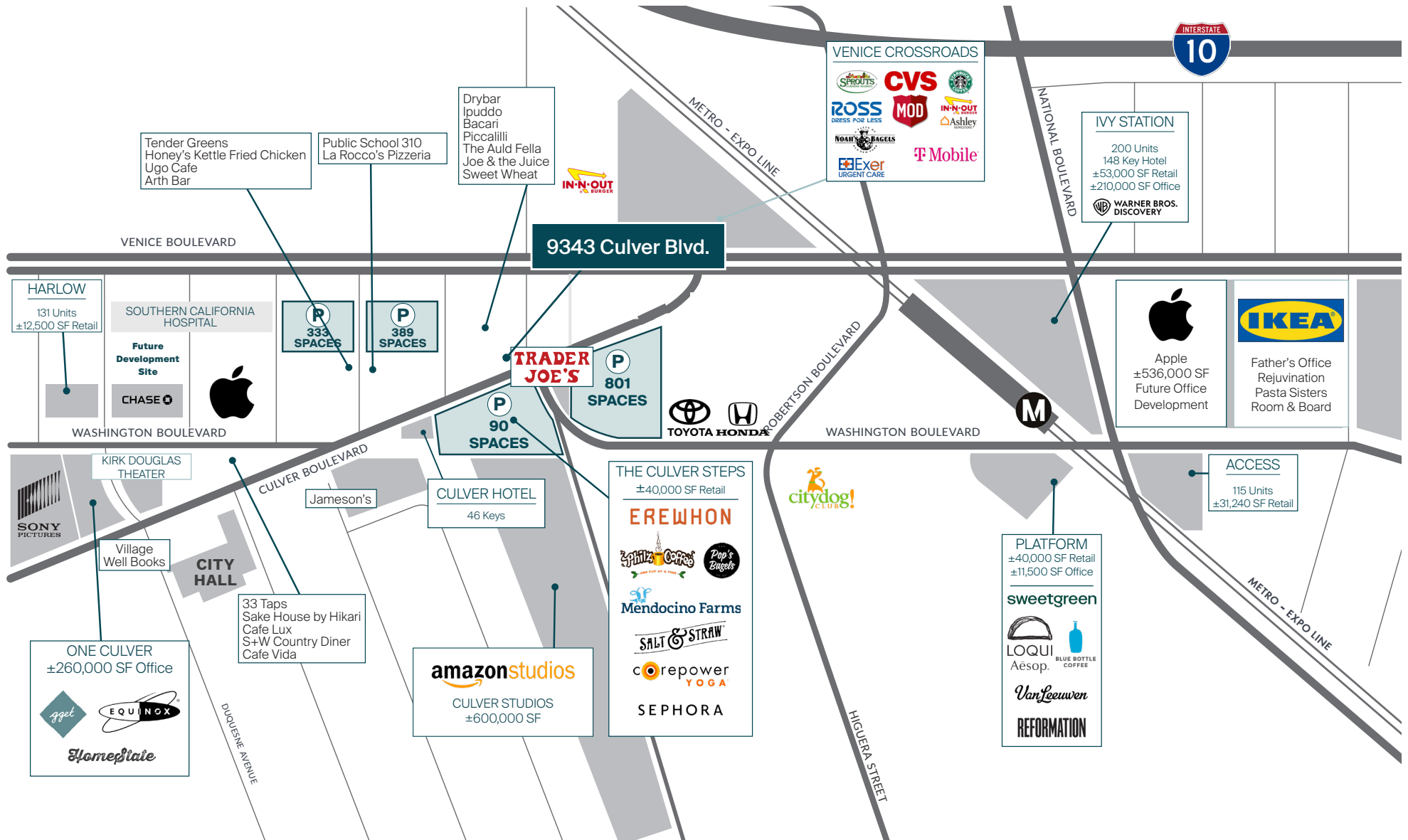

Looking West



Looking Southeast



Culver City Profile



	0.5 Mile	1 Mile	2 Mile
POPULATION			
2025 Estimated Population	12,331	40,803	132,269
2030 Projected Population	12,028	39,905	129,065
2020 Census Population	11,819	39,068	128,730
2010 Census Population	11,485	38,073	126,606
Projected Annual Growth 2025 to 2030	-0.5%	-0.4%	-0.5%
Historical Annual Growth 2010 to 2025	0.5%	0.5%	0.3%
2025 Median Age	35.6	36.1	38.1
HOUSEHOLDS			
2025 Estimated Households	6,307	19,407	55,480
2030 Projected Households	6,368	19,647	55,773
2020 Census Households	6,032	18,655	54,255
2010 Census Households	5,746	17,738	53,246
Projected Annual Growth 2025 to 2030	0.2%	0.2%	0.1%
Historical Annual Growth 2010 to 2025	0.7%	0.6%	0.3%
RACE & ETHNICITY			
2025 Estimated White	47.5%	47.3%	46.0%
2025 Estimated Black or African American	8.3%	8.0%	10.4%
2025 Estimated Asian or Pacific Islander	19.8%	19.7%	17.2%
2025 Estimated American Indian or Native Alaskan	0.7%	0.9%	0.9%
2025 Estimated Other Races	23.8%	24.2%	25.5%
2025 Estimated Hispanic	28.7%	28.9%	29.6%
INCOME			
2025 Estimated Average Household Income	\$177,635	\$174,626	\$178,413
2025 Estimated Median Household Income	\$132,573	\$125,156	\$125,369
2025 Estimated Per Capita Income	\$90,952	\$83,281	\$75,158
EDUCATION			
2025 Estimated High School Graduate	6.8%	7.9%	10.3%
2025 Estimated Some College	12.7%	14.0%	13.2%
2025 Estimated Associates Degree Only	5.5%	5.5%	5.5%
2025 Estimated Bachelors Degree Only	40.3%	38.2%	34.2%
2025 Estimated Graduate Degree	29.2%	28.7%	27.7%
BUSINESS			
2025 Estimated Total Businesses	915	3,056	7,800
2025 Estimated Total Employees	9,145	29,519	61,720
2025 Estimated Employee Population per Business	10.0	9.7	7.9
2025 Estimated Residential Population per Business	13.5	13.4	17.0

Your trusted *partners*

Lee Shapiro

Lee.Shapiro@kwprealestate.com

310-887-6226

DRE #00961769