

### DOOR TYPE & VIEW WINDOW

SCALE: 1/4" = 1'-0"

### WALL LEGEND

- NEW 1 HOUR RATED WALL & CEILING: 3/8" FRAMING w/ 5/8" TYPE "X" DRYWALL EACH SIDE
- NEW 3/8" INTERIOR METAL STUD WALL TO ROOF FRAMING WITH 5/8" TYPE "X" DRYWALL EACH SIDE & SOUND BATTS.
- NEW 2 HOUR MIN. RATED DEMISING WALL: METAL TOP & BOT. TRACK w/ TWO 4" METAL STUDS WITH 3 LAYERS OF 5/8" TYPE "X" DRYWALL EACH SIDE & SOUND BATTS, TO BOTTOM OF ROOF.
- EXISTING WALL CONSTRUCTION.

### NOTES

- 1 EXTEND STEEL TUBE POST TO ABOVE CEILING & BRACE TO ROOF STRUCTURE. MOUNT SPEAKER TO POST.
- 2 REMOVE EXISTING DOOR & FRAME. PATCH OPENING.
- 3 NEW COUNTERS
- 4 INSTALL OPAQUE FILM TO EXISTING GLASS
- 5 INSTALL PANIC DEVICE



**MICHAEL CHAMBLEE**  
ARCHITECT

1833 COUNTRY CLUB ROAD  
OFFICE: 812-988-1432  
NASHVILLE, INDIANA 47448  
FAX: 812-988-1833

**FARREL'S EXTREME BODY SHAPING**  
430 LANDMARK AVENUE  
BLOOMINGTON, INDIANA

**A1**  
Date: 04/14/15

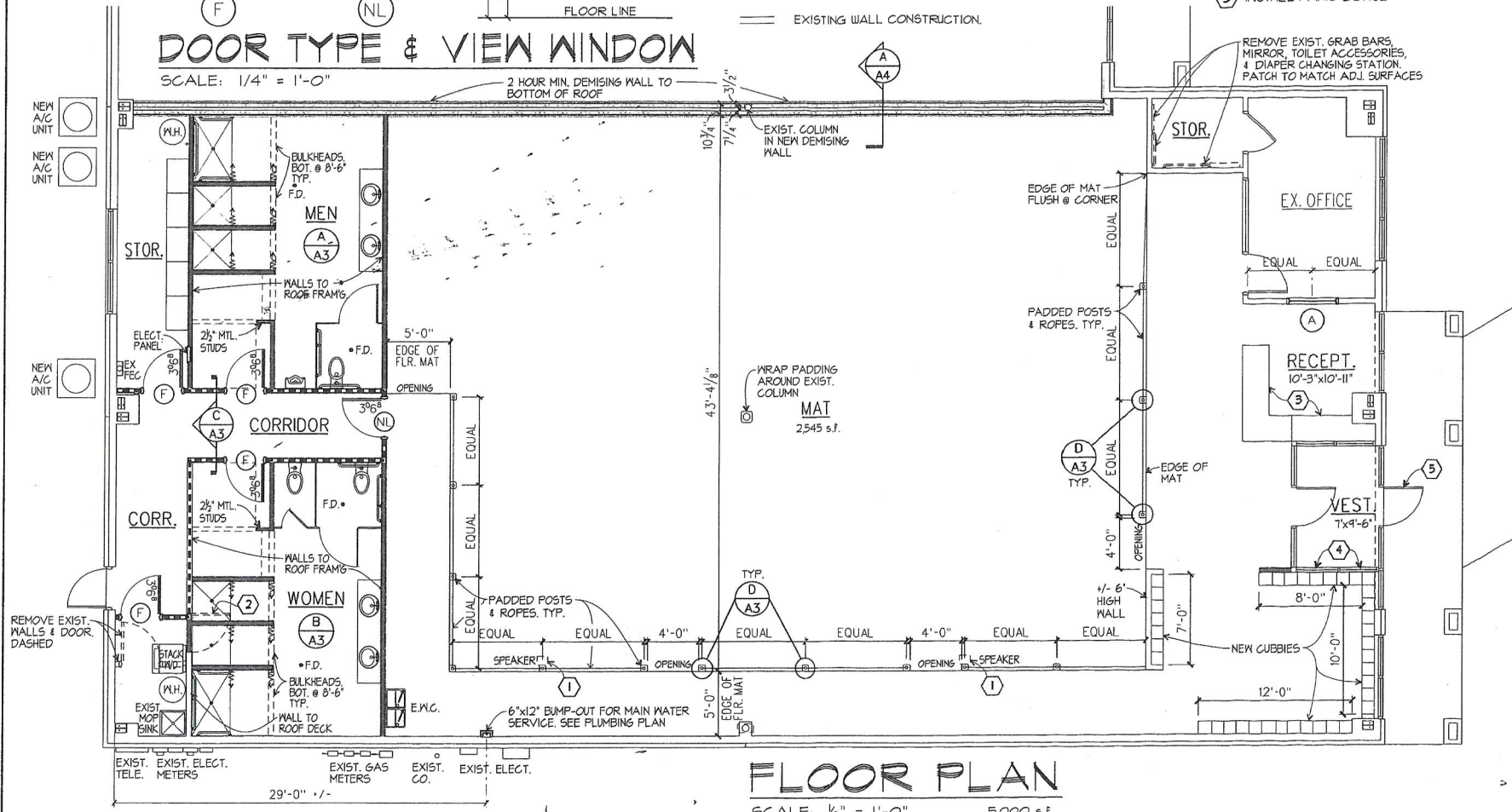

### FLOOR PLAN

SCALE: 1/8" = 1'-0" 5,000 s.f.

430 LANDMARK AVE.