

EATON GREEN
ESTATE AGENTS



For Sale
Pick up shop
EATON GREEN
COMMERCIAL
020 7978 8668
www.eatongreen.com





£240,000

Share of Freehold

*Maple Road,
Penge,
SE20*

An excellent opportunity to purchase a **900 sq. ft.** ground floor commercial unit in **Penge**. The property is in **shell and core condition**, providing a blank canvas for a variety of business or investment opportunities.

Key Features:

- **Approx. 900 sq. ft.** all on the ground floor
- Suitable for **retail, office space, workshop, or studio**
- Potential for an **outdoor seating area** (subject to local authority consent)
- **Share of Freehold opportunity** in a prime location

Business Rates:

According to the **Valuation Office Agency (VOA)**, the rateable value is **£5,100**, meaning, subject to a successful application, you **may qualify for Small Business Rates Relief**, potentially resulting in **zero business rates payable**. We recommend verifying this independently. Available for **£240,000**, this is a fantastic opportunity for investors and owner-occupiers alike. For further details or to arrange a viewing, please contact us.

FEATURES:

E Class Use
Ground floor only
Condition Shell
Share Of Freehold



Floorplan

GROUND FLOOR
891 SQ. FT. (82.8 SQ. M.) APPROX.

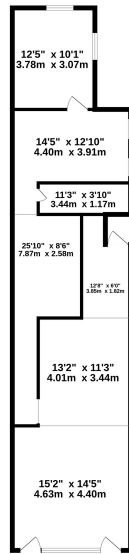

TOTAL FLOOR AREA: 891 sq. ft. (82.8 sq. m.) approx.
While every effort has been made to ensure the accuracy of the floorplan, we do not warrant, represent or guarantee the accuracy of the floorplan. The plan is for guidance purposes only and should be used as such by any prospective purchaser. The seller, agent and applicable laws make no warranty, representation or guarantee as to their quality or efficiency can be given.
- made with Mapbox ©2020

Camberwell Estate Agents

Located in the iconic Hanover Square minutes from Oxford Circus & Bond Street tube stations and just off Regent Street.

📍 112 Denmark Hill Camberwell
SE5 8RX London
Tel: 020 7978 8668

Mayfair Estate Agents

Located in the iconic Hanover Square minutes from Oxford Circus & Bond Street tube stations and just off Regent Street.

📍 17 Hanover Square Mayfair
London W1S 1JB
Tel: 020 7183 8887

ⓘ Under the Property Misdescription Act 1991 we endeavour to make our sales details accurate and reliable but they should not be relied upon as statements or representations of fact and they do not constitute any part of an offer of contract. The seller does not make any representations to give any warranty in relation to the property and we have no authority to do so on behalf of the seller. Services, fittings and equipment referred to in the sales details have not been tested (unless otherwise stated) and no warranty can be given as to their condition. We strongly recommend that all the information which we provide about the property is verified by yourself or your advisers.

Under the Estate Agency Act 1991 you will be required to give us financial information in order to verify your financial position before we can recommend any offer to the vendor.

