

General Information

Occupancy	C/I Building	Pre. Use	General Retail
Description	C/I Building 02 (G	Pre. Framing	Wood Joist
Story Height	1	Pre. Finish	Finished Open
Type	N/A	# of Units	0

SB	B	1	U
-----------	----------	----------	----------

Wall Type	1: 1(438')
Heating	10443 sqft
A/C	
Sprinkler	10443 sqft

Plumbing RES/CI

	#	TF	#	TF
Full Bath	0		0	
Half Bath	0		0	
Kitchen Sinks	0		0	
Water Heaters	0		0	
Add Fixtures	0		0	
Total	0		0	

Roofing

<input type="checkbox"/> Built Up	<input type="checkbox"/> Tile	<input type="checkbox"/> Metal
<input type="checkbox"/> Wood	<input type="checkbox"/> Asphalt	<input type="checkbox"/> Slate
<input type="checkbox"/> Other		

GCK Adjustments

<input type="checkbox"/> Low Prof	<input type="checkbox"/> Ext Sheat	<input type="checkbox"/> Insulatio
<input type="checkbox"/> SteelGP	<input type="checkbox"/> AluSR	<input type="checkbox"/> Int Liner
<input type="checkbox"/> HGSR	<input type="checkbox"/> PPS	<input type="checkbox"/> Sand Pnl

Exterior Features

Description	Area	Value
Canopy, Shed Type	575	\$3,100

Special Features

Description	Value
Can, CT 575sqft	\$16,130

Other Plumbing

Description	Value

Building Computations

Sub-Total (all floors)	\$610,289	Garages	\$0
Racquetball/Squash	\$0	Fireplaces	\$0
Theater Balcony	\$0	Sub-Total (building)	\$629,519
Plumbing	\$0	Quality (Grade)	\$1
Other Plumbing	\$0	Location Multiplier	0.94
Special Features	\$16,130	Repl. Cost New	\$650,923
Exterior Features	\$3,100		

Floor/Use Computations

Pricing Key	GCM
Use	GENRET
Use Area	10443 sqft
Area Not in Use	0 sqft
Use %	100.0%
Eff Perimeter	438'
PAR	4
# of Units / AC	0
Avg Unit sz dpth	0
Floor	1
Wall Height	16'
Base Rate	\$68.97
Frame Adj	(\$10.86)
Wall Height Adj	\$1.38
Dock Floor	\$0.00
Roof Deck	\$0.00
Adj Base Rate	\$59.49
BPA Factor	1.00
Sub Total (rate)	\$59.49
Interior Finish	\$0.00
Partitions	\$0.00
Heating	\$0.00
A/C	(\$5.00)
Sprinkler	\$3.95
Lighting	\$0.00
Unit Finish/SR	\$0.00
GCK Adj.	\$0.00
S.F. Price	\$58.44
Sub-Total	
Unit Cost	\$0.00
Elevated Floor	\$0.00
Total (Use)	\$610,289

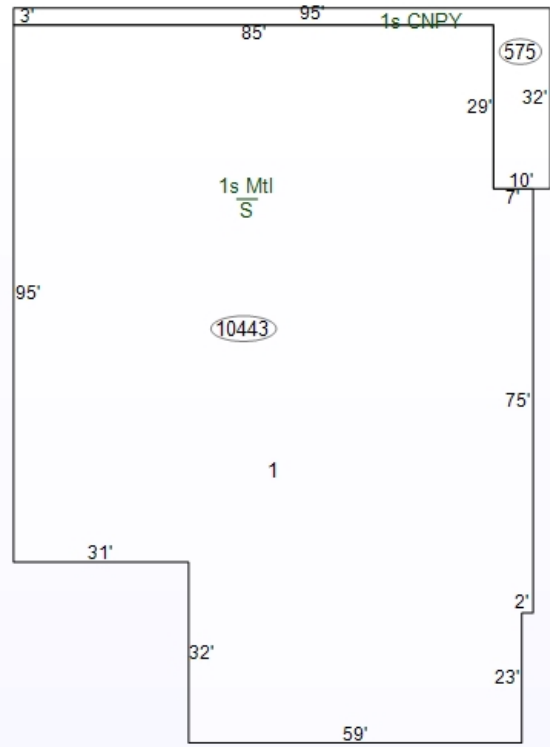

Summary of Improvements

Description	Story Height	Constr Type	Grade	Year Built	Eff Year	Eff Co Age	nd	Base Rate	LCM	Adj Rate	Size	RCN	Norm Dep	Remain. Value	Abn Obs	PC	Nbhd	Mrkt	Cap 1	Cap 2	Cap 3	Improv Value
1: C/I Building 02 (Grocery)	1	Metal	C+2	2023	2023	1	A		0.94		10,443 sqft	\$650,923	3%	\$631,390	0%	40%	1.0000	1.0000	0.00	0.00	100.00	\$252,600