

Class 'A' Office Space Available

Mach One 2290 E Yeager Dr

71,039 SF Available



Sublease Detail

Floor:	1 - 19,978 RSF 2 - 51,061 RSF
Available Space:	71,039 RSF
Rent Rate:	Negotiable
Term:	Thru July 31, 2028
Availability:	Immediate
Parking:	7 spaces/1,000 SF

Key Highlights

- High-end, fully furnished call center, new construction
- Approximately 560 workstations
- Café facility with equipment
- Conference and training rooms in various sizes and configurations
- Strong sublessor
- Numerous retail amenities in close proximity to the Building



Floorplan

1st Floor

+/- 19,978 SF



Workstations	160
Private offices	3
Training room	1
Large conference rooms	1
Small conference rooms	5

Tiffany Winne

+1 602 402 6068

tiffany.winne@streamrealty.com

Information contained herein has been obtained from sources deemed reliable. While we believe this information to be true, Savills makes no guarantee, warranties or representations as to the completeness or accuracy thereof. All information submitted is subject to errors and/or omissions.



Floorplan

2nd Floor

+/- 51,061 SF

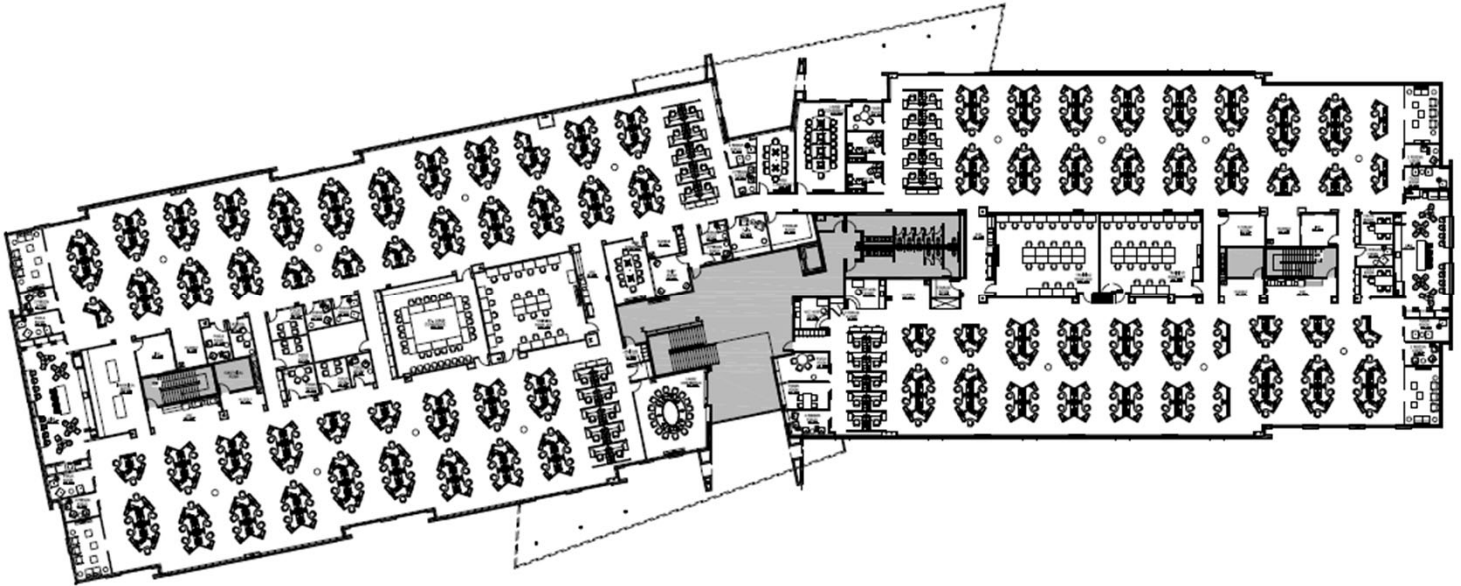

Workstations	407
Private offices	2
Training rooms	3
Large conference rooms	3

Tiffany Winne

+1 602 402 6068

tiffany.winne@streamrealty.com

Information contained herein has been obtained from sources deemed reliable. While we believe this information to be true, Savills makes no guarantee, warranties or representations as to the completeness or accuracy thereof. All information submitted is subject to errors and/or omissions.