

# 144 Lystra

144 Old Lystra Road,  
Chapel Hill, NC 27517



# 143,800 SF

For Sale and Lease



# PROPERTY SPECS

<b>Building area</b>	143,800 SF
<b>Available space for lease</b>	55,000 SF
<b>Year built</b>	1986
<b>Construction</b>	Pre-cast concrete
<b>Office area</b>	25,000 SF
<b>Warehouse area</b>	118,800 SF
<b>Grade-level doors</b>	One (1)
<b>Dock-high doors</b>	Nineteen (19)
<b>Clear height</b>	22' - 35'
<b>Column spacing</b>	30' x 40' 50' x 40'
<b>Truck court</b>	160' with 100' apron
<b>Parking</b>	90 spaces
<b>Warehouse lighting</b>	T5
<b>HVAC</b>	Partially conditioned
<b>Electric</b>	Three-phase power (600V)
<b>Sprinkler</b>	ESFR and wet system
<b>Water</b>	City of Chapel Hill
<b>Sewer</b>	Septic system

*Contact for pricing!*

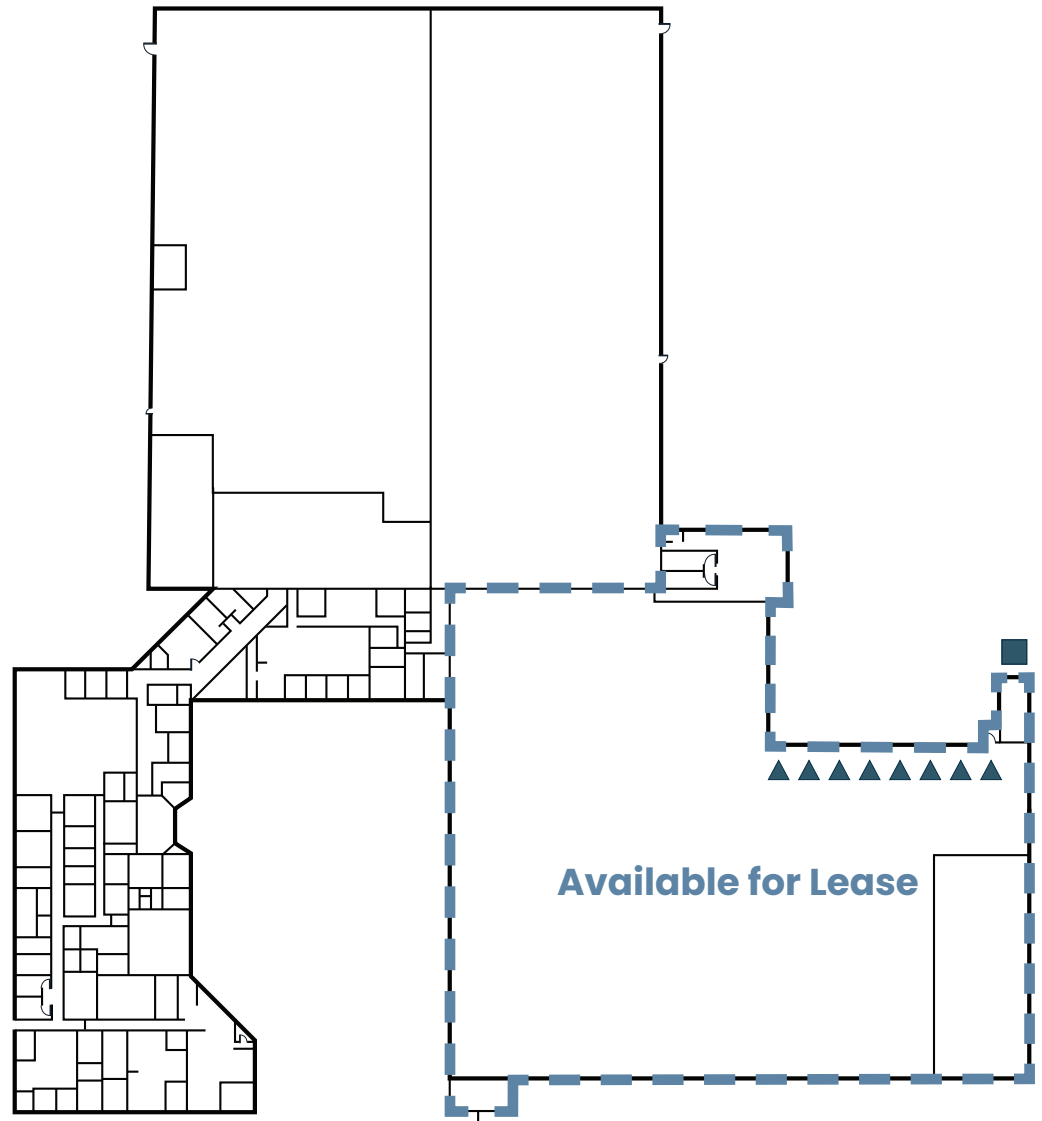

▲ Dock High Door

■ Drive-In Door

# PROPERTY PHOTOS

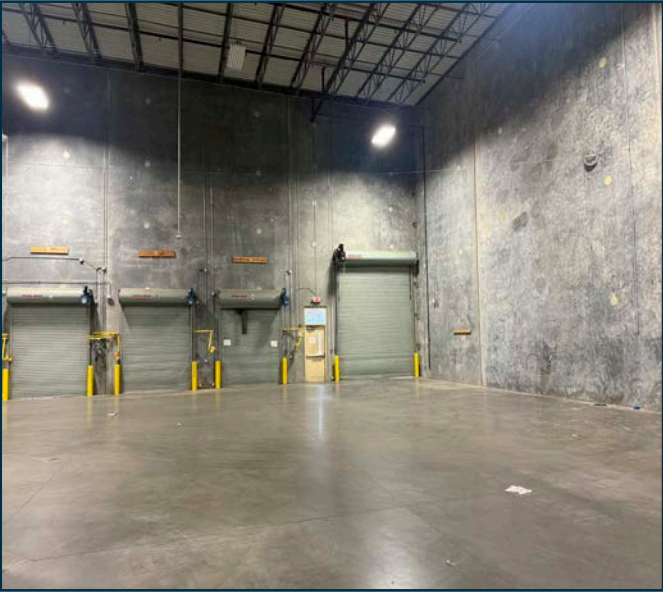
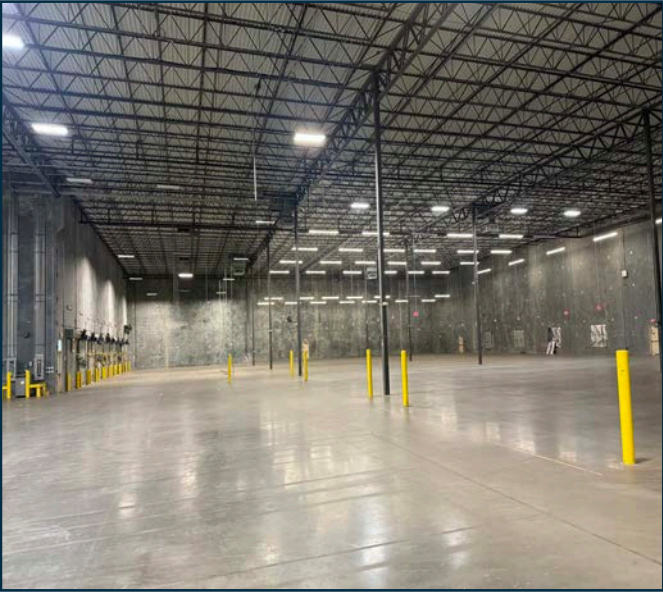

# LOCATION OVERVIEW

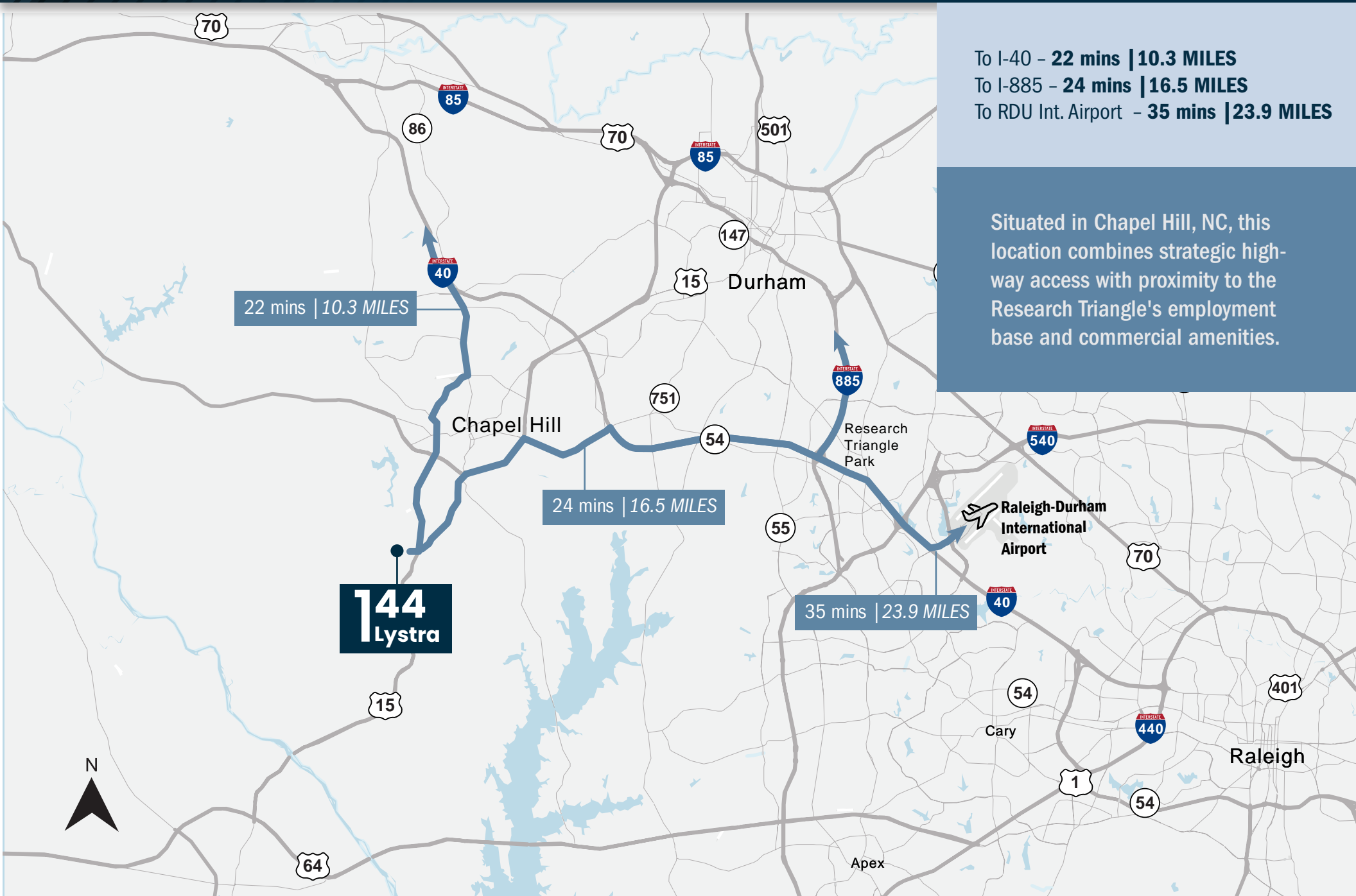

To I-40 - **22 mins | 10.3 MILES**  
To I-885 - **24 mins | 16.5 MILES**  
To RDU Int. Airport - **35 mins | 23.9 MILES**

Situated in Chapel Hill, NC, this location combines strategic highway access with proximity to the Research Triangle's employment base and commercial amenities.

**144**  
**Lystra**





**CONTACT:**

**JUSTIN BOOTH**

+1 919-424-8464

[Justin.booth@jll.com](mailto:Justin.booth@jll.com)

**AL WILLIAMS**

+1 919-424-8154

[Al.williams@jll.com](mailto:Al.williams@jll.com)

**AUSTIN JACKSON**

+1 919-424-8456

[Austinp.jackson@jll.com](mailto:Austinp.jackson@jll.com)

Although information has been obtained from sources deemed reliable, neither Owner nor JLL makes any guarantees, warranties or representations, express or implied, as to the completeness or accuracy as to the information contained herein. Any projections, opinions, assumptions or estimates used are for example only. There may be differences between projected and actual results, and those differences may be material. The Property may be withdrawn without notice. Neither Owner nor JLL accepts any liability for any loss or damage suffered by any party resulting from reliance on this information. If the recipient of this information has signed a confidentiality agreement regarding this matter, this information is subject to the terms of that agreement.

©2026 Jones Lang LaSalle IP, Inc. All rights reserved has context menu