

**NOW  
LEASING**

**RETAIL/PROFESSIONAL OFFICE  
9515 GATEWAY WEST  
EL PASO-EAST/CENTRAL**

**LOCATION:**

**AMENITIES:**

**APPROX. 5,575 USF/RSF  
SUITE E**

- Large Space with Excellent Visibility and Over 33 Feet of Highly Visible Freeway Frontage and Great Access
- Private Entrances and Restrooms
- Tenant Controlled Refrigerated Air & Heating Systems
- Located on El Paso's Booming Eastside, Situated Between Viscount and McRae
- Building Signage & Huge Pylon Sign Visible from Interstate 10 and Gateway
- Ample Free Parking with Over 150 Spaces Available

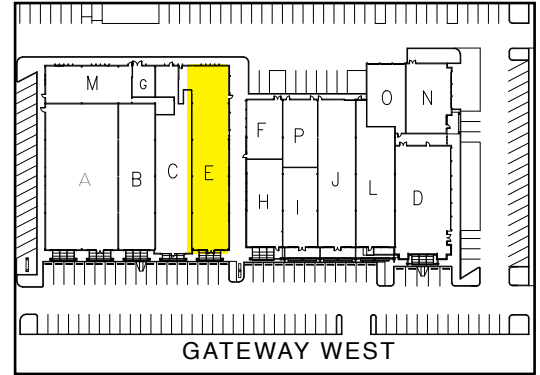
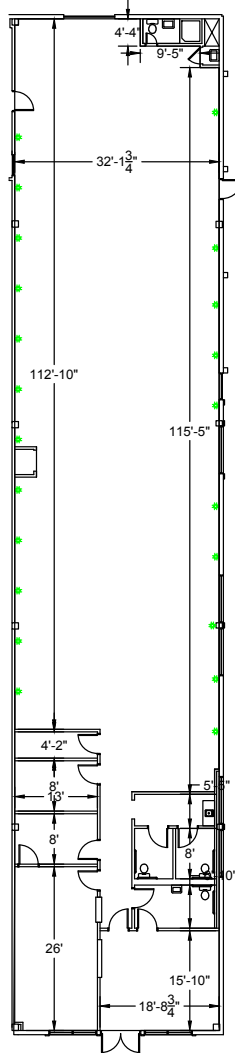

**TRAFFIC COUNT**

**173,228+** On Interstate 10  
**per day**

**28,098+** At the Intersection of  
**per day** Gateway West & McRae Blvd

**18,526+** At the Intersection of  
**per day** Gateway West & Viscount

**NEARBY**

Del Sol Medical Center, Cielo Vista Mall, Fort Bliss, The Fountains at Farah, Bassett Place Mall, Las Palmas Marketplace, El Paso Airport



**915-532-3456**

[www.epleasing.com](http://www.epleasing.com) | [info@epleasing.com](mailto:info@epleasing.com)

PROFESSIONALLY MANAGED BY EP SHALOM MANAGEMENT, LLC  
444 EXECUTIVE CENTER BLVD., SUITE 120, EL PASO, TX 79902

Notwithstanding any other information (including, without limitation, any marketing, sales, advertising, brochures, or similar information), all prices, building design, architectural renderings, plans, amenities, features and specifications or any and all improvements to any part of the property are subject to change or cancellation without notice.