

FOR LEASE

LENDRUM CENTRE

5712 - 111 STREET

Edmonton, AB T6H 3G1



Photos herein are the property of their respective owners and use of these images without the express written consent of the owner is prohibited.

CBRE



PROPERTY OVERVIEW

- + Fantastic opportunity to locate in a busy grocery anchored neighbourhood retail centre
- + Excellent retail and/or professional opportunity
- + Join Sunterra Market, Val Berg's Mens Wear, Petro Canada, fashion, dental and other retail users
- + Competitive lease rates and low operating costs
- + 1,500 sq. ft. unit available
- + Pylon signage available



CONTACT US

JAMES YOUNG

Associate Vice President
1+ 780 917 4643
james.young@cbre.com

DANIEL YARMON

Associate
1+ 780 229 4650
daniel.yarmon@cbre.com

CHARLI ELBER

Sales Trainee
1+ 780 229 4694
charli.elber@cbre.com

www.cbre.ca/edmonton

CBRE

FOR LEASE LENDRUM CENTRE

5712 - 111 STREET
Edmonton, AB T6H 3G1

Address	5712 - 111 Street, Edmonton
Area	1,500 sq. ft.
Op Costs	\$8.12 per sq. ft.
Lease Rate	\$27.00 per sq. ft.
Pylon Sign	\$100.00 for double-sided panel
Traffic Counts	24,500 vehicles per day
Available	Immediately



Distance	2015 Est. Population	Distance	Avg. Household Income
1 KM	6,651	1 KM	\$106,976
2 KM	55,460	2 KM	\$94,723
3 KM	154,459	3 KM	\$106,912

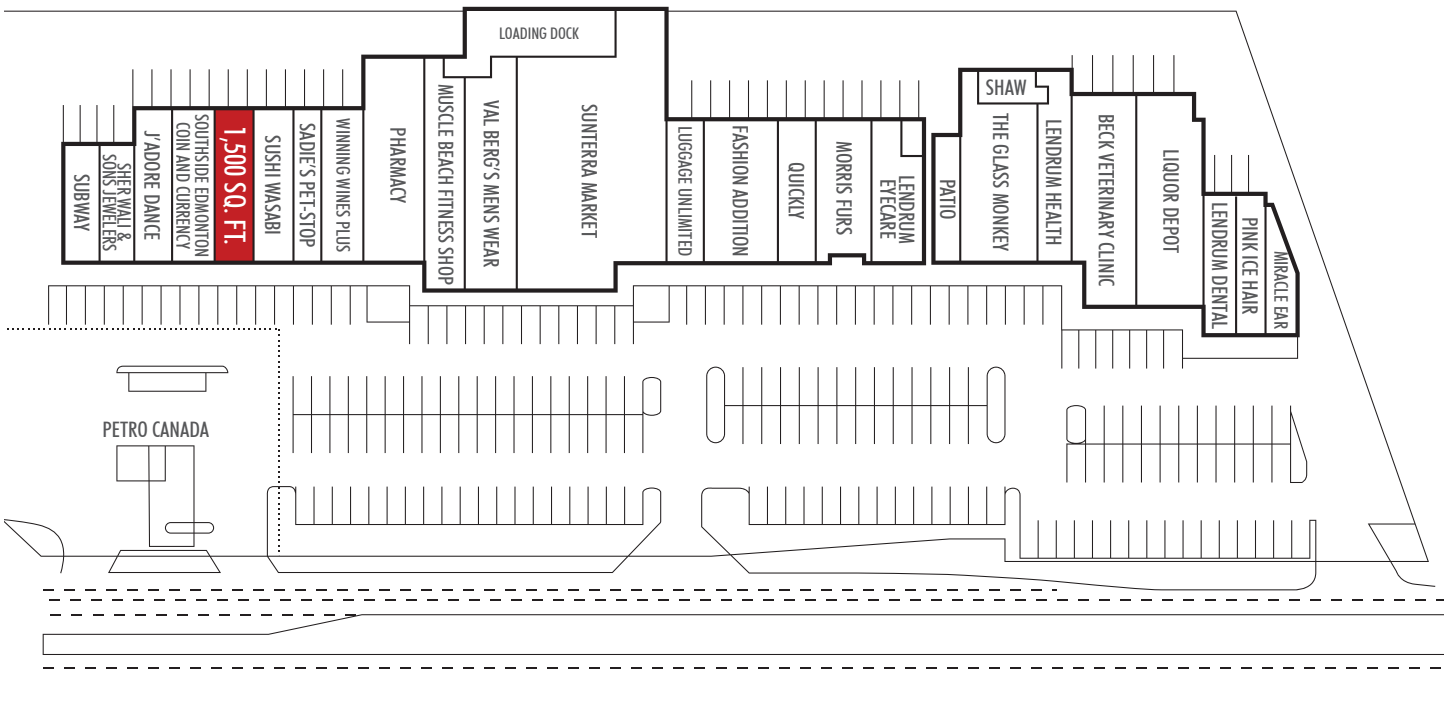

This disclaimer shall apply to CBRE Limited, Real Estate Brokerage, and to all other divisions of the Corporation; to include all employees and independent contractors ("CBRE"). The information set out herein, including, without limitation, any projections, images, opinions, assumptions and estimates obtained from third parties (the "Information") has not been verified by CBRE, and CBRE does not represent, warrant or guarantee the accuracy, correctness and completeness of the Information. CBRE does not accept or assume any responsibility or liability, direct or consequential, for the Information or the recipient's reliance upon the Information. The recipient of the Information should take such steps as the recipient may deem necessary to verify the Information prior to placing any reliance upon the Information. The Information may change and any property described in the Information may be withdrawn from the market at any time without notice or obligation to the recipient from CBRE. CBRE and the CBRE logo are the service marks of CBRE Limited and/or its affiliated or related companies in other countries. All other marks displayed on this document are the property of their respective owners. All Rights Reserved.