

10415 Papalote St. Houston, TX 77041

20,000-50,000 SF Available



Property Highlights

- + **Address:** 10415 Papalote Street, Houston, TX 77041
- + **Total Available SF:** 20,000-50,000 (multiple configurations possible)
- + **Office SF:** 11,038
- + **Climate Controlled SF:** ±9,000
- + **Clear Height:** 24'
- + **Dock-High Doors:** 23
- + **Drive-In Ramps:** 1
- + **Loading Configuration:** Cross-Dock
- + **Sprinklered:** Yes
- + **Column Spacing:** 40' x 40'
- + **Date Available:** 7/1/2026
- + **Sublease Term:** Through 12/31/2028 (Flexible)
- + Contact broker for pricing

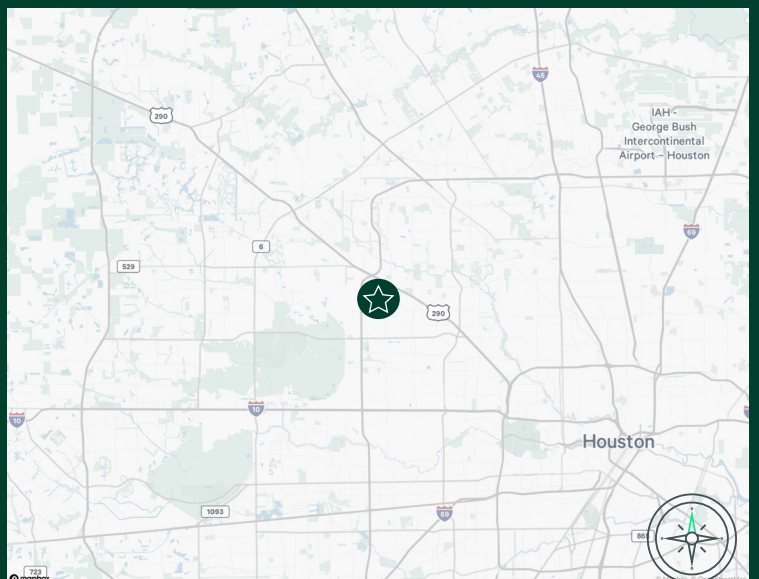

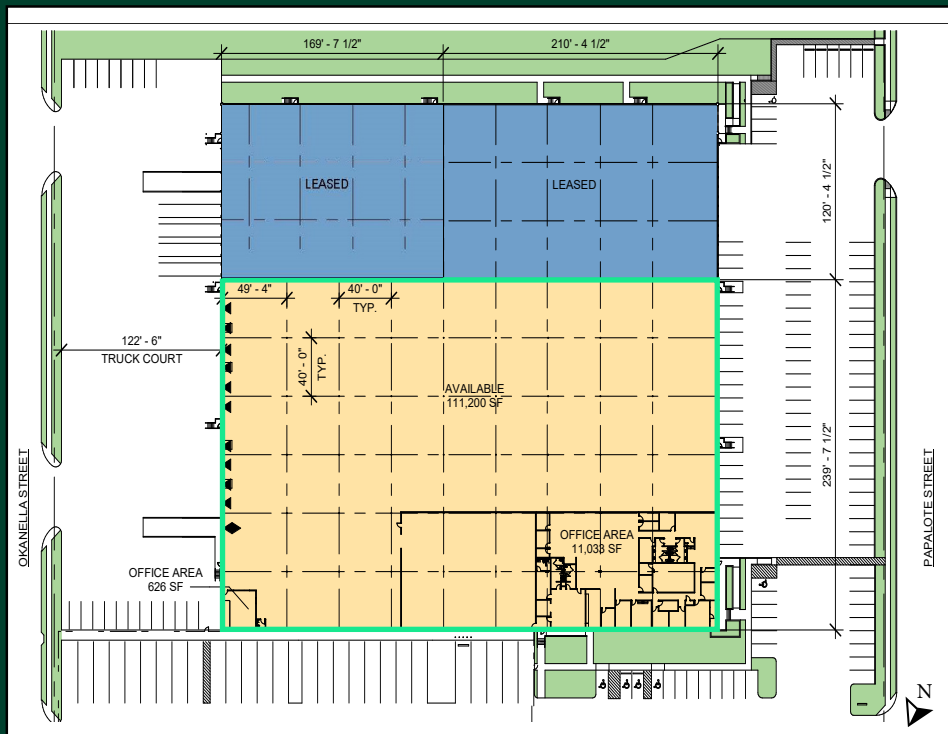

Contact Us

Thomas Berry

First Vice President

281 414 2329

thomas.berry@cbre.com

Jack Callaghan

Senior Associate

832 350 2222

jack.callaghan@cbre.com

© 2025 CBRE, Inc. All rights reserved. This information has been obtained from sources believed reliable, but has not been verified for accuracy or completeness. You should conduct a careful, independent investigation of the property and verify all information. Any reliance on this information is solely at your own risk. CBRE and the CBRE logo are service marks of CBRE, Inc. All other marks displayed on this document are the property of their respective owners, and the use of such logos does not imply any affiliation with or endorsement of CBRE. Photos herein are the property of their respective owners. Use of these images without the express written consent of the owner is prohibited.

