

Retail Development Sales & Leasing Group  
Retailer Services Group  
**For Lease**

**CBRE**

# 301 High Tech Road

Richmond Hill, ON



## Contact Us

### Retail Development Sales & Leasing Group

**Jennifer Crawford\***

Senior Sales Associate  
+1 416 495 6234  
jennifer.crawford@cbre.com

**Michelle Weir**

Transaction Coordinator  
+1 416 495 6225  
michelle.weir@cbre.com

### Retailer Services Group

**Geoffrey Smith\***

Director  
+1 416 495 6308  
geoffrey.smith@cbre.com

# Property Details



Ground floor opportunity in busy Bayview Glen retail node



Located at High Tech Road and Bayview Avenue in close proximity to Highway 407 and Highway 7



Triple A tenants in the immediate area include Loblaw, Petsmart, Walmart, Winners, Staples, Best Buy and Silver City



Separate exterior entrance with high visibility fascade signage



Ample surface parking available

**Unit Size:** 36,565 sq. ft. (approximately)

**Asking Rent:** Speak with Listing Agent

**TMI (2024):** Speak with Listing Agent

# Demographics

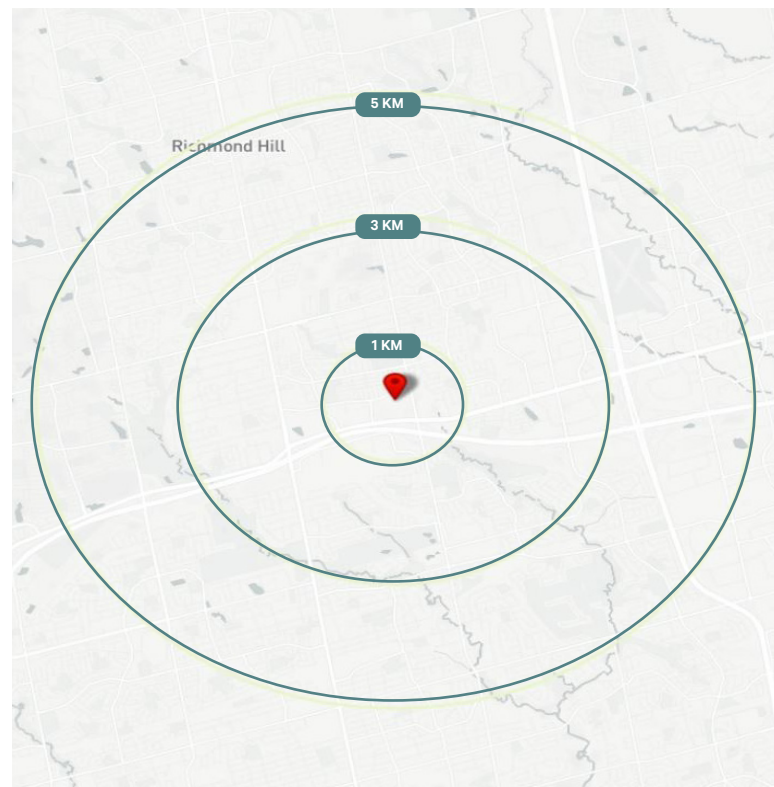

1 KM	
3,355 Household	\$143,862 Average Income
8,865 Daytime Population	325 Businesses

  

3 KM	
32,776 Household	\$129,889 Average Income
83,763 Daytime Population	2,690 Businesses

5 KM	
77,692 Household	\$145,097 Average Income
242,595 Daytime Population	7,558 Businesses

# Floor Plan

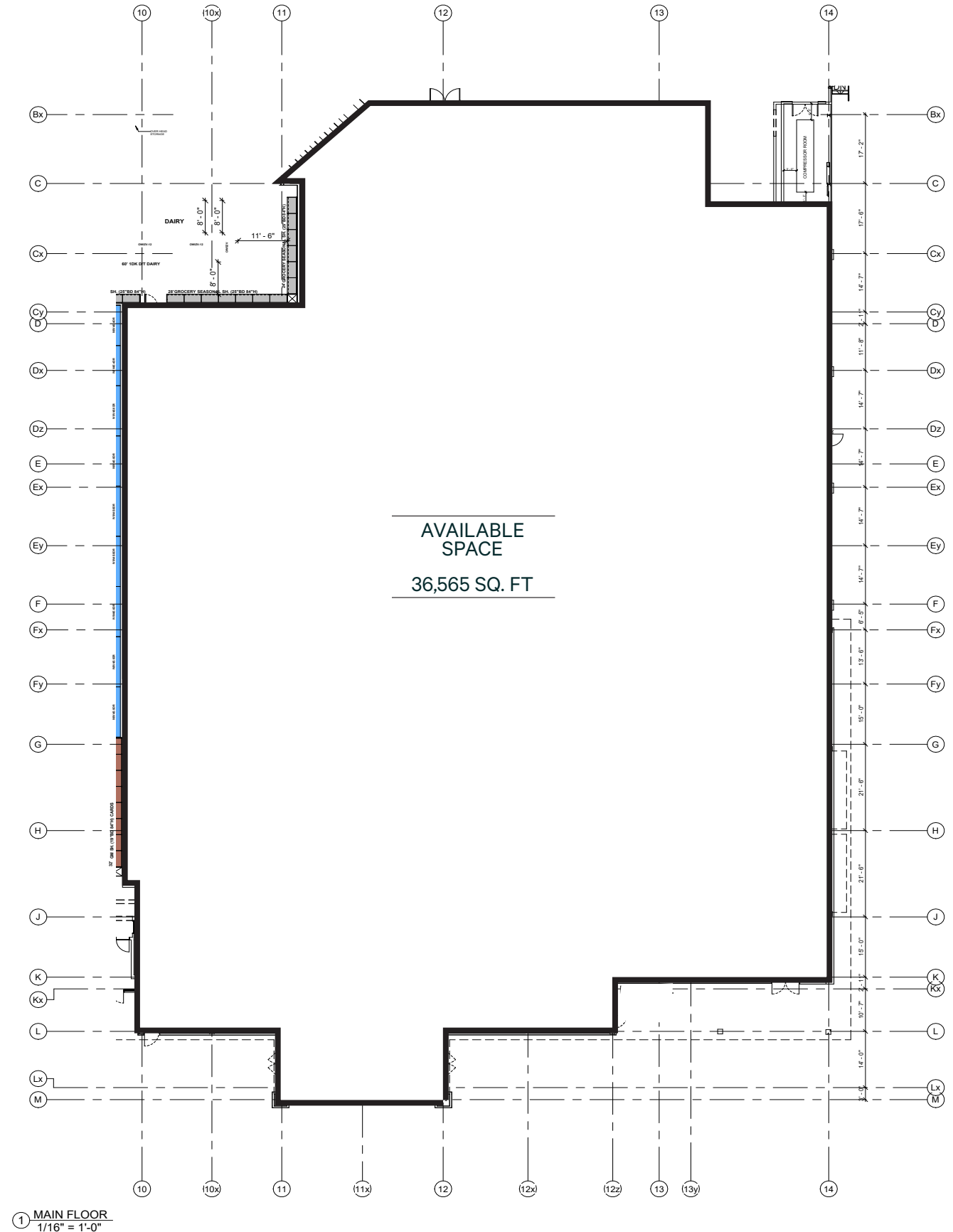

① MAIN FLOOR  
1/16" = 1'-0"

# Area Mapping



## Retail Development Sales & Leasing Group

## Retailer Services Group



**Jennifer Crawford\***  
Senior Sales Associate  
+ 1 416 495 6234  
jennifer.crawford@cbre.com



**Michelle Weir**  
Transaction Coordinator  
+ 1 416 495 6225  
michelle.weir@cbre.com



**Geoffrey Smith\***  
Director  
+ 1 416 495 6308  
geoffrey.smith@cbre.com

\*Sales Representative | All outlines are approximate | CBRE Limited, Brokerage | 2005 Sheppard Ave. E., Suite 800, Toronto, ON M2J 5B4 | www.cbre.ca

This disclaimer shall apply to CBRE Limited, Real Estate Brokerage, and to all other divisions of the Corporation; to include all employees and independent contractors ("CBRE"). The information set out herein, including, without limitation, any projections, images, opinions, assumptions and estimates obtained from third parties (the "Information") has not been verified by CBRE, and CBRE does not represent, warrant or guarantee the accuracy, correctness and completeness of the Information. CBRE does not accept or assume any responsibility or liability, direct or consequential, for the Information or the recipient's reliance upon the Information. The recipient of the Information should take such steps as the recipient may deem necessary to verify the Information prior to placing any reliance upon the Information. The Information may change and any property described in the Information may be withdrawn from the market at any time without notice or obligation to the recipient from CBRE. CBRE and the CBRE logo are the service marks of CBRE Limited and/or its affiliated or related companies in other countries. All other marks displayed on this document are the property of their respective owners. All Rights Reserved. Mapping Sources: Canadian Mapping Services canadamapping@cbre.com; MapPoint, DMTI Spatial, EnviroNics Analytics, Microsoft Bing, Google Earth

