

CUTLER SMALL BAY INDUSTRIAL/FLEX

230 North Cutler Drive | North Salt Lake, UT 84054

CUTLER SMALL BAY INDUSTRIAL/FLEX

230 North Cutler Drive | North Salt Lake, UT 84054

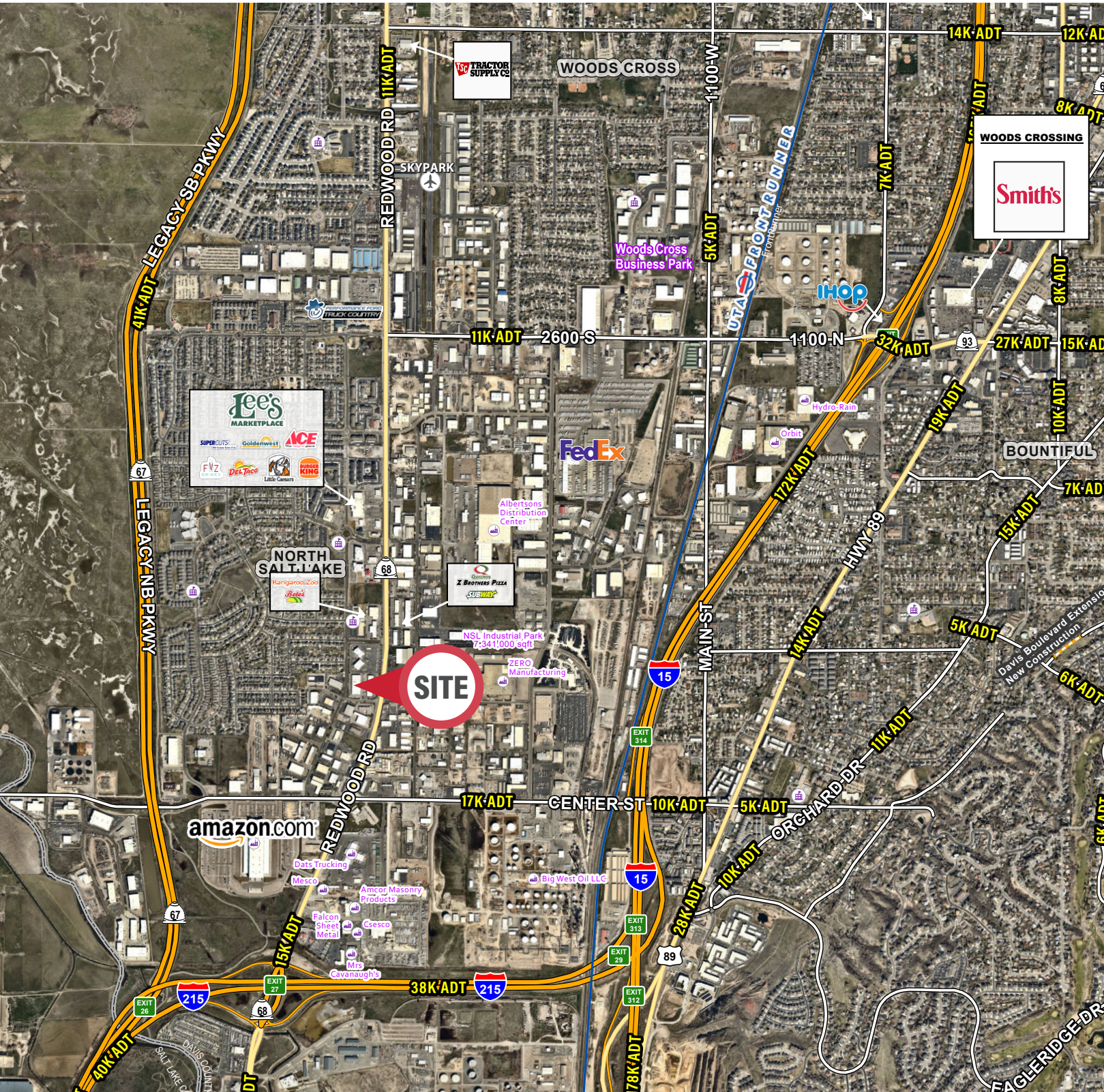

FOR LEASE

Unit E \$1.20 PSF NNN

- Total: 2,000 SF
- Loading: One (1) 10' x 14" Grade-Level Door
- Power: 240 Volt 3 Phase
- One (1) Restroom
- Shop Sink in Unit
- Skylight in Warehouse

Property Highlights

- 18' Clear Height
- Fire Sprinkler System
- LED Lighting
- Temperature Controlled Units
- Access: Quick Access to I-15, I-215, Redwood Road and Legacy Parkway
- Location: Located in the Highly Desirable North Salt Lake Sub-Market

Contact

SKYLER PETERSON, SIOR
Executive Vice President
m 801.656.7354
speterson@legendcommercial.com

TRE BOURDEAUX, SIOR
Vice President
m 801.824.0397
tbourdeaux@legendcommercial.com

PARKER TAGGART
Senior Associate
m 801.928.1815
ptaggart@legendcommercial.com



Contact

SKYLER PETERSON, SIOR
Executive Vice President
m 801.656.7354
speterson@legendcommercial.com

TRE BOURDEAUX, SIOR
Vice President
m 801.824.0397
tbourdeaux@legendcommercial.com

PARKER TAGGART
Senior Associate
m 801.928.1815
ptaggart@legendcommercial.com



CUTLER SMALL BAY INDUSTRIAL/FLEX

230 North Cutler Drive | North Salt Lake, UT 84054

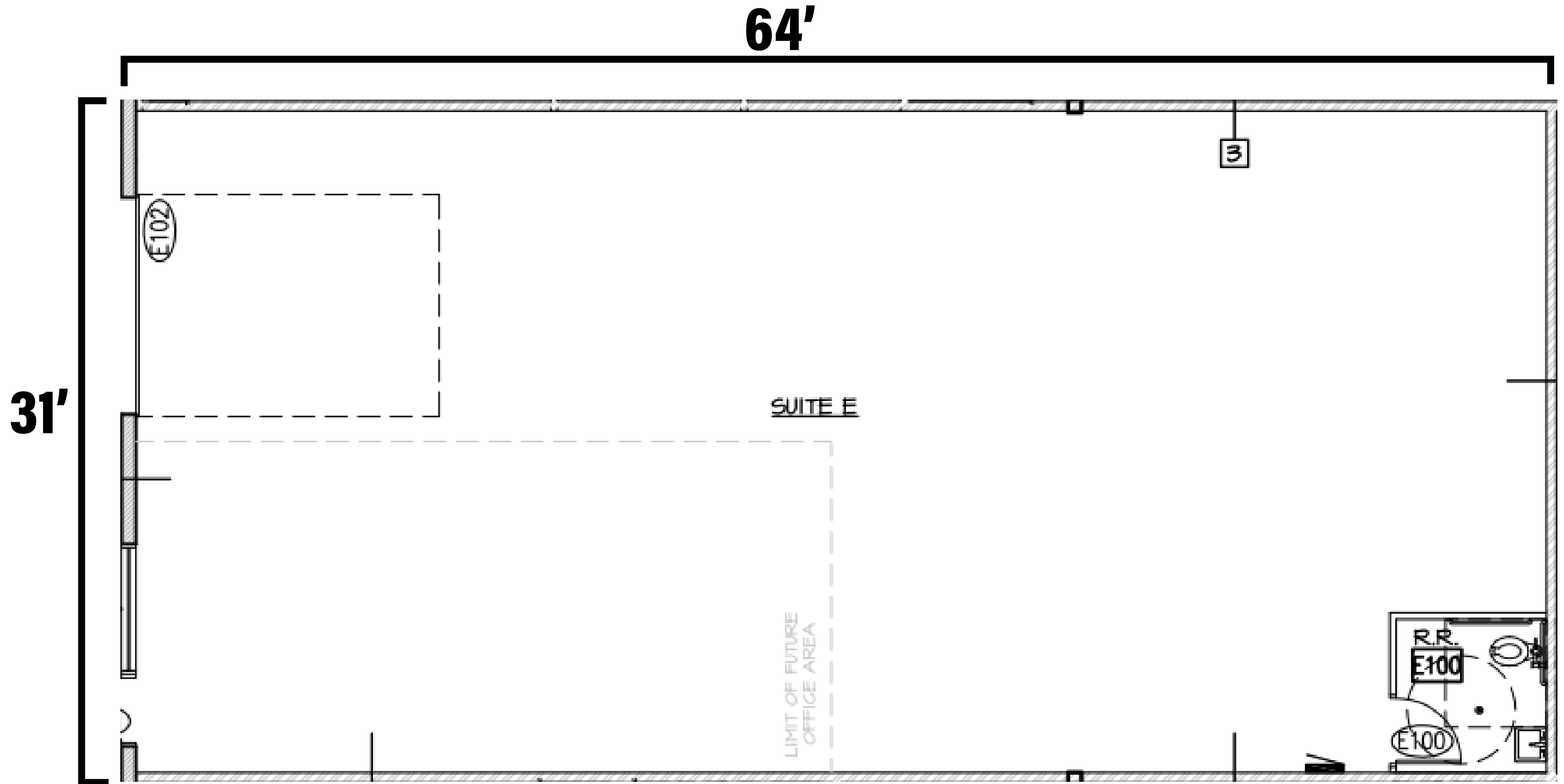

Contact

SKYLER PETERSON, SIOR
Executive Vice President
m 801.656.7354
speterson@legendcommercial.com

TRE BOURDEAUX, SIOR
Vice President
m 801.824.0397
tbourdeaux@legendcommercial.com

PARKER TAGGART
Senior Associate
m 801.928.1815
ptaggart@legendcommercial.com



Contact

SKYLER PETERSON, SIOR
Executive Vice President
m 801.656.7354
speterson@legendcommercial.com

TRE BOURDEAUX, SIOR
Vice President
m 801.824.0397
tbourdeaux@legendcommercial.com

PARKER TAGGART
Senior Associate
m 801.928.1815
ptaggart@legendcommercial.com

