

5255 NORTH EDGEWOOD DRIVE SUITE 300

Provo, UT 84604



OFFICE SUBLEASE | AVAILABLE NOW

Approx. 8,000 - 22,922 RSF

HUGHESMARINO

BUILDING INFORMATION



BUILDING

Riverwoods III

ADDRESS

5255 North Edgewood Drive,
Suite 300

Provo, UT 84604

AVAILABLE

Vacant

ASKING RATE

\$21.50 Full Service

AVAILABLE THROUGH

March 31, 2032

**Shorter terms available*

ADDITIONAL FEATURES

- Underground Parking
- On-Site Property Management

LOCATION HIGHLIGHTS

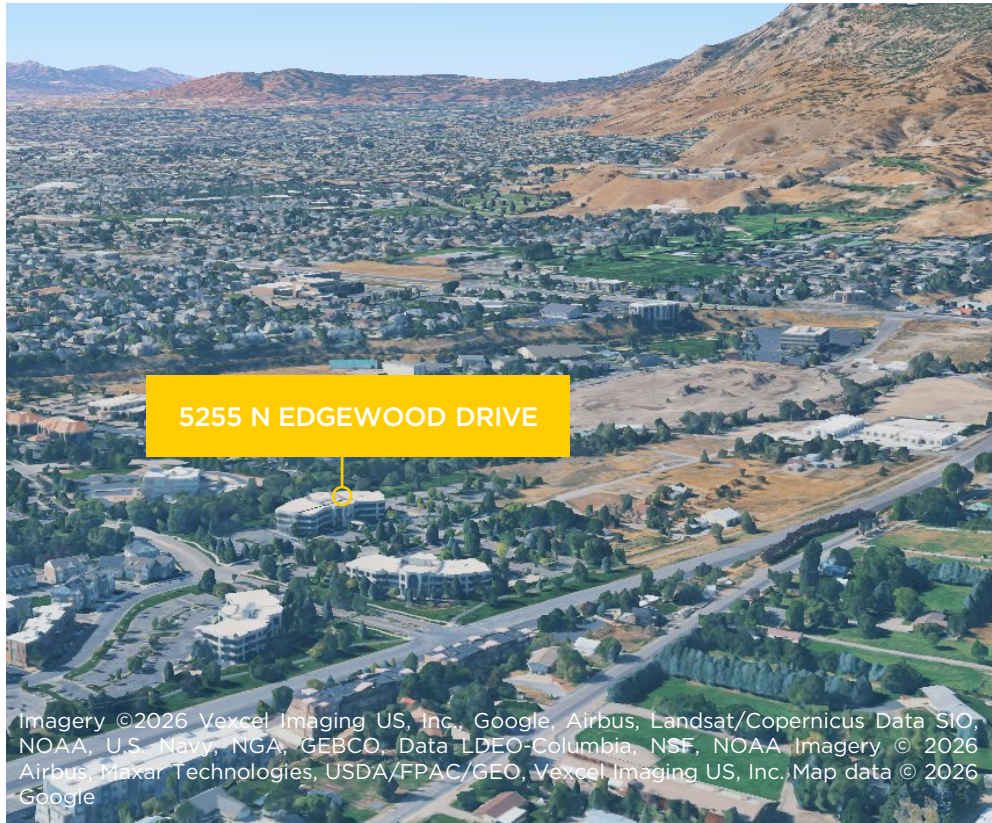

RETAIL & RESTAURANTS



RECREATION



KEY HIGHLIGHTS

- Within walking distance to Shops at Riverwoods
- Near Provo River Walking Trail
- Near Public Transit
- 10 Minutes to I-15
- 21 Minutes to Provo Airport
- 50 Minutes to SLC International Airport

FLOOR PLAN

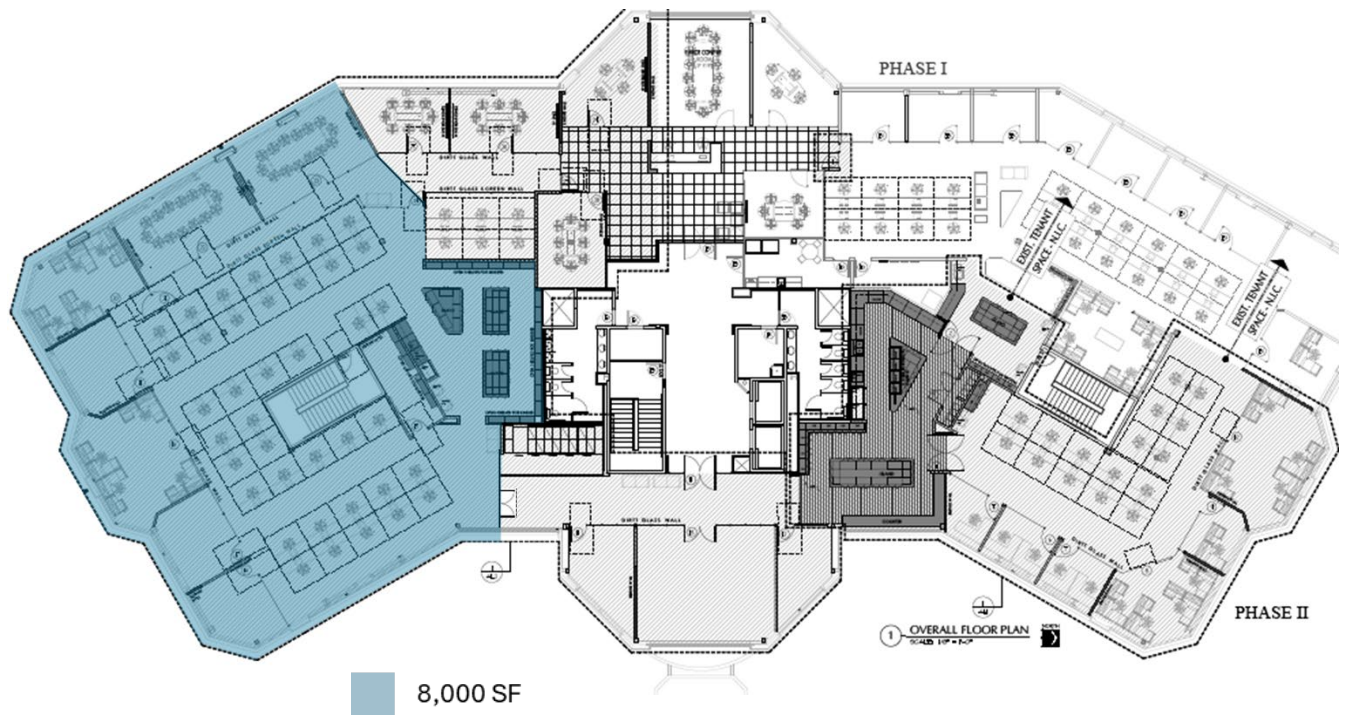

SPACE HIGHLIGHTS

- 22,922 RSF divisible to approx. 8,000 RSF
- Beautifully Furnished
- Private Offices
- Multiple Conference Rooms
- Large Open Workstation Area
- Storage Room
- Unbeatable Mountain Views

5255 NORTH EDGEWOOD DRIVE, SUITE 300



5255 NORTH EDGEWOOD DRIVE, SUITE 300



5255 NORTH EDGEWOOD DRIVE, SUITE 300



5255 NORTH EDGEWOOD DRIVE, SUITE 300



CONTACT INFORMATION



JACOB CURTIS
jacob.curtis@hughesmarino.com
702.394.8989
Lic. #13863395-SA00



LORA MUNSON, CCIM
lora.munson@hughesmarino.com
801.706.5982
Broker Lic. #5468065-PB00

**6985 UNION PARK CENTER, SUITE 650
COTTONWOOD HEIGHTS, UT 84047**
801.981.2111 | hughesmarino.com

HUGHESMARINO
SLC, INC.