

CLIENT
ARI SHULMAN

PROJECT
AS BUILT SITE PLAN

DRAWN BY
YB

ISSUE
09.17.2025

3700 MORSE AVE.
LINCOLNWOOD, IL 60712

SCALE: 1"=30'-0"

LOCATION LEGEND				
#	ROOM	WIDTH x LENGTH	RSF	AVERAGE USABLE HEIGHT
1	VESTIBULE	8x8	79	8'-11 1/2"
2	OFFICE	15x12	194	" "
3	OFFICE	25x12	326	" "
4	CONFERENCE RM	17x16	234	" "
5	OFFICE	11x9	115	" "
6	OFFICE	11x9	115	" "
7	BREAK ROOM	14x28	356	" "
8	CONFERENCE RM	25x16	445	" "
9	OFFICE	12x21	259	" "
10	OFFICE	12x9	124	" "
11	SERVER RM	12x5	71	" "
12	SHARED WORK SPACE	34x65	1,997	" "
13	WAREHOUSE	193x193	27,671	20'-8"
14	STORAGE	16x20	346	20'-8"
15	MECHANICAL RM	26x22	653	
16	OFFICE	11x11	150	
17	WASH RM	11x12	151	
18	OFFICE	11x9	115	
19	BREAK RM	18x24	505	
20	OFFICE	18x9	190	
21	DOCK (x1)	18x61	1,245	
22	DOCK (x2)	28x61	1,918	
23	COOLED STAGING AREA/DOCK (x2)	71x49	3,314	17'-2"
24	FREEZER	31x86	2,968	30'-3"
25	FREEZER	41x86	3,892	29'-4"

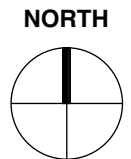
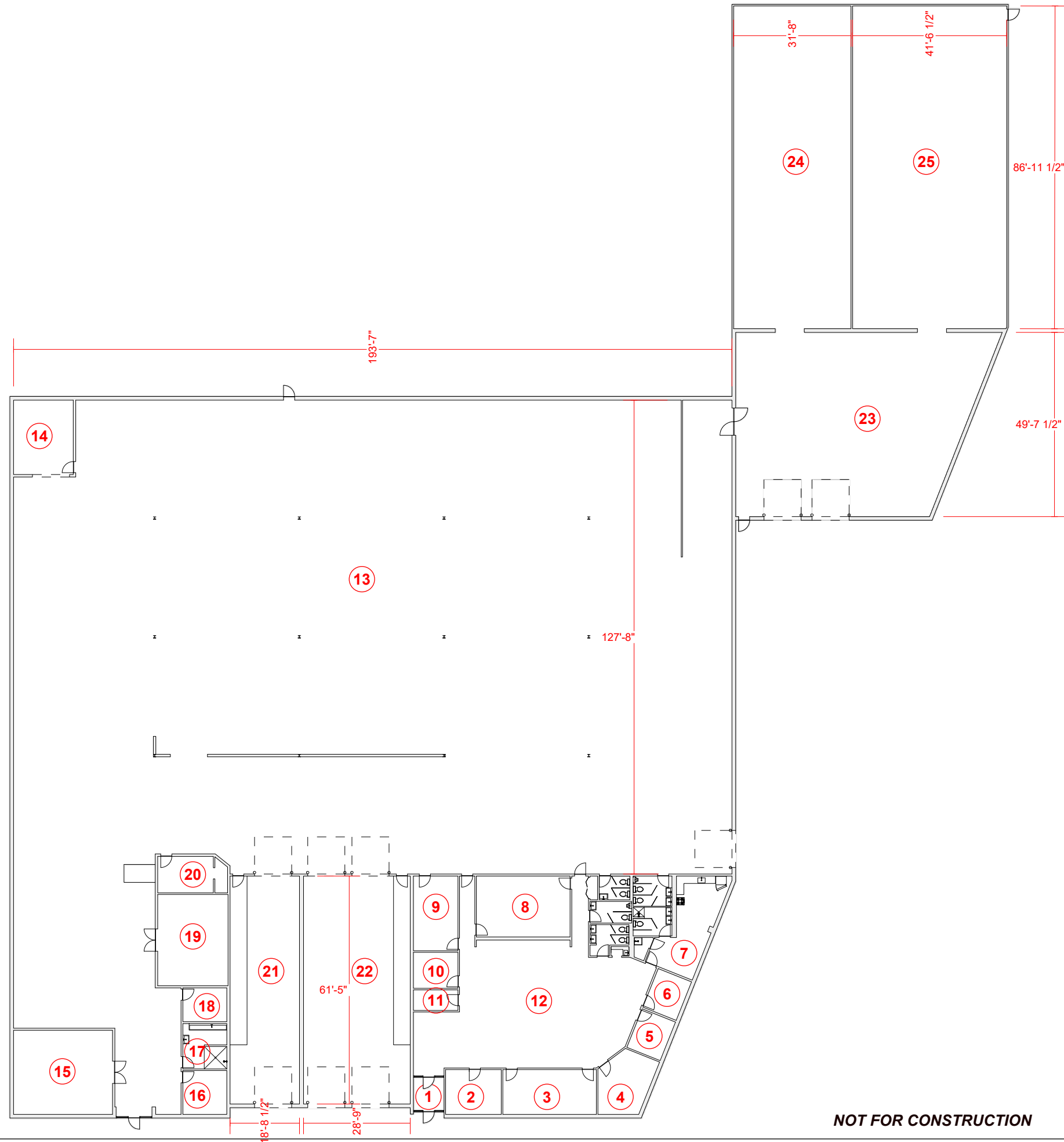

49,332 RSF

NOT FOR CONSTRUCTION



YB Interiors
6111 N. Sacramento Ave.
Chicago, IL 60659

CLIENT
ARI SHULMAN
3700 MORSE AVE.
LINCOLNWOOD, IL 60712

PROJECT
AS BUILT SITE PLAN

ISSUE
09.17.2025
DRAWN BY
YB

SITEPLAN

A.01