



The Offices at



BLUHAWK

1,204 - 17,911 SF

Office/Medical Space for Lease

www.bluhawk.com

Property Overview

Phase One:

8400 W 165th Street - Available Now!

1,204 - 17,911

Office/Medical available for lease

Rate: \$32.00 PSF + \$10.00 NNN

Parking: 4.32/1000 SF



Phase Two:

16501 Antioch Road - Build-to-Suit

16,205 SF Planned

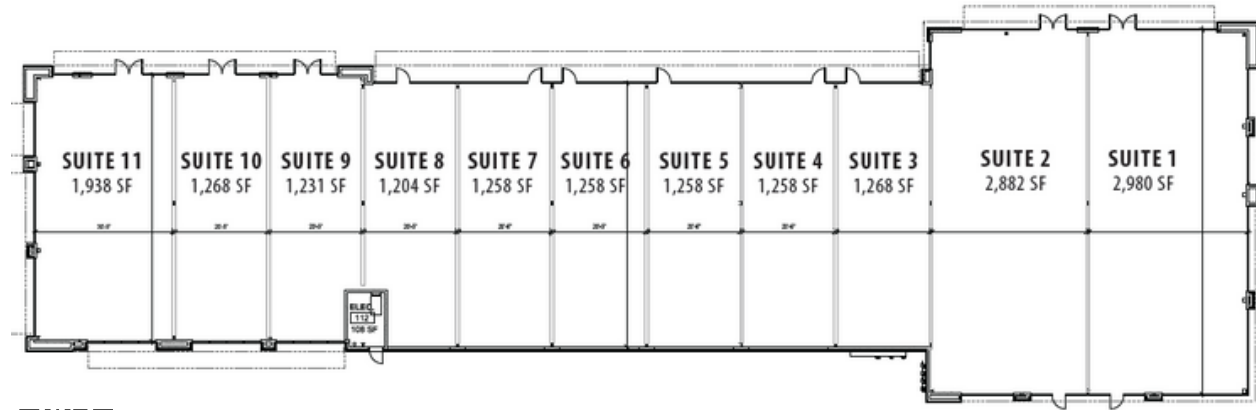

[Make-Ready Virtual Tour Experience](#)

Click here or scan QR code

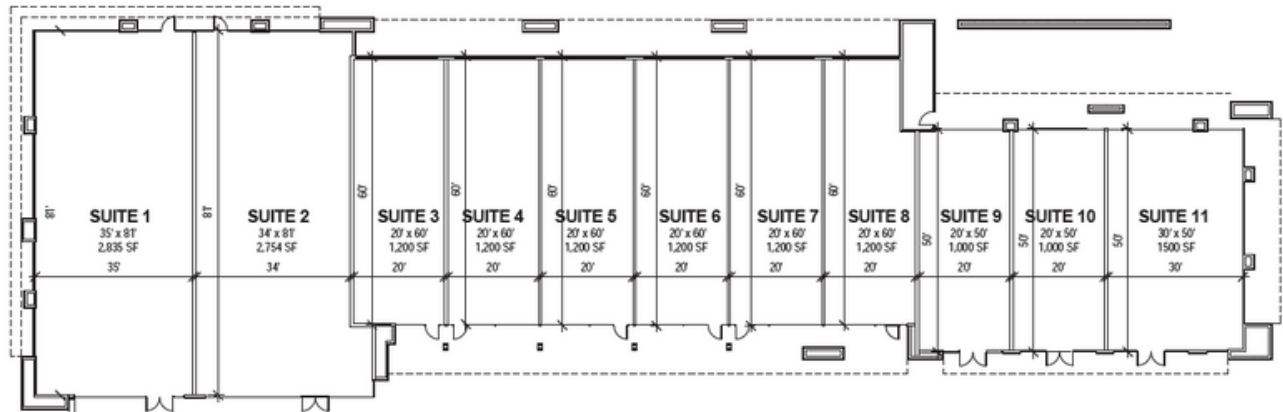

BLUHAWK

Photos



BLUHAWK

Aerial View



RED DOOR
Tropical Smoothie CAFE
Costa Vida
Massage Luxe

159th Street



TJ-maxx



CHASE



Planet Fitness
Aldi
Cookie Co.
TJ Maxx

Highway 69

FIVE GUYS



AdventHealth
Sports Park

AdventHealth
South Overland Park

OVERLAND PARK
KANSAS

Mission
Veterinary
Emergency & Specialty

BLUHAWK
Phase 2: Build-to-Suit
16,205 Planned

The Offices at
BLUHAWK

Antioch Road

W 165th Street



Area Demographics	1 mile	3 miles	5 miles
Estimated population	8,029	55,345	138,233
Estimated households	2,830	18,990	50,401
Est. Average HH income	\$203,795	\$197,208	\$177,096





BLUHAWK

JLL

Patrick Meraz, CCIM

+ 1 913 469 4622

patrick.meraz@jll.com

Jeff Kembel, SIOR

+ 1 913 469 4604

jeff.kembel@jll.com

RJ Trowbridge

+ 1 913 469 4637

rj.trowbridge@jll.com

Although information has been obtained from sources deemed reliable, JLL does not make any guarantees, warranties or representations, express or implied, as to the completeness or accuracy as to the information contained herein. Any projections, opinions, assumptions or estimates used are for example only. There may be differences between projected and actual results, and those differences may be material. JLL does not accept any liability for any loss or damage suffered by any party resulting from reliance on this information. If the recipient of this information has signed a confidentiality agreement with JLL regarding this matter, this information is subject to the terms of that agreement. ©2023 Jones Lang LaSalle Brokerage, Inc. All rights reserved.