

# GRASS VALLEY INDUSTRIAL UNITS AVAILABLE FOR LEASE

GRASS VALLEY, CA



1020 WHISPERING PINES LANE

1050 WHISPERING PINES LANE

**NEWMARK**

**SEAN MAHONEY, SIOR**

916.952.5750

sean.mahoney@nrmk.com

CA RE License #01332661

**KEVIN JASPER, SIOR**

916.826.7276

kevin.jasper@nrmk.com

CA RE License #01164925

# SITE PLAN - 1020 WHISPERING PINES LANE

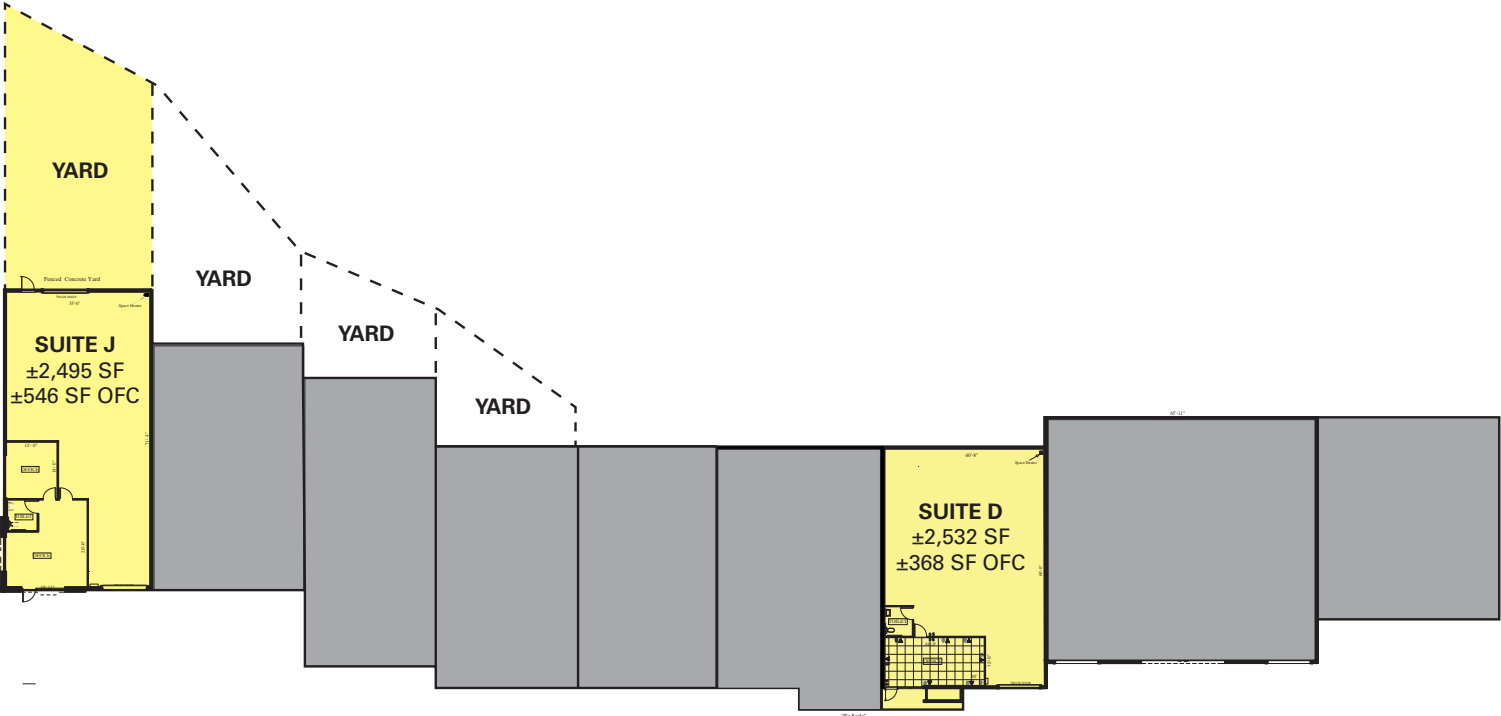

# SITE PLAN - 1050 WHISPERING PINES LANE

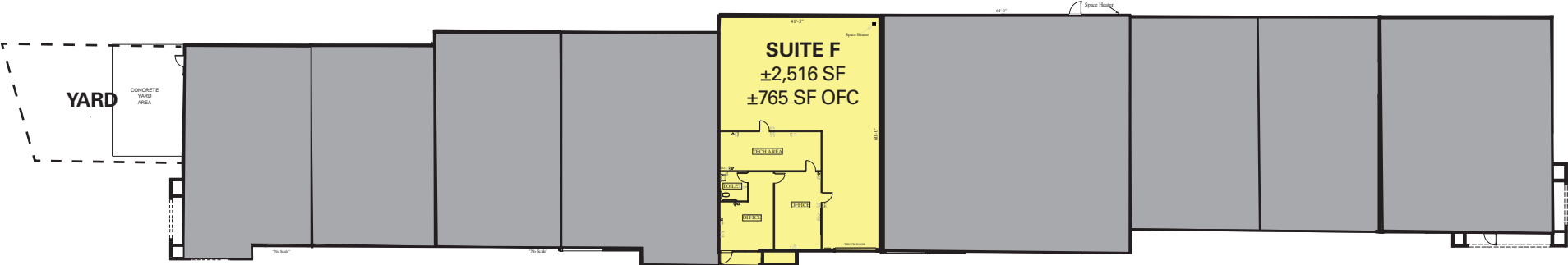

# FLOOR PLANS - 1020 WHISPERING PINES LANE

## 1020 WHISPERING PINES LANE, SUITE D

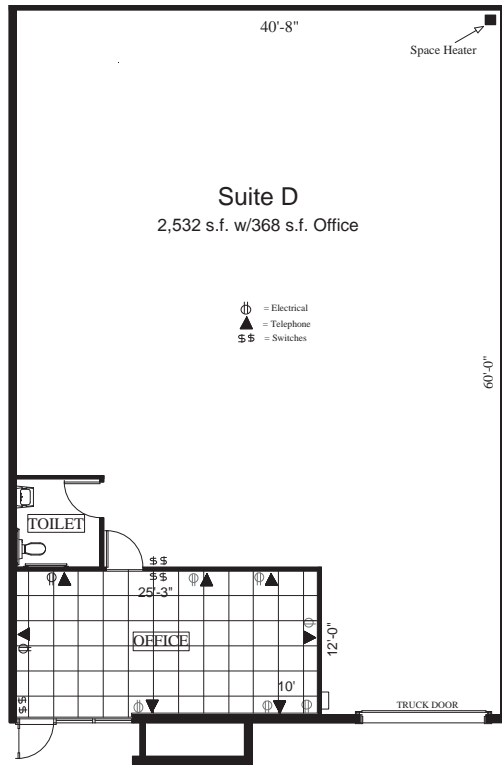

## 1020 WHISPERING PINES LANE, SUITE J

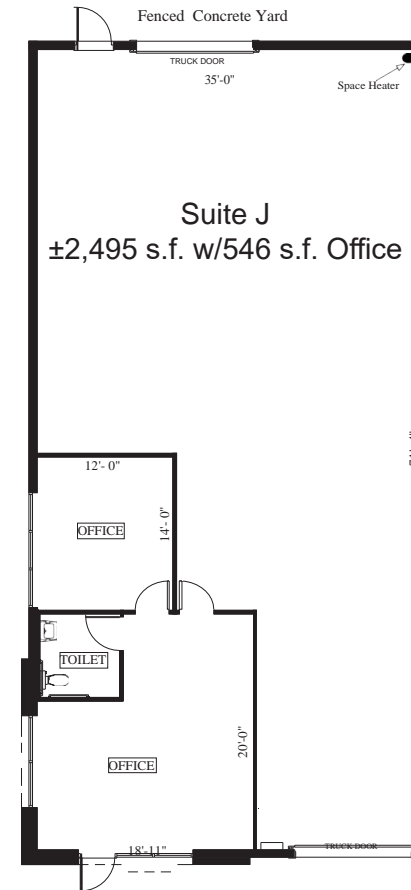

## BUILDING AMENITIES

- ▶ 16' Clear Height
- ▶ One (1) 12' X 12' Grade Level Door per Unit
- ▶ White-Batt Roof Insulation in Warehouse
- ▶ Reznor Gas Heater in Warehouse

- ▶ Skylights
- ▶ Ample Parking
- ▶ Zoned SP-1B, Whispering Pines specific plan
- ▶ Fire Sprinklers

1050 WHISPERING PINES LANE, SUITE F

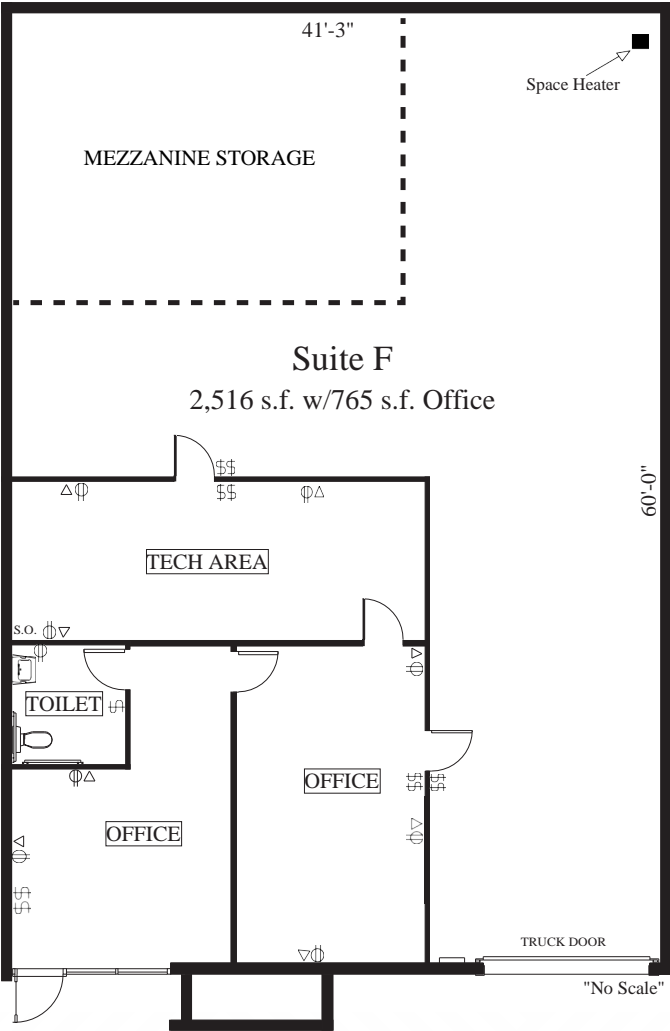

# GRASS VALLEY INDUSTRIAL UNITS AVAILABLE FOR LEASE

GRASS VALLEY, CA



The distributor of this communication is performing acts for which a real estate license is required. The information contained herein has been obtained from sources deemed reliable but has not been verified and no guarantee, warranty or representation, either express or implied, is made with respect to such information. Terms of sale or lease and availability are subject to change or withdrawal without notice. **11/25**

**NEWMARK**

**SEAN MAHONEY, SIOR** | Senior Managing Director | 916.952.5750 | sean.mahoney@nmrk.com | CA RE License #01332661

**KEVIN JASPER, SIOR** | Senior Managing Director | 916.826.7276 | kevin.jasper@nmrk.com | CA RE License #01164925