

Suite 1450

9,401 rsf

suite 1490
1,476 rsf

suite 1450
9,401 rsf

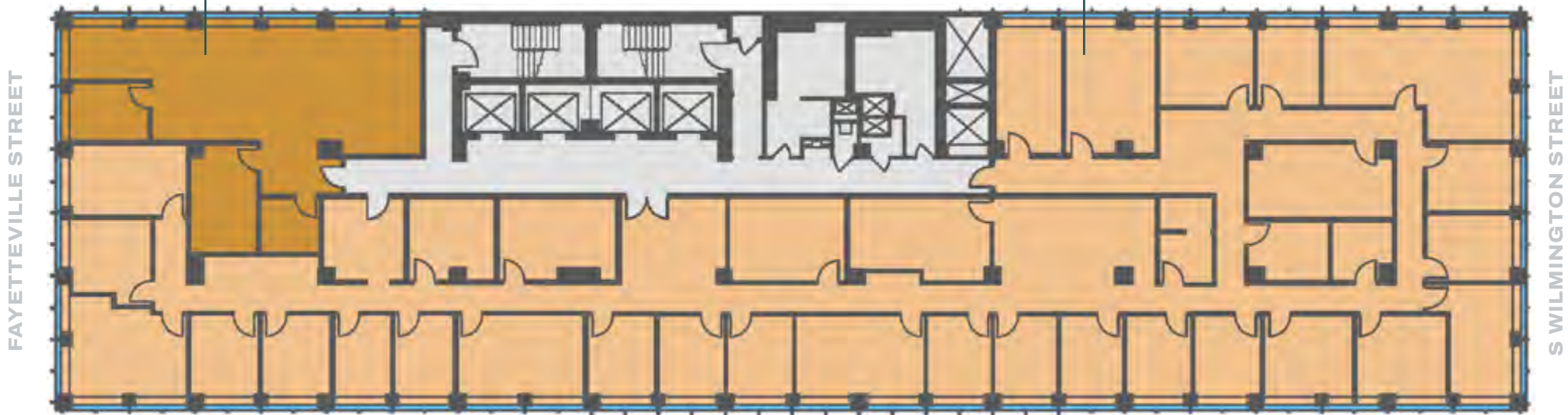

*may be combined with balance of floor for approximately 11,000 rsf full-floor tenant

for lease + details

Garrett Lewis

glewis@trinity-partners.com

919.360.6108

Boss Poe, CCIM

bpoe@trinity-partners.com

919.868.0016

Esther Austin

eaustin@trinity-partners.com

919.618.5484

The information contained herein was obtained from sources believed reliable; however, Trinity Partners makes no guarantees, warranties, or representations as to the completeness or accuracy thereof. The presentation of this property is submitted subject to errors, omissions, changes of price or conditions prior to sale or lease, or withdrawal without notice.

**TRINITY
PARTNERS**