



For Sublease

±25,000 SF Warehouse

Contact us:

Tony Lochhead
Associate Vice President
License #02000345
+1 949 724 5702
tony.lochhead@colliers.com

4331 Schaefer Ave

Chino, California 91710

Property Highlights

- Freestanding 25,000 SF warehouse
- Large private secured yard
- 26' Warehouse Clear height
- Three (3) dock doors
- One (1) dock leveler
- One (1) grade level door
- 41 reserved parking stalls
- .60 GPM / 3,000 Sq Ft sprinkler system
- 400 AMP | 277/480V | 3-phase power
- Five (5) restrooms
- ±2,570 bonus 2nd floor office mezzanine
- Furniture can be included
- Sublease expires 11/30/2030

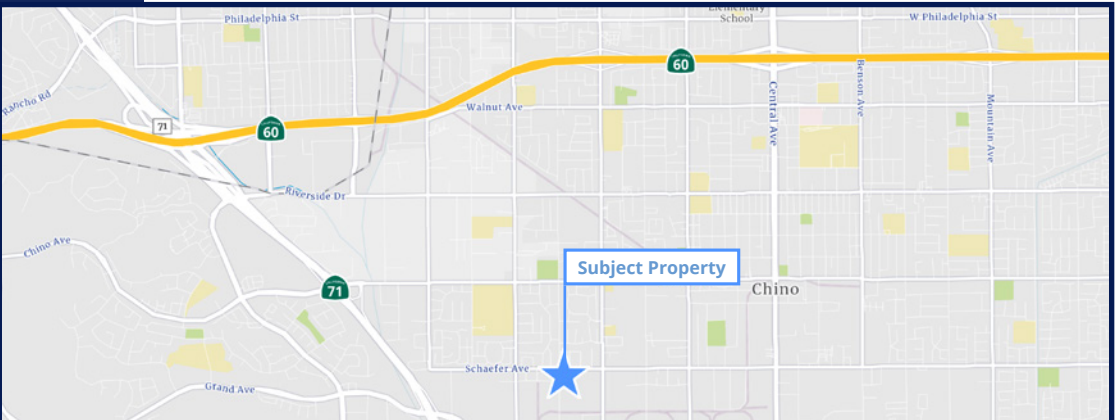

Colliers
3 Park Plaza Suite 1200
Irvine, CA 92614 | USA
www.colliers.com

Copyright © 2026 Colliers. Information herein has been obtained from sources deemed reliable, however its accuracy cannot be guaranteed. User must conduct due diligence and verification.

Accelerating success.

4331 Schaefer Ave

Chino, California

Site Plan

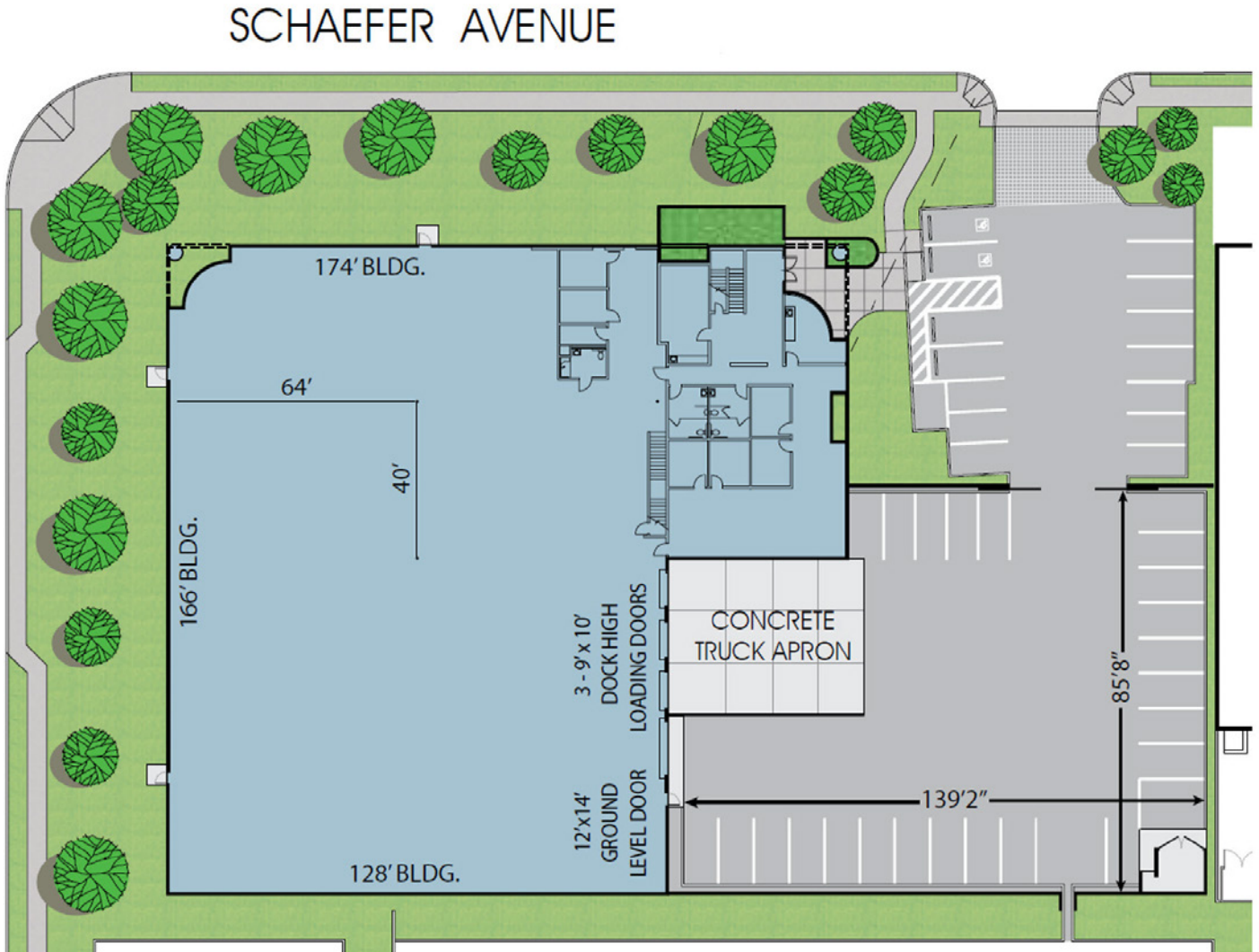

±25,000 SF
Warehouse

4331 Schaefer Ave

Chino, California

