



±4,200 SF



240 S Rock Blvd, Ste 143 Reno, Nevada 89502



Justin W. Noin

justin@mckenzieproperties.com

Phone: (775) 329-5181

Cell: (775) 315-9088

5520 Kietzke Lane #400

Reno, NV 89511

Lic #: B.1002722.CORP

BUILDING INFORMATION

- Fantastic Central Location
- ±4,200 Total SF
- ±1,200 Warehouse
- 2 Drive-in Doors
- Quick access to I-80 & I-580
- Adjacent to Reno Tahoe International Airport
- Flexible Tenant Improvements
- 4 / 1,000 sq parking ratio

Rock Center

Floor Plan

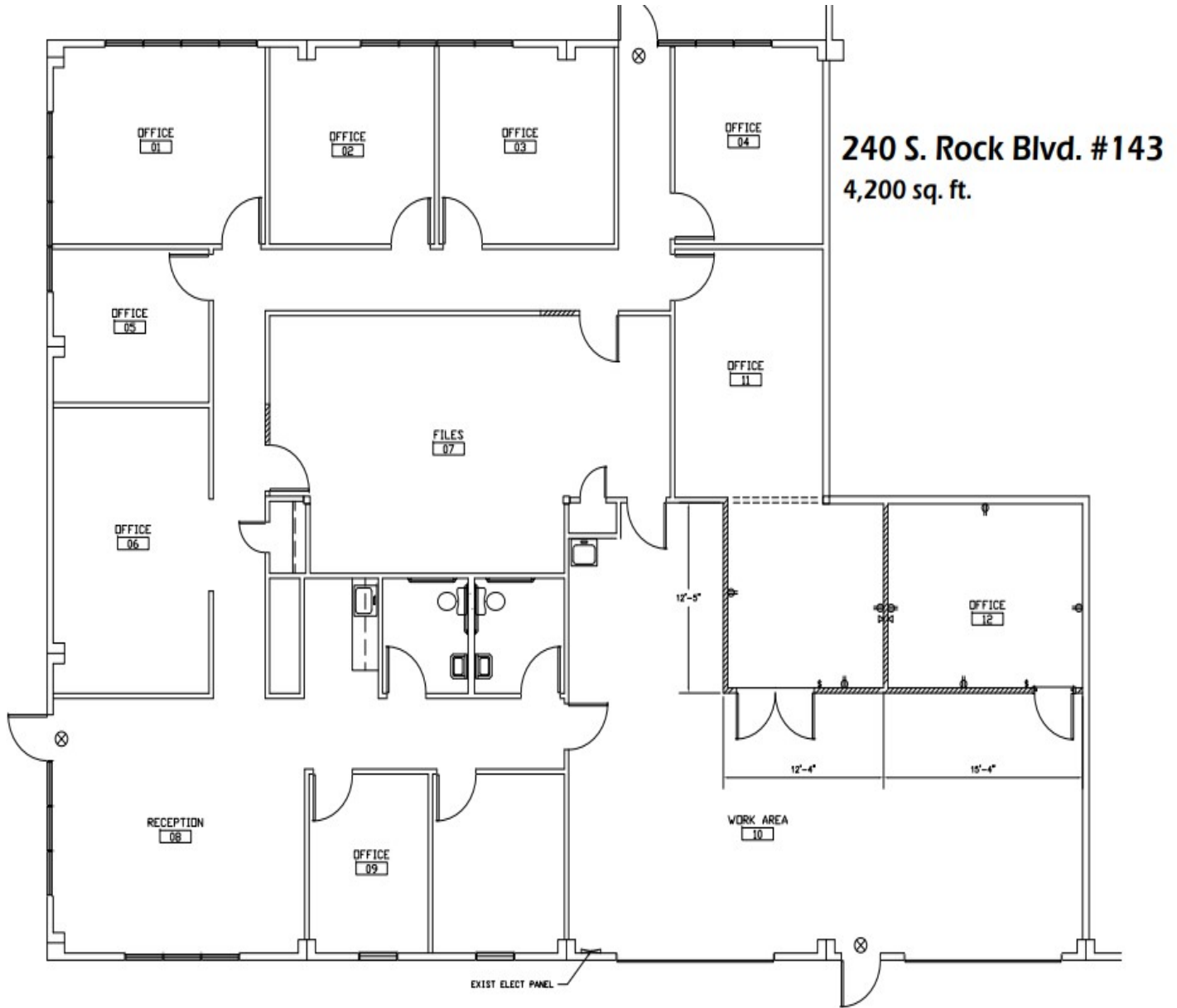



Professional Office Finishes



Justin W. Noin

justin@mckenzieproperties.com

Phone: (775) 329-5181

Cell: (775) 315-9088

5520 Kietzke Lane #400

Reno, NV 89511

Lic #: B.1002722.CORP

Rock Center

Location

240 S Rock Blvd, Ste 143
Reno, Nevada 89502

DRIVE TIMES

<u>Location</u>	<u>Distance</u>	<u>Time</u>
I-80	1.8 Miles	6 Minutes
McCarran Blvd.	1.0 Miles	3 Minutes
I-580	1.4 Miles	5Minutes

