

**21801 Stevens Creek Blvd.**

**Cupertino, CA 95014**

**For Lease**



**COLDWELL BANKER  
COMMERCIAL  
REALTY**



## **Property Overview**

Two-story office building located at the corner of Stevens Creek Blvd. & Mann Dr. Easily accessible from either Foothill Blvd or Highway 85 direction onto Stevens Creek. Access to two parking lots for a total of 30 shared parking spaces. Open to all city approved businesses for the zoning of the building. Non-educational uses preferred. Contact agent with questions or to tour.

## **Details**

Available Rentable SF: ~ 465 sqft. in suite #202

Asking Price: \$3.75 sqft/month full service

Features: Owner requires minimum 2 year lease  
Suite #202 will be available July 1, 2026

### **FOR MORE DETAILS CONTACT:**

**Huei-Saint Shwe | [huei-saint.shwe@cbcrrt.com](mailto:huei-saint.shwe@cbcrrt.com) | CalBRE: 01397036**

**Coldwell Banker Commercial NRT**

**CBCWorldwide.com**

**19330 Stevens Creek Blvd Cupertino, CA 95014**

**C: 408.857.2541 F: 408.252.0538 O: 408.252.1133**

©2023 Coldwell Banker. All Rights Reserved. Coldwell Banker and the Coldwell Banker logo are trademarks of Coldwell Banker Real Estate LLC. The Coldwell Banker® System is comprised of company owned offices which are owned by a subsidiary of Anywhere Advisors LLC and franchised offices which are independently owned and operated. The Coldwell Banker System fully supports the principles of the Fair Housing Act and the Equal Opportunity Act. CalRE #01908304

**21580 Stevens Creek Blvd.**

**Cupertino, CA 95014**

**For Lease**



**COLDWELL BANKER  
COMMERCIAL  
REALTY**



**Close Proximity to :**

Whole Foods Market.....0.8 Miles	Deep Cliff Gold Course..... 1.6 Miles	Apple Park (Campus 2).....4.7 Miles	San Jose Airport.....12.2 Miles
Monta Vista High.....0.9 Miles	Main St. Cupertino.....2.4 Miles	Valley Fair/Santana Row.....7.6 Miles	Meta (Facebook).....14.1 Miles
Target Shopping Center.....1.0 Miles	Apple Infinite Loop..... 2.9 Miles	Google.....7.9 Miles	*All Approx. Distances

**21801 Stevens Creek Blvd.**

**For Lease**



**COLDWELL BANKER  
COMMERCIAL  
REALTY**

**Cupertino, CA 95014**



\*Not drawn to scale

**21801 Stevens Creek Blvd.**

**For Lease**



**COLDWELL BANKER  
COMMERCIAL  
REALTY**

**Cupertino, CA 95014**

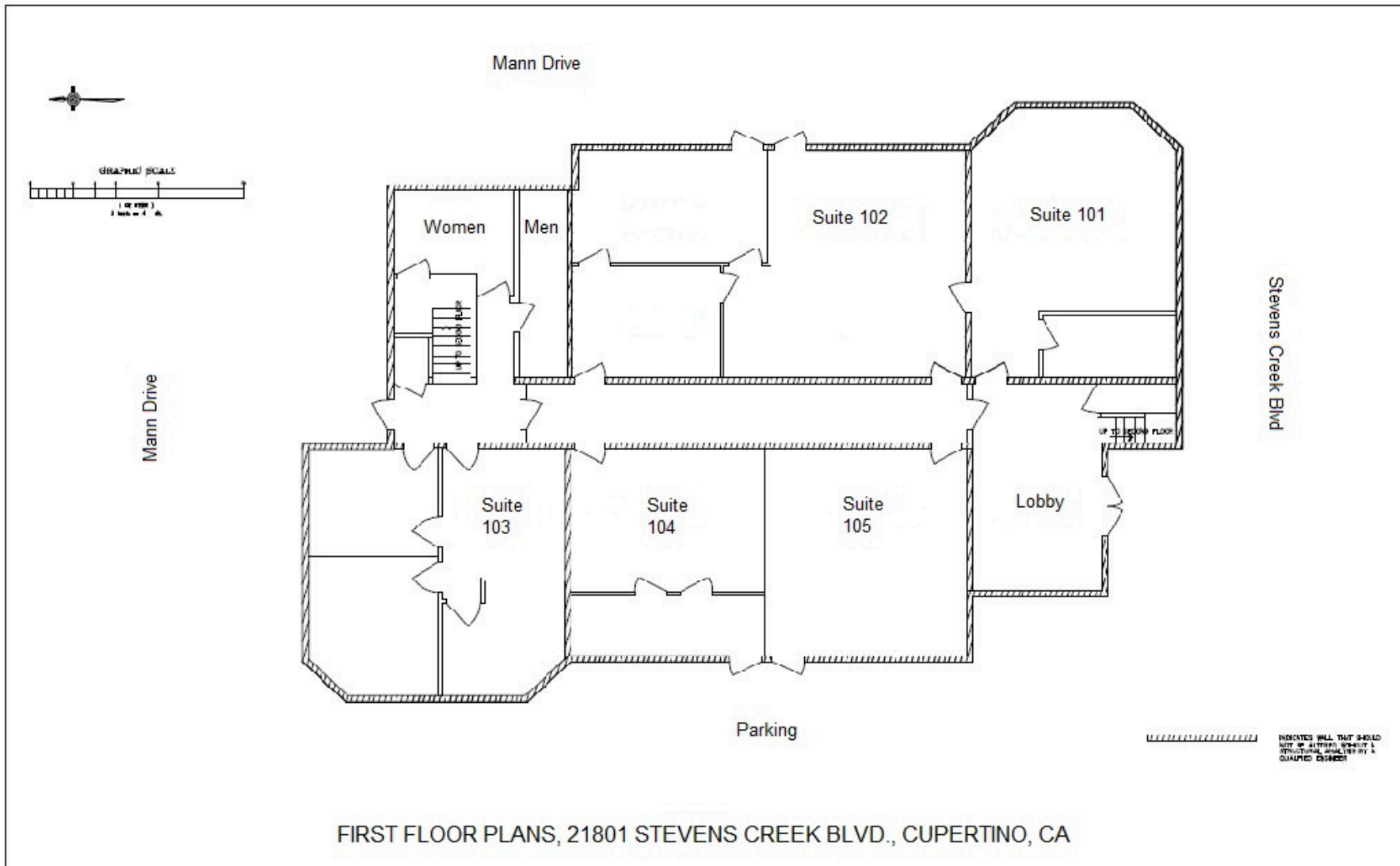

\*Not drawn to scale