

BANK OF HAWAII WAIKIKI CENTER

2155 KALAKAUA AVE SUITE 400 |
HONOLULU, HI 96815

THE OPPORTUNITY

This sublease opportunity is a turn-key, fully furnished Class A office space in the heart of Waikiki. The space is located within Bank of Hawaii Waikiki Center, which is situated at the prime location of Kalakaua Avenue and Beach Walk. The Building features on-site parking, 24/7 security and a high-tech infrastructure.

SUBLEASE SPACE HIGHLIGHTS:

- Large conference room with 14 person table and presentation screen
- Peaceful tree top views of Kalakaua and Beach Walk in Waikiki
- Recently installed Furniture, Fixtures and Equipment throughout
- Long term sublease opportunity through December 31, 2027
- Lobby presence with glass entry



SERENA C. LONGO

Vice President

+1 808 541 5181

serena.longo@cbre.com

Lic. RS-74888

© 2021 CBRE, Inc. All rights reserved. This information has been obtained from sources believed reliable, but has not been verified for accuracy or completeness. You should conduct a careful, independent investigation of the property and verify all information. Any reliance on this information is solely at your own risk. CBRE and the CBRE logo are service marks of CBRE, Inc. All other marks displayed on this document are the property of their respective owners, and the use of such logos does not imply any affiliation with or endorsement of CBRE. Photos herein are the property of their respective owners. Use of these images without the express written consent of the owner is prohibited.

SL:HiCS_OF81 2155 Kalakaua Ave Suite 400 Sub_01.19.21

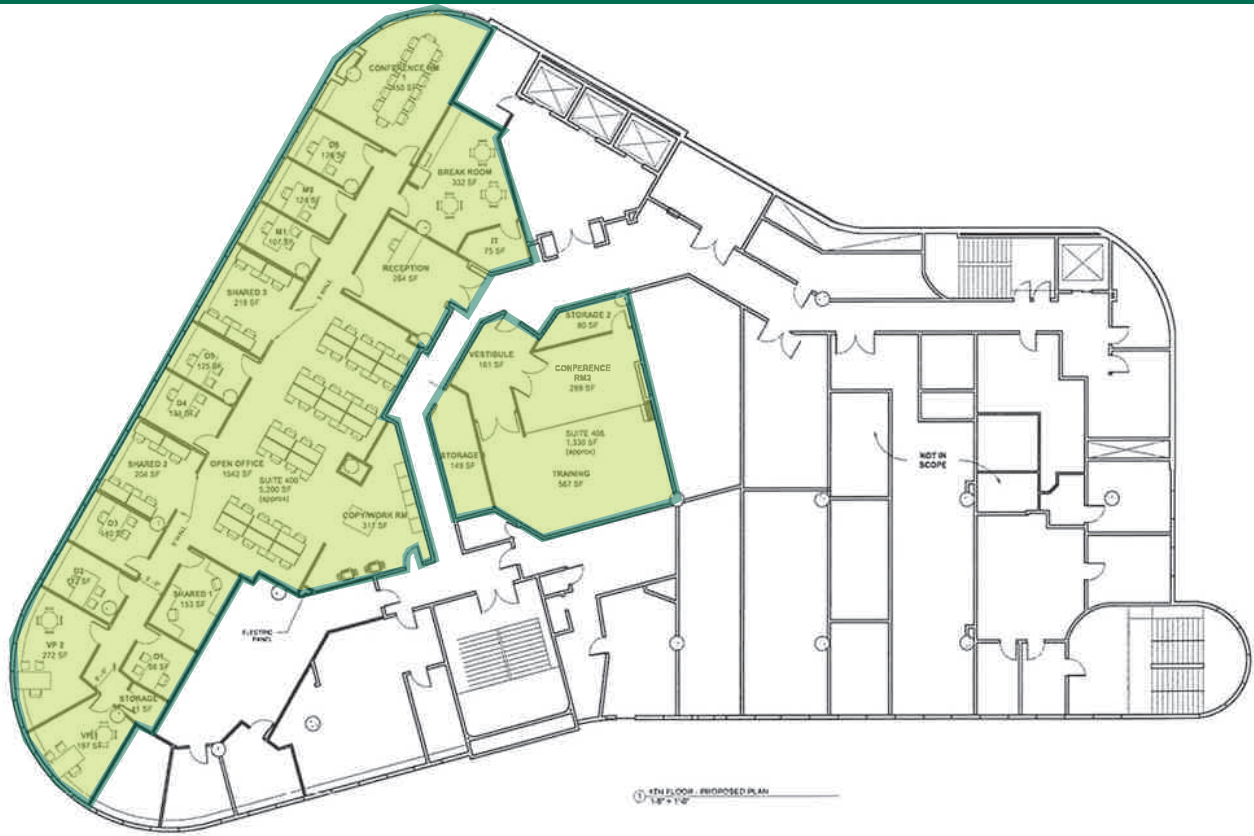

PROPERTY DETAILS	
Size:	7,417 SF
Base Rent:	Negotiable
2020 OPEX:	\$2.10/RSF/month
Sublease Expiration:	12/31/2027
Parking:	11 Unreserved Stalls

