



120,623 SF AVAILABLE

1370 AVIATION

HEBRON, KY 41048

CLASS A MODERN BULK

LEASE RATE: NEGOTIABLE

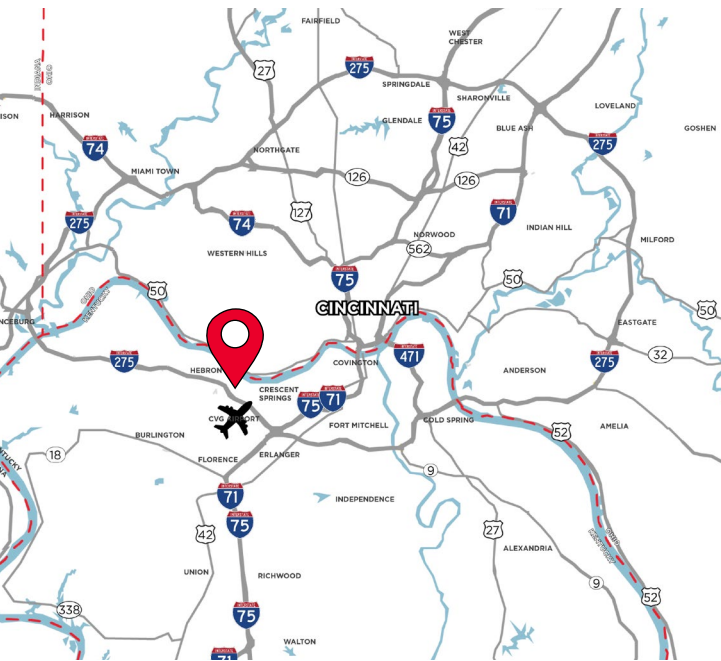

PROPERTY HIGHLIGHTS

- Multiple Suites Available!
- **Suite 200:** 67,514 SF Available
- **Suite 100:** 53,109 SF Available
- 32' Clear Height
- LED Lighting
- (14) 9'x10' Dock Doors Fully Equipped
- (1) Drive-in Door
- Easy access to I-275 & I-75/71
- Close proximity to Cincinnati/N. Kentucky International Airport, DHL SuperCargo and Amazon Prime Air Hubs

For more information, contact:

Jeff Bender, SIOR, CCIM
Executive Vice Chair
+1 513 763 3046
jeff.bender@cushwake.com

Seattle Stein
Director
+1 513 763 3027
seattle.stein@cushwake.com

201 E. Fourth Street, Suite 1800
Cincinnati, OH 45202
P: +1 513 421 4884
cushmanwakefield.com

FOR LEASE

1370 AVIATION BLVD

HEBRON, KY 41048

BUILDING SPECIFICATIONS

LOCATION	Hebron, KY (Boone County)
TOTAL SIZE	160,984 SF
AVAILABLE SIZES	Suite 200: 67,514 SF Suite 100: 53,109 SF
OFFICE SIZE	Suite 200: 1,387 SF Suite 100: 3,950 SF
ACRES	11.46 Acres
YEAR BUILT	2019
CONSTRUCTION	Tilt-up concrete
CLEAR HEIGHT	32'
FLOORS	7" unreinforced concrete
PARKING	135 Spaces (Total Building)
ZONING	I-1, Light Industrial
LIGHTING	LED

LEASE RATE: Negotiable + \$1.85 SF OPEX

DOORS	Suite 200: (10) 9'x10' fully equipped dock doors w/ mechanical pit levelers & seals; (9) knock outs Suite 100: (4) 9'x10' fully equipped dock doors w/ mechanical pit levelers & seals; (6) knock outs (1) Drive-in Door
FIRE PROTECTION	ESFR
ROOF	Single-ply, 45 mil white TPO
ELECTRIC	2,000 amp, 277/480 volt, 3 phase
HVAC	Gas-fired 80/20 MAU's
ELECTRIC/GAS	www.owenelectric.com www.duke-energy.com
WATER	www.nkywater.org
SEWER	www.sd1.org
TELEPHONE	www.altafiber.com
DATA	www.spectrum.com



FOR LEASE
1370 AVIATION BLVD
 HEBRON, KY 41048

BUILDING PHOTO

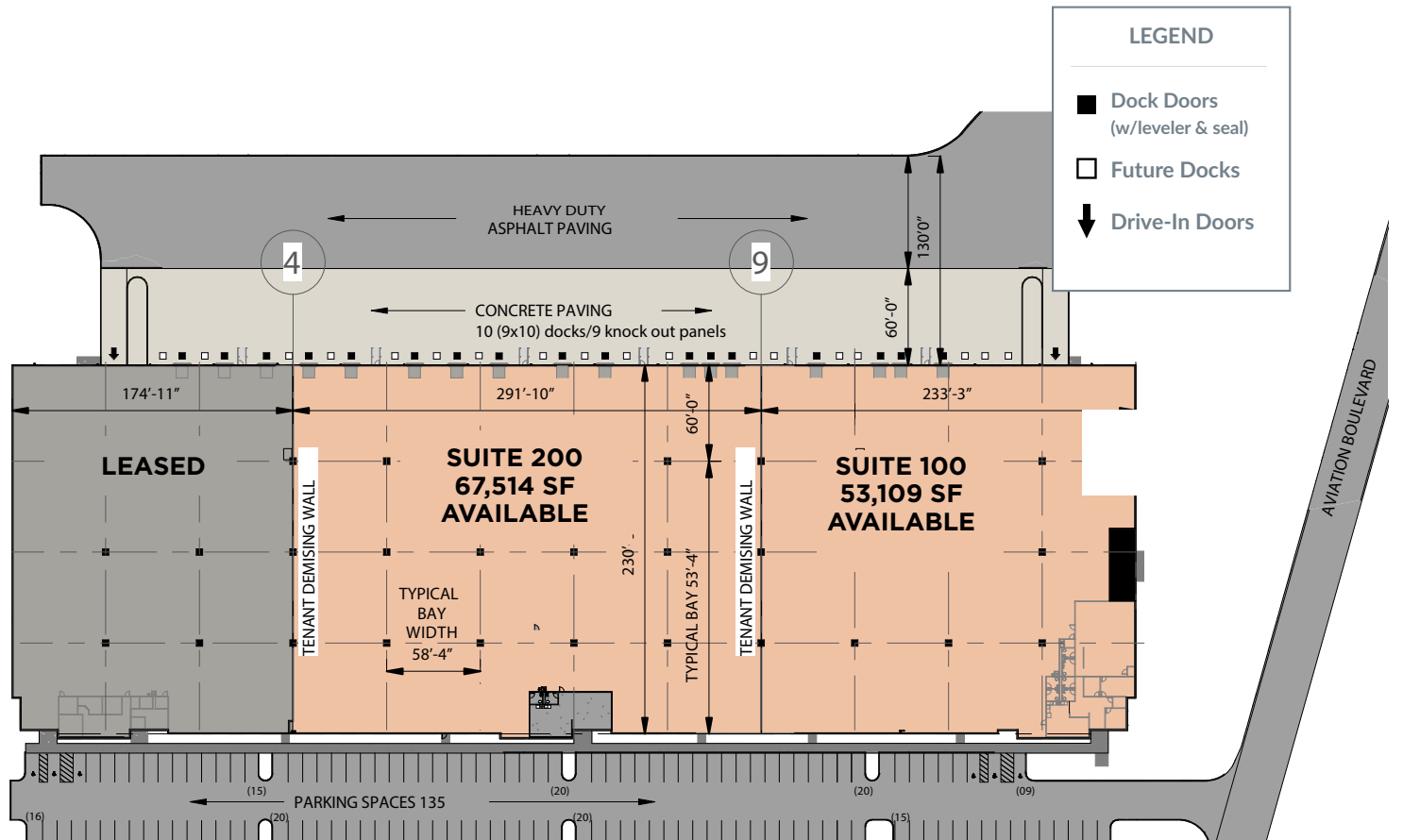

FOR LEASE
1370 AVIATION BLVD
HEBRON, KY 41048



BUILDING PHOTOS



FOR LEASE
1370 AVIATION BLVD
HEBRON, KY 41048

AERIAL



For more information, contact:

Jeff Bender, SIOR, CCIM
Executive Vice Chair
+1 513 763 3046
jeff.bender@cushwake.com

Seattle Stein
Director
+1 513 763 3027
seattle.stein@cushwake.com

201 E. Fourth Street, Suite 1800
Cincinnati, OH 45202
P: +1 513 421 4884
cushmanwakefield.com