

# OLYMPIC MILLS

107 SE WASHINGTON ST. PORTLAND, OR 97214



CREATIVE SPACE FOR LEASE

214 - 8,982 SF  
**OFFICE**  
407 - 1,680 SF  
**RETAIL**

OFFICE, MAKER, & STUDIO SPACES

GROUND-FLOOR RETAIL  
OPPORTUNITIES

HISTORIC CREATIVE BUILDING  
CENTRAL EASTSIDE PDX

MOVE-IN READY  
SPACES AVAILABLE



04.13.2026

**NICHOLAS G. DIAMOND**

Principal Broker | 503-222-2655  
ndiamond@capacitycommercial.com

**MICHELLE D. ROZAKIS**

Principal | 503-222-1195  
mrozakis@capacitycommercial.com

**RILEY M. HENDERSON**

Senior Vice President | 503-975-9301  
riley@capacitycommercial.com

Brokers Have an Ownership Interest in the Property Herein Represented

©2025 Capacity Commercial Group LLC • 805 SW Broadway #600, Portland OR • 503.326.9000 • capacitycommercial.com

VIEW ONLINE





A historic property

# REIMAGINED

Fully updated to modern mechanical, structural, and technological standards, **Olympic Mills** features original beams, finishes, and re-milled hardwoods. A full range of amenities, including on-site parking, a fitness center, building-wide WiFi, conference rooms, communal meeting areas, and a rooftop patio, round out its best-in-class features.

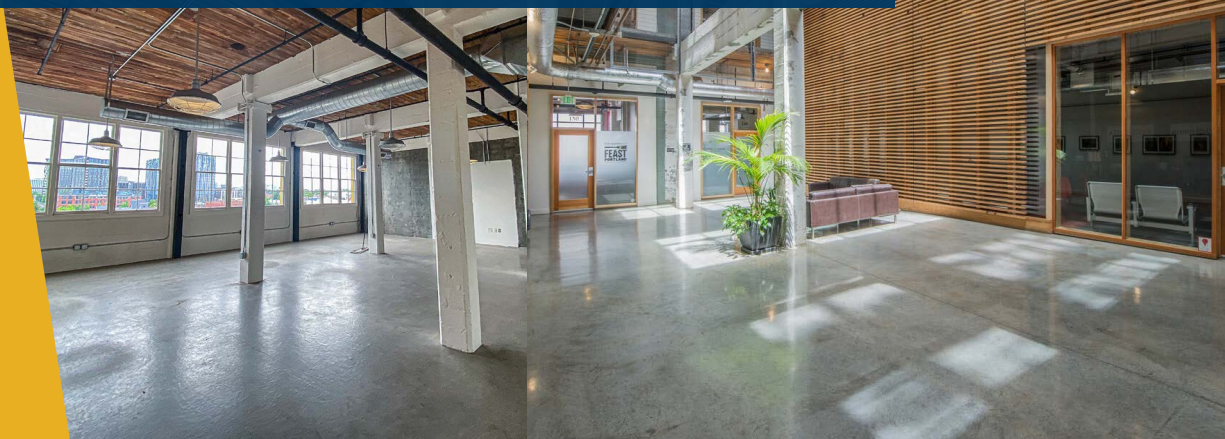

OLYMPIC MILLS

## AMENITIES



**ON-SITE PARKING**  
in Underground Garage



**NEAR STREETCAR**  
Two Blocks to the A Loop



**BICYCLE STORAGE**  
in Secure Facility



**GYM & SHOWERS**  
with Full Locker Rooms



**COMMON AREAS**  
Fully Furnished



**CONFERENCE ROOMS**  
Shared Between Tenants



**ROOFTOP PATIO**  
with Downtown Views



**COMMON AREA WiFi**  
Free for Building Tenants



**ON-SITE RESTAURANT**  
(Olympia Provisions)



**SHARED KITCHEN**  
Fully Equipped



**ON-SITE MGMT.**  
Low-Stress Tenancy



**INCUBATOR SPACE**  
Ready for Growth

# Creative Office / Tech / Studio Space

# ADAPTABILITY

Discover dynamic private suites tailored to suit businesses of all sizes. Offerings spanning seven floors and featuring both interior and exterior-facing office and studio spaces are move-in-ready. At **Olympic Mills**, you'll easily find the ideal layout to foster your evolving business needs.

- Construction 1920; Renovation 2008
- Polished Concrete Floors
- Exposed 14'-16' Ceilings
- Abundant Natural Light
- Cityscape Views
- Secure Bike Parking
- Affordable On-site Storage
- Revamped HVAC Systems
- Customizable Suite Layouts
- Easy Access to Major Freeways & Portland Streetcar



## FEATURED OFFICE INTERIORS

## OLYMPIC MILLS

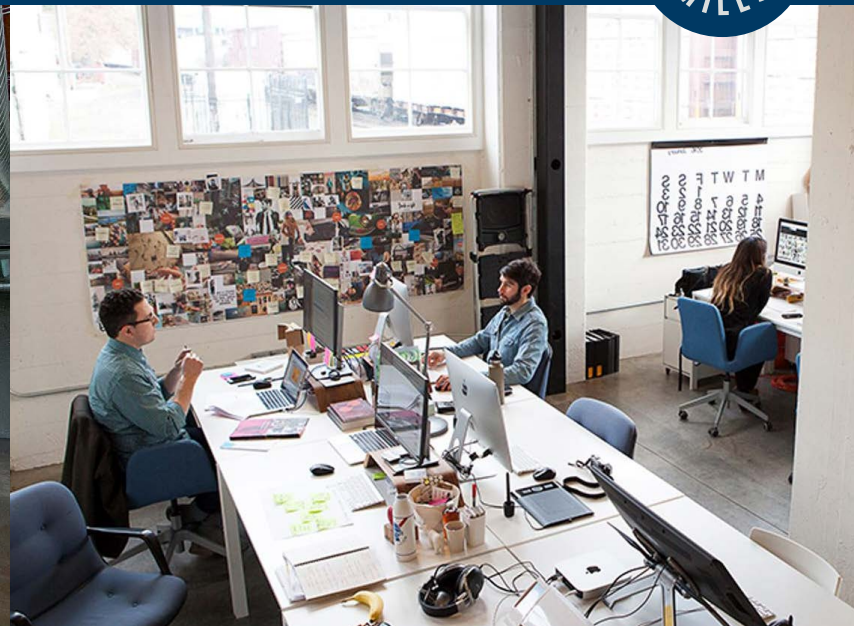

## FEATURED TENANTS





WAYFINDER BEER

PRODUCE ROW CAFE

1-2 BLOCKS AWAY

A vibrant and bustling

# NEIGHBORHOOD

*Well-preserved historic buildings are nestled between modern multi-story developments, and area residents and workers enjoy easy access to public transit and freeways.*

**The Central Eastside Industrial District (CEID)** is an emerging hotspot for innovation and is one of the most unique districts in the country, housing office, flex, and industrial jobs while enjoying close proximity to the city core, the natural beauty of the Eastbank Esplanade, and everything Portland has to offer.

**The CEID** extends north to I-84, south to Powell Blvd., and from east to west between the Willamette Riverfront and SE 12th Ave. It is one of 3 enhanced service districts in Portland, where property owners fund enhanced services such as trash cleanup, graffiti removal and business development.



ON-SITE ADJACENT

OLYMPIA PROVISIONS (AT OLYMPIC MILLS)

SMITH TEAMAKER



Neighborhood

# HIGHLIGHTS



EASTBANK ESPLANADE



INTERSTATE 5

MORRISON BRIDGE



WAYFINDER BEER

SE PINE ST

OFFICE DEPOT

MILLER PAINT

PRODUCE ROW CAFE

SE OAK ST

SHERIDAN FRUIT CO.

LA VICTORIA

PICA PICA GRILL

OLYMPIC MILLS

SE 2ND AVE

SE 3RD AVE

SE STARK ST

HOTEL GRAND STARK

WESTWARD WHISKEY

W.C. WINKS HARDWARE

MY FATHER'S PLACE

OLYMPIA PROVISIONS

SE WASHINGTON ST

RINELLA PRODUCE

SLOW BAR

SMITH TEAMAKER

THE FRIED ONION

SHELL

NW SELF STORAGE

SE ALDER ST

PDX NIGHT MARKET

SWAN DIVE BAR

SE MORRISON ST

ROSE CITY SELF STOR.

CITY LIQUIDATORS

SE BELMONT ST

SE BELMONT ST

LABYRINTH FORGE BREWING

GRAPE APE BAR



# OLYMPIC MILLS

107 SE WASHINGTON ST.

## OPPORTUNITIES FOR LEASE

06/01/2026



# OLYMPIC MILLS

107 SE WASHINGTON ST.

## OPPORTUNITIES FOR LEASE

06/01/2026

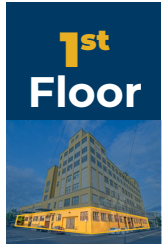

### 1st Floor

OLYMPIC MILLS SQUARE FOOTAGE		
Suite Number	Sq. Ft.	Max. Combined
133 (Retail)	857	
136	1,074	
137	970	
143	581	

OLYMPIC MILLS SQUARE FOOTAGE		
Suite Number	Sq. Ft.	Max. Combined
158	996	
160	961	

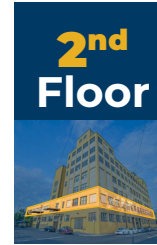
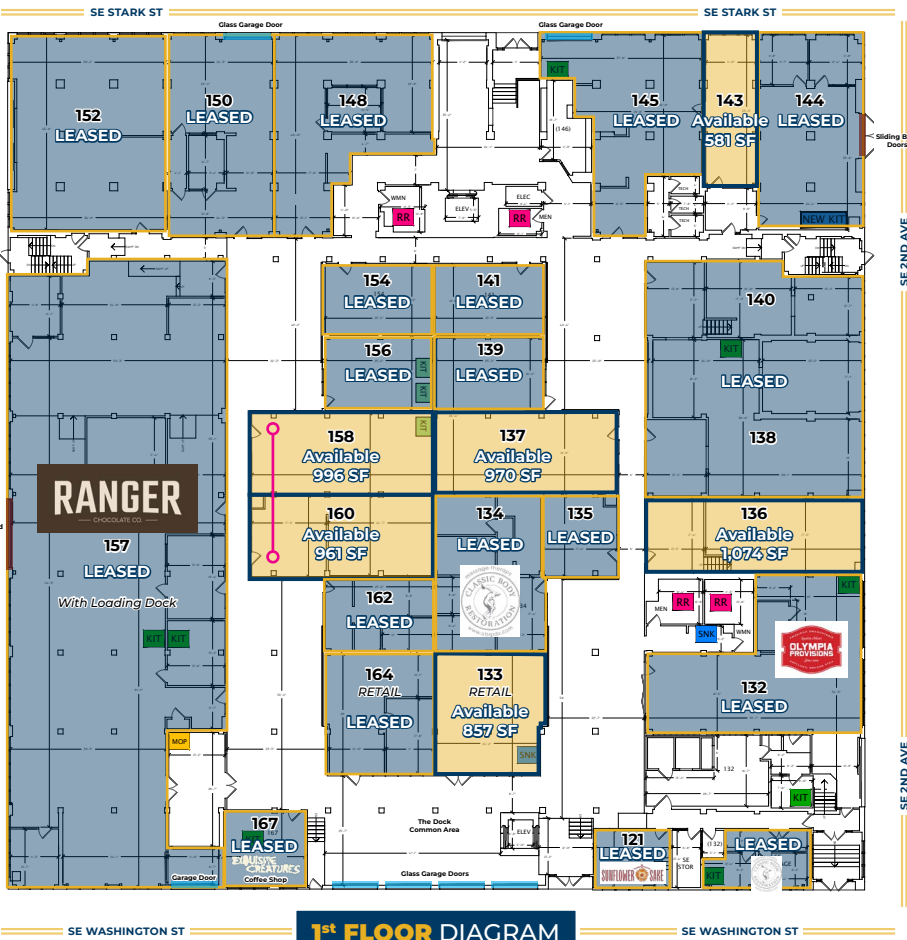

### 2nd Floor

OLYMPIC MILLS SQUARE FOOTAGE		
Suite Number	Sq. Ft.	Max. Combined
210	1,457	
245	2,220	10,677
226	688	
233	977	

OLYMPIC MILLS SQUARE FOOTAGE		
Suite Number	Sq. Ft.	Max. Combined
240	1,064	
249	1,254	

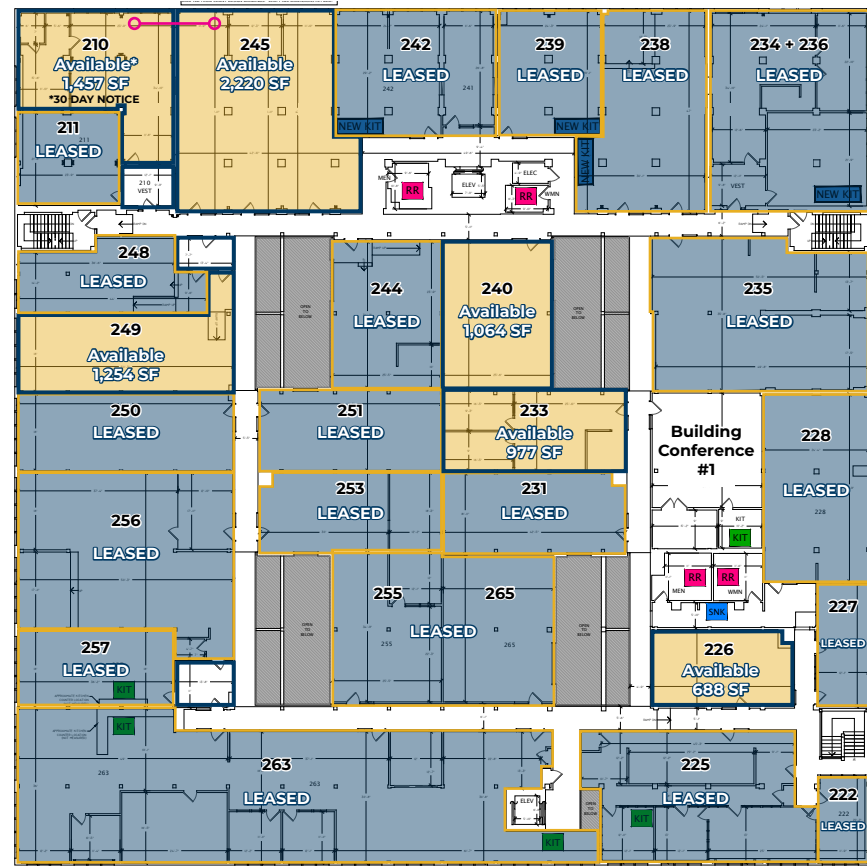

**NICHOLAS G. DIAMOND**  
Principal Broker | 503-222-2655  
ndiamond@capacitycommercial.com

**MICHELLE D. ROZAKIS**  
Principal | 503-222-1195  
mrozakis@capacitycommercial.com

**RILEY M. HENDERSON**  
Sr. Vice President | 503-975-9301  
riley@capacitycommercial.com

Brokers Have an Ownership Interest in the Property Herein Represented  
©2025 Capacity Commercial Group LLC | 805 SW Broadway #600, Portland OR | 503.326.9000 | capacitycommercial.com



**NICHOLAS G. DIAMOND**  
Principal Broker | 503-222-2655  
ndiamond@capacitycommercial.com

**MICHELLE D. ROZAKIS**  
Principal | 503-222-1195  
mrozakis@capacitycommercial.com

**RILEY M. HENDERSON**  
Sr. Vice President | 503-975-9301  
riley@capacitycommercial.com

Brokers Have an Ownership Interest in the Property Herein Represented  
©2025 Capacity Commercial Group LLC | 805 SW Broadway #600, Portland OR | 503.326.9000 | capacitycommercial.com





# OLYMPIC MILLS

107 SE WASHINGTON ST.

## OPPORTUNITIES FOR LEASE

06/01/2025



# OLYMPIC MILLS

107 SE WASHINGTON ST.

## OPPORTUNITIES FOR LEASE

06/01/2025

### 3rd Floor

OLYMPIC MILLS SQUARE FOOTAGE		
Suite Number	Sq. Ft.	Max. Combined
315	3,143	
300	7,140	8,982
340	1,842	

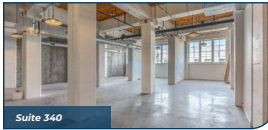

### 3rd FLOOR DIAGRAM

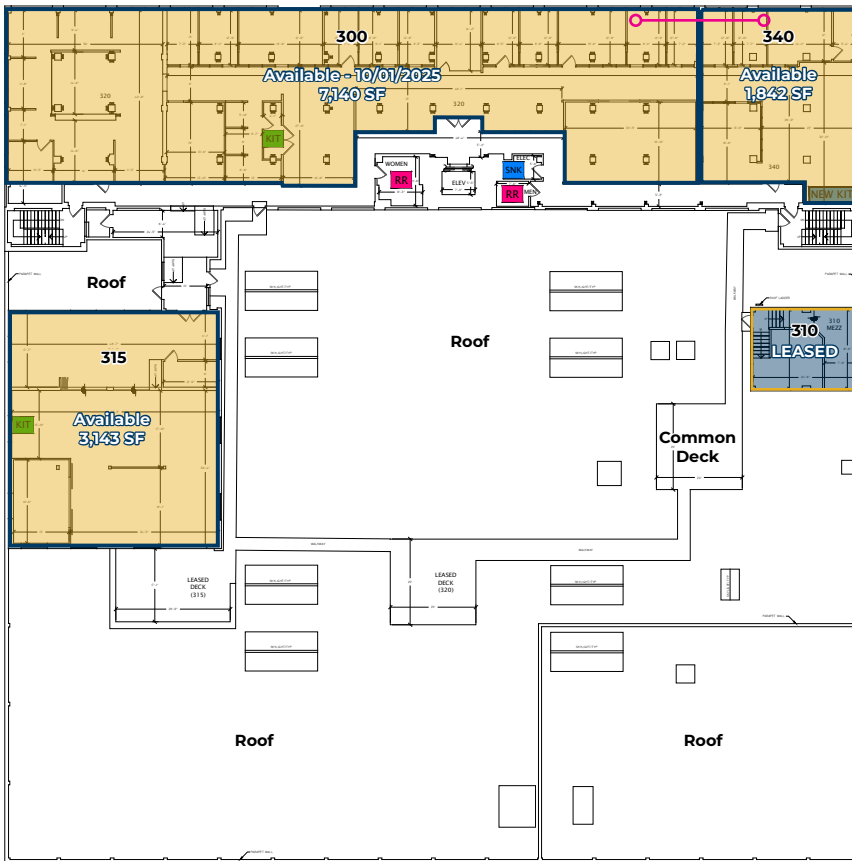

### 4th / 5th Floor

OLYMPIC MILLS SQUARE FOOTAGE		
Suite Number	Sq. Ft.	Max. Combined
450	725	
545	1,716	

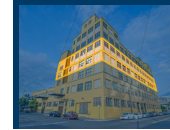

COMBINABLE DIVISIBLE

### 4th FLOOR DIAGRAM

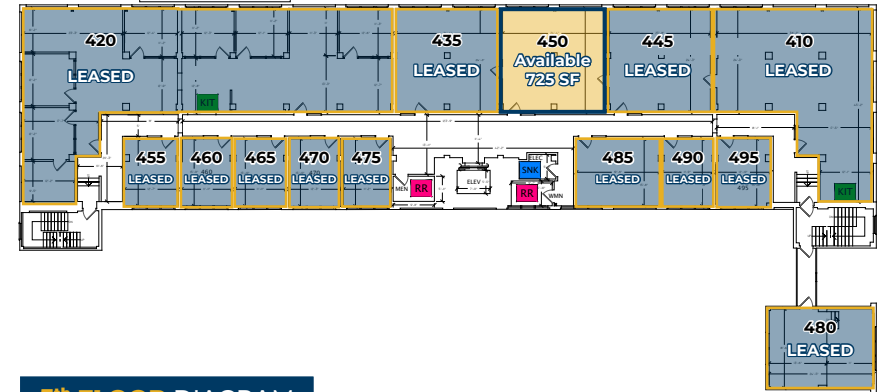

### 5th FLOOR DIAGRAM

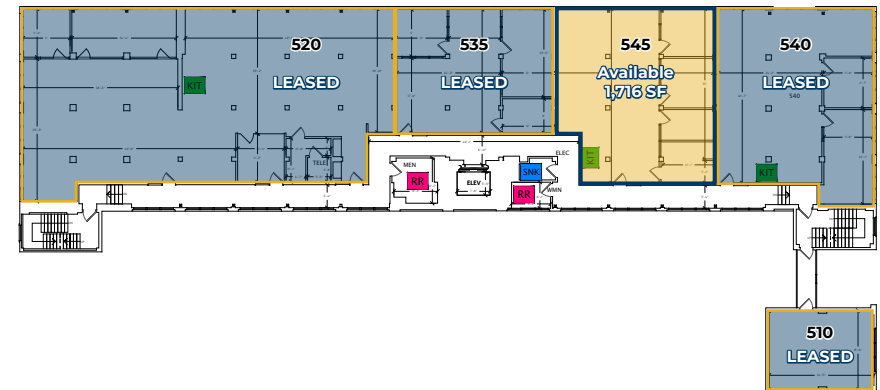

NICHOLAS G. DIAMOND  
Principal Broker | 503-222-2655  
ndiamond@capacitycommercial.com

MICHELLE D. ROZAKIS  
Principal | 503-222-1195  
mrozakis@capacitycommercial.com

RILEY M. HENDERSON  
Sr. Vice President | 503-975-9301  
riley@capacitycommercial.com

Brokers Have an Ownership Interest in the Property Herein Represented

©2025 Capacity Commercial Group LLC · 805 SW Broadway #600, Portland OR · 503.326.9000 · capacitycommercial.com



NICHOLAS G. DIAMOND  
Principal Broker | 503-222-2655  
ndiamond@capacitycommercial.com

MICHELLE D. ROZAKIS  
Principal | 503-222-1195  
mrozakis@capacitycommercial.com

RILEY M. HENDERSON  
Sr. Vice President | 503-975-9301  
riley@capacitycommercial.com

Brokers Have an Ownership Interest in the Property Herein Represented

©2025 Capacity Commercial Group LLC · 805 SW Broadway #600, Portland OR · 503.326.9000 · capacitycommercial.com





# OLYMPIC MILLS

107 SE WASHINGTON ST.

## OPPORTUNITIES FOR LEASE

06/01/2026



# OLYMPIC MILLS

107 SE WASHINGTON ST.

## OPPORTUNITIES FOR LEASE

06/01/2026

**6th Floor**

OLYMPIC MILLS SQUARE FOOTAGE		
Suite Number	Sq. Ft.	Max. Combined
630	1,279	4,873
640	1,742	
650	1,852	

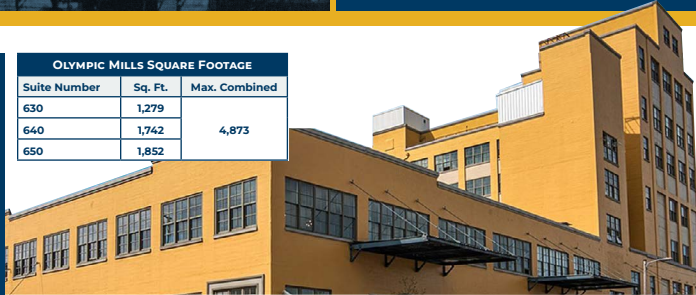

**7th / 8th Floor**

OLYMPIC MILLS SQUARE FOOTAGE		
Suite Number	Sq. Ft.	Max. Combined
7th Floor*	7,598	8,470
8th Floor*	871	
7th Floor Decks / Terraces	2,625	
8th Floor Decks / Terraces	822	

\*Available for Sublease - Please Contact Brokers for More Information

## Penthouse Suite Opportunity

### 7th FLOOR DIAGRAM

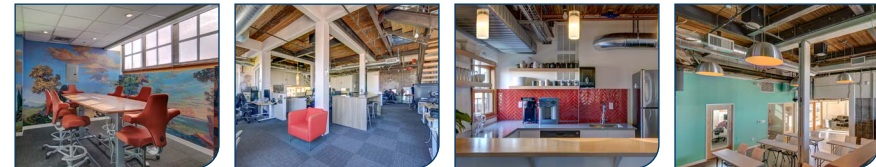
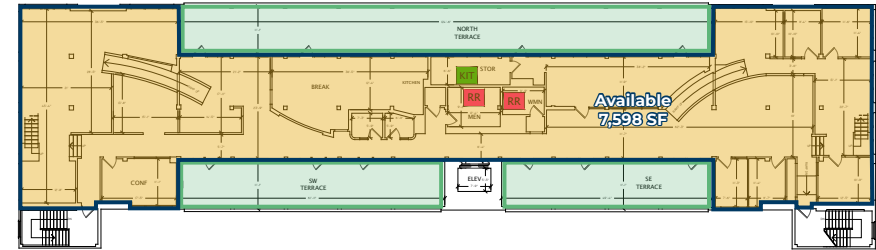

### 6th FLOOR DIAGRAM

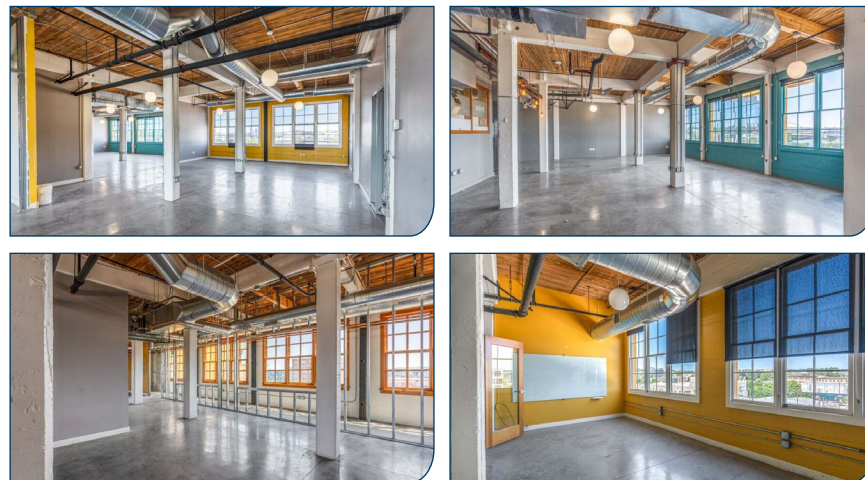
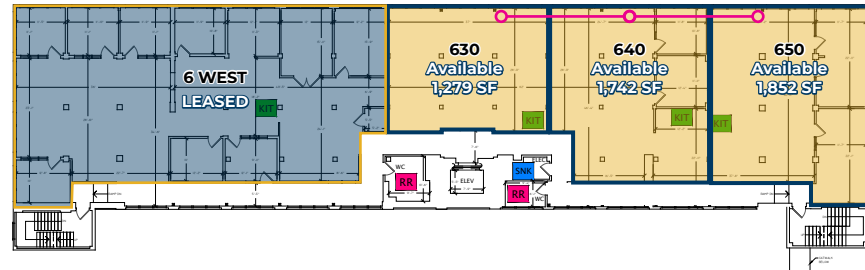

### 8th FLOOR DIAGRAM

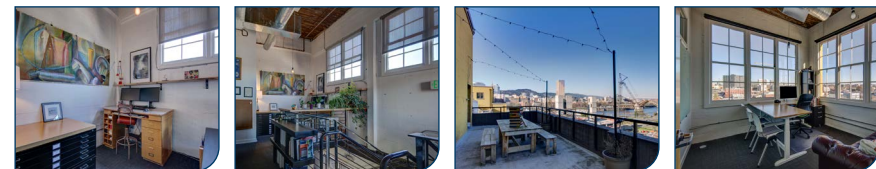
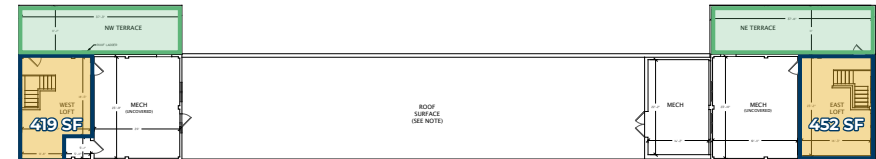

**NICHOLAS G. DIAMOND**  
Principal Broker | 503-222-2655  
ndiamond@capacitycommercial.com

**MICHELLE D. ROZAKIS**  
Principal | 503-222-1195  
mrozakis@capacitycommercial.com

**RILEY M. HENDERSON**  
Sr. Vice President | 503-975-9301  
riley@capacitycommercial.com

Brokers Have an Ownership Interest in the Property Herein Represented

©2025 Capacity Commercial Group LLC | 805 SW Broadway #600, Portland OR | 503.326.9000 | capacitycommercial.com



**NICHOLAS G. DIAMOND**  
Principal Broker | 503-222-2655  
ndiamond@capacitycommercial.com

**MICHELLE D. ROZAKIS**  
Principal | 503-222-1195  
mrozakis@capacitycommercial.com

**RILEY M. HENDERSON**  
Sr. Vice President | 503-975-9301  
riley@capacitycommercial.com

Brokers Have an Ownership Interest in the Property Herein Represented

©2025 Capacity Commercial Group LLC | 805 SW Broadway #600, Portland OR | 503.326.9000 | capacitycommercial.com





# OLYMPIC MILLS

107 SE WASHINGTON ST.

## OPPORTUNITIES FOR LEASE

06/01/2026



# OLYMPIC MILLS

### Basement & Garage Level

OLYMPIC MILLS SQUARE FOOTAGE		
Suite Number	Sq. Ft.	Max. Combined
47 (Storage)	3,033	

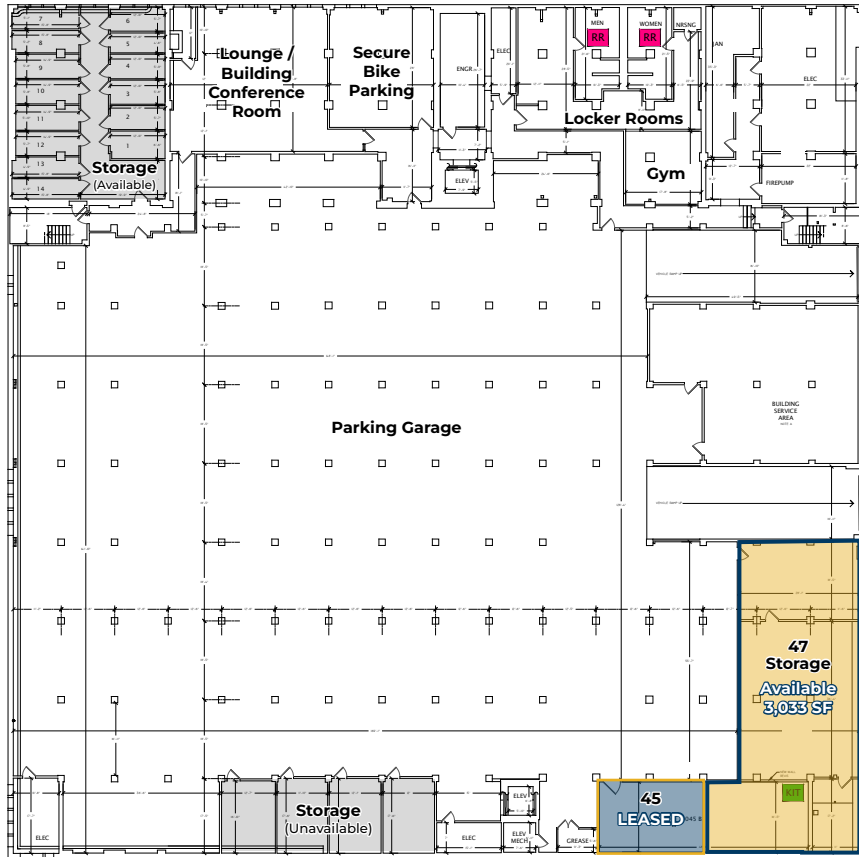

**BASEMENT** DIAGRAM

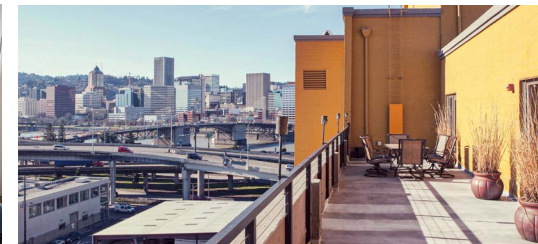
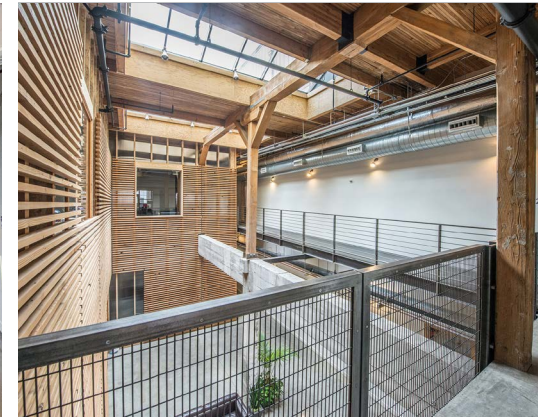
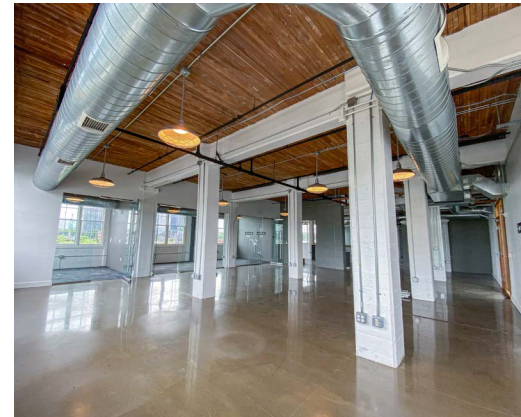

**NICHOLAS G. DIAMOND**  
Principal Broker | 503-222-2655  
ndiamond@capacitycommercial.com

**MICHELLE D. ROZAKIS**  
Principal | 503-222-1195  
mrozakis@capacitycommercial.com

**RILEY M. HENDERSON**  
Sr. Vice President | 503-975-9301  
riley@capacitycommercial.com

Brokers Have an Ownership Interest in the Property Herein Represented

©2025 Capacity Commercial Group LLC • 805 SW Broadway #600, Portland OR • 503.326.9000 • capacitycommercial.com



**NICHOLAS G. DIAMOND**  
Principal Broker | 503-222-2655  
ndiamond@capacitycommercial.com

**MICHELLE D. ROZAKIS**  
Principal Broker | 503-222-1195  
mrozakis@capacitycommercial.com

**RILEY M. HENDERSON**  
Senior Associate Broker | 503-975-9301  
riley@capacitycommercial.com

Brokers Have an Ownership Interest in the Property Herein Represented

©2025 Capacity Commercial Group LLC • 805 SW Broadway #600, Portland OR • 503.326.9000 • capacitycommercial.com

