

FOR LEASE

# PARKSIDE BUSINESS CENTER

8120 SW NIMBUS AVE, SUITE 5A, BEAVERTON, OR



## 6,967 SF of Office Warehouse – Suite 5A

6,967 SF available	Available August 1, 2026
1,270 SF of office	2025 NNN's estimated \$0.49/SF (including taxes, insurance, CAM, water, sewer, garbage, and all HVAC costs)
18' clear height	
1 dock high door	
1 grade level door	Could be combined with Unit 5B for a total of 14,599 SF

**6,967 SF**

SPACE AVAILABLE

**8/1**

AVAILABLE

**CALL**

FOR LEASE RATE

[KIDDER.COM](http://KIDDER.COM)

This information supplied herein is from sources we deem reliable. It is provided without any representation, warranty, or guarantee, expressed or implied as to its accuracy. Prospective Buyer or Tenant should conduct an independent investigation and verification of all matters deemed to be material, including, but not limited to, statements of income and expenses. Consult your attorney, accountant, or other professional advisor.

**STEVEN KLEIN**  
503.221.2260  
[steven.klein@kidder.com](mailto:steven.klein@kidder.com)

**PETER STALICK**  
503.221.2272  
[peter.stalick@kidder.com](mailto:peter.stalick@kidder.com)

**BRENDAN MURPHY**  
503.721.2705  
[brendan.murphy@kidder.com](mailto:brendan.murphy@kidder.com)

**GENEVIEVE KLEIN**  
503.221.2284  
[genevieve.klein@kidder.com](mailto:genevieve.klein@kidder.com)

OWNED BY



EXCLUSIVELY LEASED BY



# UNIT 5-A

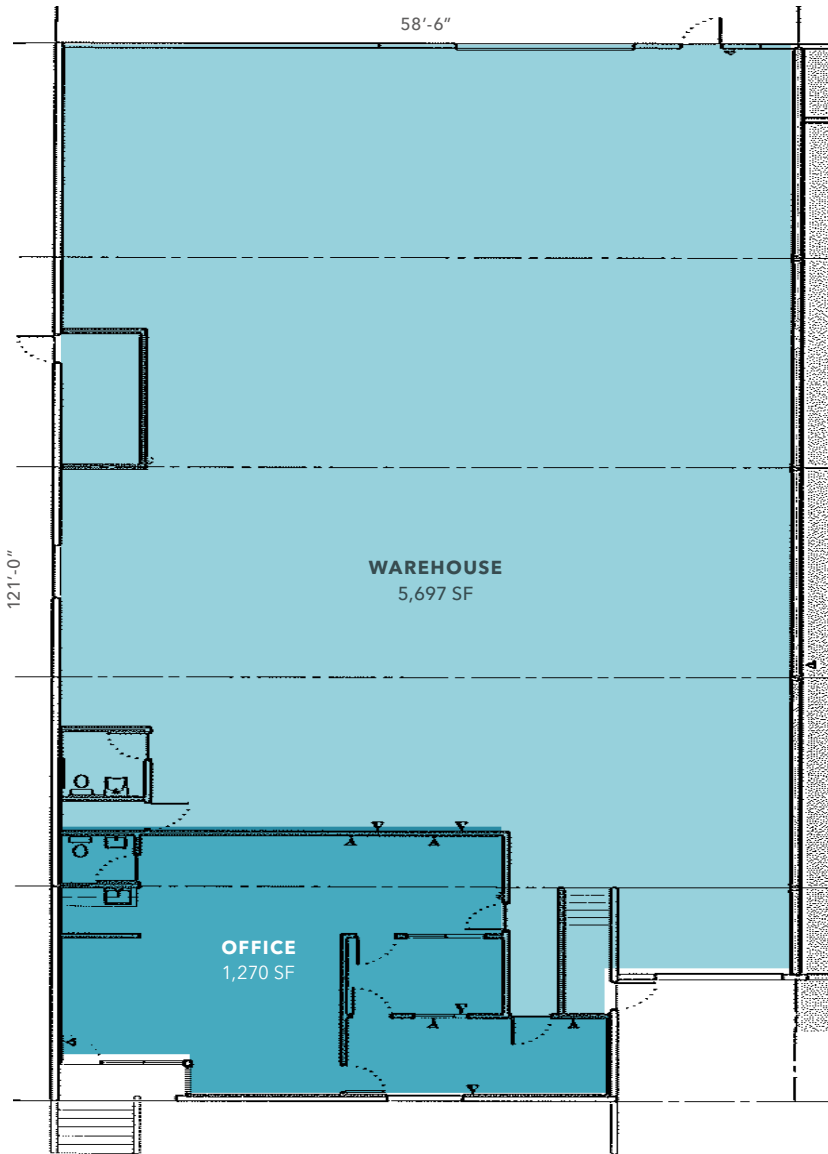

**6,967 SF**

AVAILABLE SHELL

**1,270 SF**

OFFICE SPACE

**1**

DOCK DOOR

**1**

GRADE-LEVEL DOOR

**BRENDAN MURPHY**  
503.721.2705  
brendan.murphy@kidder.com

**PETER STALICK**  
503.221.2272  
peter.stalick@kidder.com

**STEVEN KLEIN**  
503.221.2260  
steven.klein@kidder.com

**GENEVIEVE KLEIN**  
503.221.2284  
genevieve.klein@kidder.com

**KIDDER.COM**

This information supplied herein is from sources we deem reliable. It is provided without any representation, warranty, or guarantee, expressed or implied as to its accuracy. Prospective Buyer or Tenant should conduct an independent investigation and verification of all matters deemed to be material, including, but not limited to, statements of income and expenses. Consult your attorney, accountant, or other professional advisor.



# SITE PLAN



**BRENDAN MURPHY**  
503.721.2705  
brendan.murphy@kidder.com

**PETER STALICK**  
503.221.2272  
peter.stalick@kidder.com

**STEVEN KLEIN**  
503.221.2260  
steven.klein@kidder.com

**GENEVIEVE KLEIN**  
503.221.2284  
genevieve.klein@kidder.com

**KIDDER.COM**

This information supplied herein is from sources we deem reliable. It is provided without any representation, warranty, or guarantee, expressed or implied as to its accuracy. Prospective Buyer or Tenant should conduct an independent investigation and verification of all matters deemed to be material, including, but not limited to, statements of income and expenses. Consult your attorney, accountant, or other professional advisor.



# PARKSIDE BUSINESS CENTER



KIDDER.COM

This information supplied herein is from sources we deem reliable. It is provided without any representation, warranty, or guarantee, expressed or implied as to its accuracy. Prospective Buyer or Tenant should conduct an independent investigation and verification of all matters deemed to be material, including, but not limited to, statements of income and expenses. Consult your attorney, accountant, or other professional advisor.