

2490 Dogwood Drive - Bldg. 300/Ste. F

Conyers, GA 30013

40,800 SF – FOR LEASE

ROCKDALE TECHNOLOGY CENTER



SUITE INFORMATION

Total Square Feet:	40,800 SF
Warehouse:	39,300 SF
Office:	1,500 SF (expandable)
Loading Doors:	10 dock-high with 2 pit levelers 1 EoD leveler
Drive-in Doors:	One (1) oversized ramp (12' x 21.5')
Ceiling Height:	30' clear
Sprinklers:	ESFR
Lighting:	LED on Motion Sensors – 30 FC



Joseph Kriss
678.362.4641
josephk@seefriedproperties.com

Tripp Ausband
770.825.3391 Direct
tausband@seefriedproperties.com

Seefried Industrial Properties
3333 Riverwood Parkway, Suite 200 | Atlanta, GA 30339
404.233.0204 | www.seefriedproperties.com



No guarantee, warranty or representation, express or implied, is made as to the accuracy of the information contained herein, and same is submitted subject to errors, omissions, change of price, rental or other conditions, or withdrawal without notice.

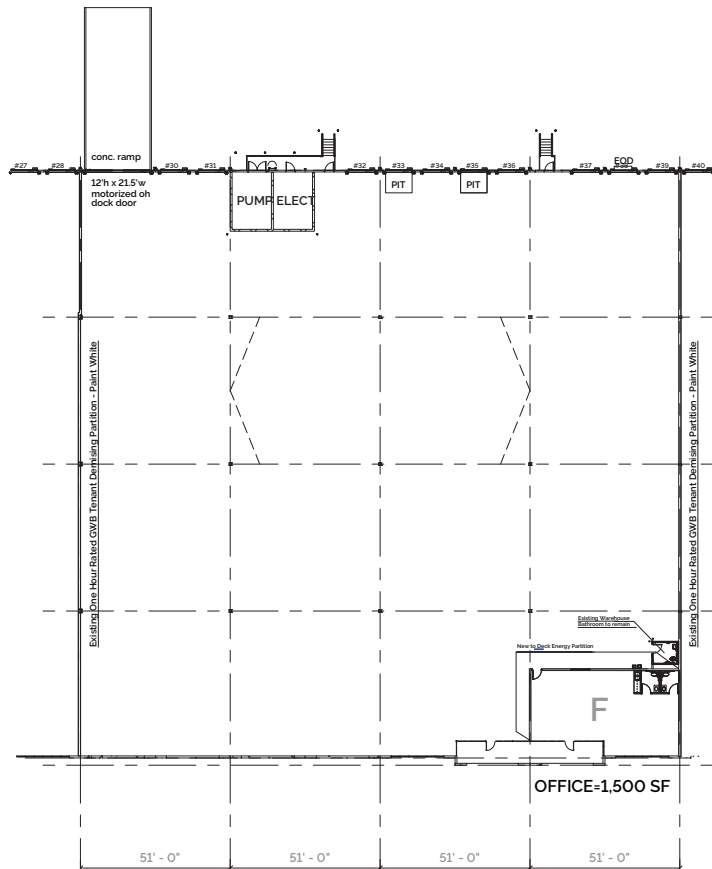

Joseph Kriss
 678.362.4641
 josephk@seefriedproperties.com

Tripp Ausband
 770.825.3391 Direct
 tausband@seefriedproperties.com

Seefried Industrial Properties
 3333 Riverwood Parkway, Suite 200 | Atlanta, GA 30339
 404.233.0204 | www.seefriedproperties.com

