

2110 Lawrence Street - Suite 300

Atlanta, GA 30334

124,432 SF – FOR LEASE

CREEKSIDE DISTRIBUTION CENTER | END-CAP WITH ADDITIONAL OFFSITE PARKING



SUITE INFORMATION

Total Square Feet:	124,432 SF
Warehouse:	122,832 SF
Office:	1,600 SF
Loading Doors:	22 dock-high; 1 drive-in
Dock Equipment:	Four (4) pit levelers and six (6) EoD levelers
Column Spacing:	50'x50'
Truckcourt:	Approx. 185'
Ceiling Height:	32' clear
Sprinklers:	ESFR
Lighting:	LED
Auto Parking:	24 (expandable to 214)
Trailer Parking:	23 (expandable)



Joseph Kriss
678.362.4641
josephk@seefriedproperties.com

Tripp Ausband
770.825.3391 Direct
tausband@seefriedproperties.com

Seefried Industrial Properties
3333 Riverwood Parkway, Suite 200 | Atlanta, GA 30339
404.233.0204 | www.seefriedproperties.com



No guarantee, warranty or representation, express or implied, is made as to the accuracy of the information contained herein, and same is submitted subject to errors, omissions, change of price, rental or other conditions, or withdrawal without notice.

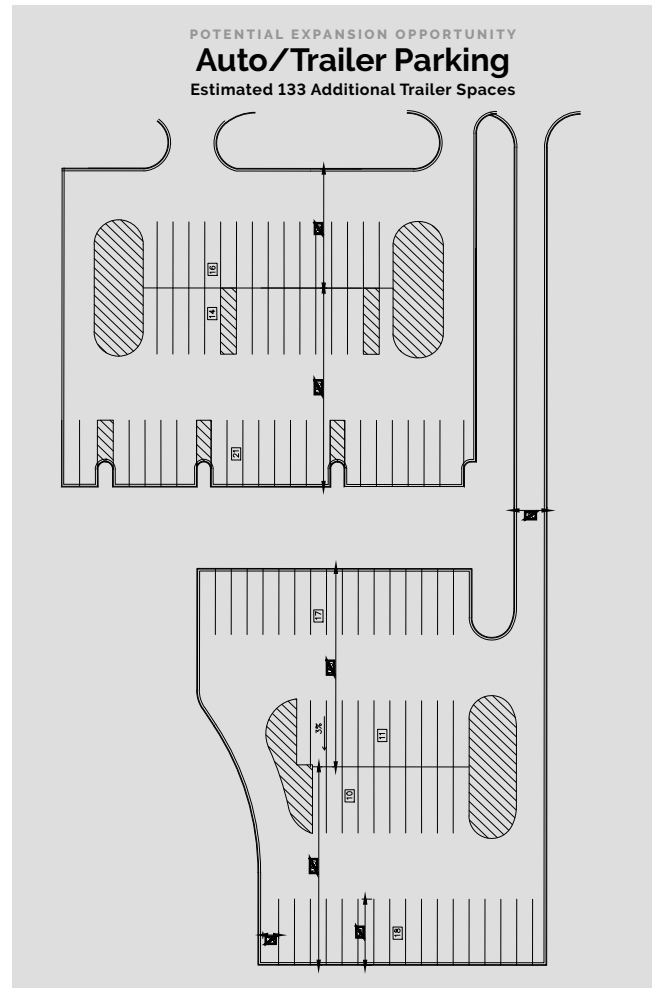
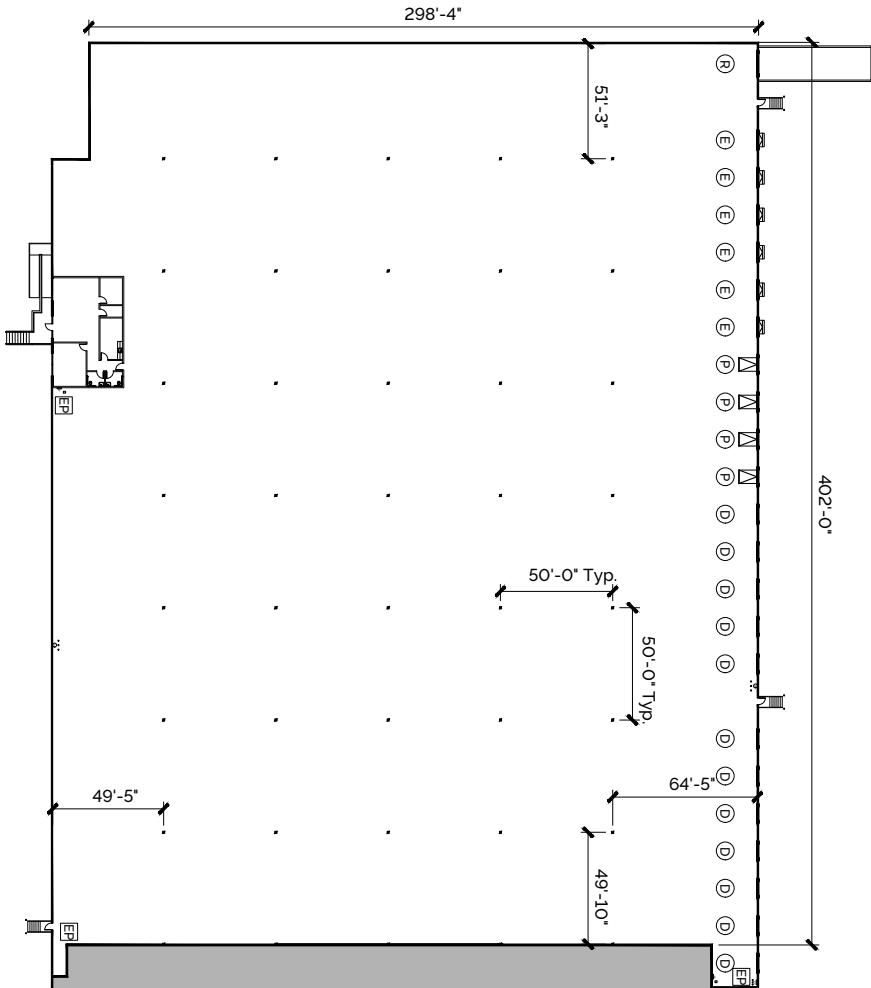

Joseph Kriss
678.362.4641
josephk@seefriedproperties.com

Tripp Ausband
770.825.3391 Direct
tausband@seefriedproperties.com

Seefried Industrial Properties
3333 Riverwood Parkway, Suite 200 | Atlanta, GA 30339
404.233.0204 | www.seefriedproperties.com

