

For Lease

CBRE

119 19th Street NW

Calgary AB



Retail Space-

For Lease- 119 19th Street NW, Calgary

Property Information

DETAILS

| | |
|----------------------------|---------------------|
| Size: | Unit 113- 694 sq.ft |
| Op Costs 2022 est.: | \$14.00 per sq.ft |
| Zoning: | DC |
| Rates: | Market |
| Signage: | Fascia |

Property Highlights

- Located on the corner of Kensington Road and 19th Street NW in the desirable community of West Hillhurst
- Savoy is an upscale multi-use building with retail on the main floor and residential units
- Ample street parking

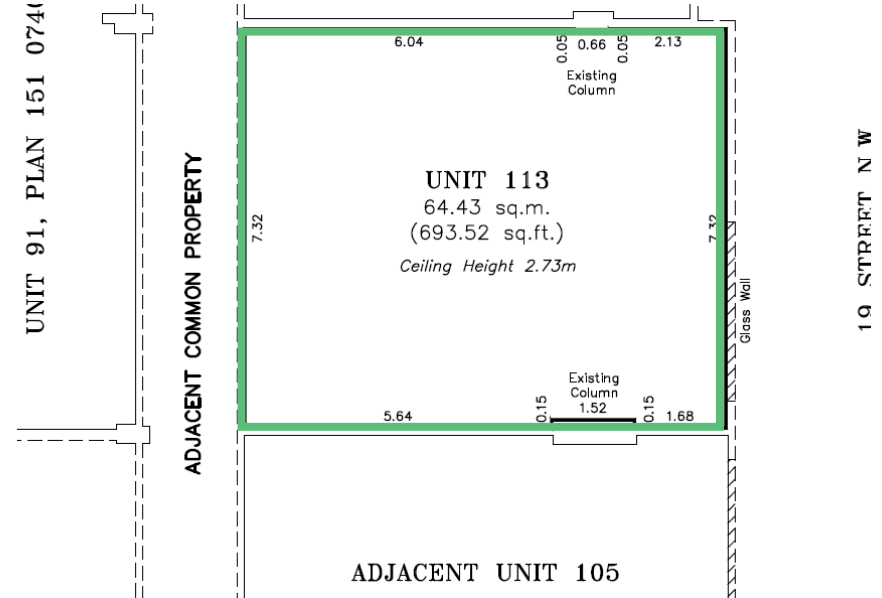

John Moss

Senior Vice President
403.750.0507
john.moss@cbre.com

Ania Gryzewski

Associate Vice President
403.750.0806
ania.gryzewski@cbre.com
* On Maternity Leave

Joanna Grant

Sales Representative
403.294.5705
joanna.grant@cbre.com

This disclaimer shall apply to CBRE Limited, Real Estate Brokerage, and to all other divisions of the Corporation; to include all employees and independent contractors ("CBRE"). All references to CBRE Limited herein shall be deemed to include CBRE, Inc. The information set out herein, including, without limitation, any projections, images, opinions, assumptions and estimates obtained from third parties (the "Information") has not been verified by CBRE, and CBRE does not represent, warrant or guarantee the accuracy, correctness and completeness of the Information. CBRE does not accept or assume any responsibility or liability, direct or consequential, for the Information or the recipient's reliance upon the Information. The recipient of the Information should take such steps as the recipient may deem necessary to verify the Information prior to placing any reliance upon the Information. The Information may change and any property described in the Information may be withdrawn from the market at any time without notice or obligation to the recipient from CBRE. CBRE and the CBRE logo are the service marks of CBRE Limited and/or its affiliated or related companies in other countries. All other marks displayed on this document are the property of their respective owners. All Rights Reserved. Mapping Sources: Canadian Mapping Services canadamapping@cbre.com; DMTI Spatial, EnviroNics Analytics, Microsoft Bing, Google Earth

www.cbre.ca

