

FOR LEASE

RESTAURANT SPACE
2619 1ST AVENUE | SEATTLE, 98121

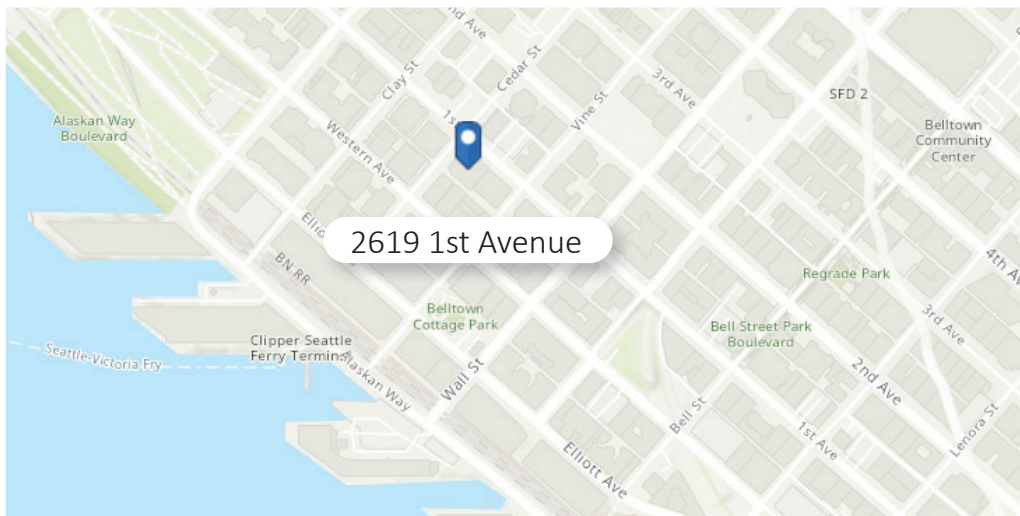

PROPERTY FEATURES

- Average daily Traffic Count on 1st Ave at Cedar St: 15,986 in 2020
- Restaurant space in Belltown with Type 1 hood.
- First time available in the last 25 years
- Strategic location between the Pike Place Market, Seattle Center and the Olympic Sculpture Park.
- Limited furniture and equipment in the premises
- 3,843 rsf
- \$30/sf/yr + NNN (NNN=\$4.61/sf/yr)



RICHARD RILEY

206.499.9627
rriley@ewingandclark.com

TOM GRAFF

206.441.7900
tomgraff@ewingandclark.com

FLOOR PLAN

2619 1ST AVENUE | SEATTLE, 98121

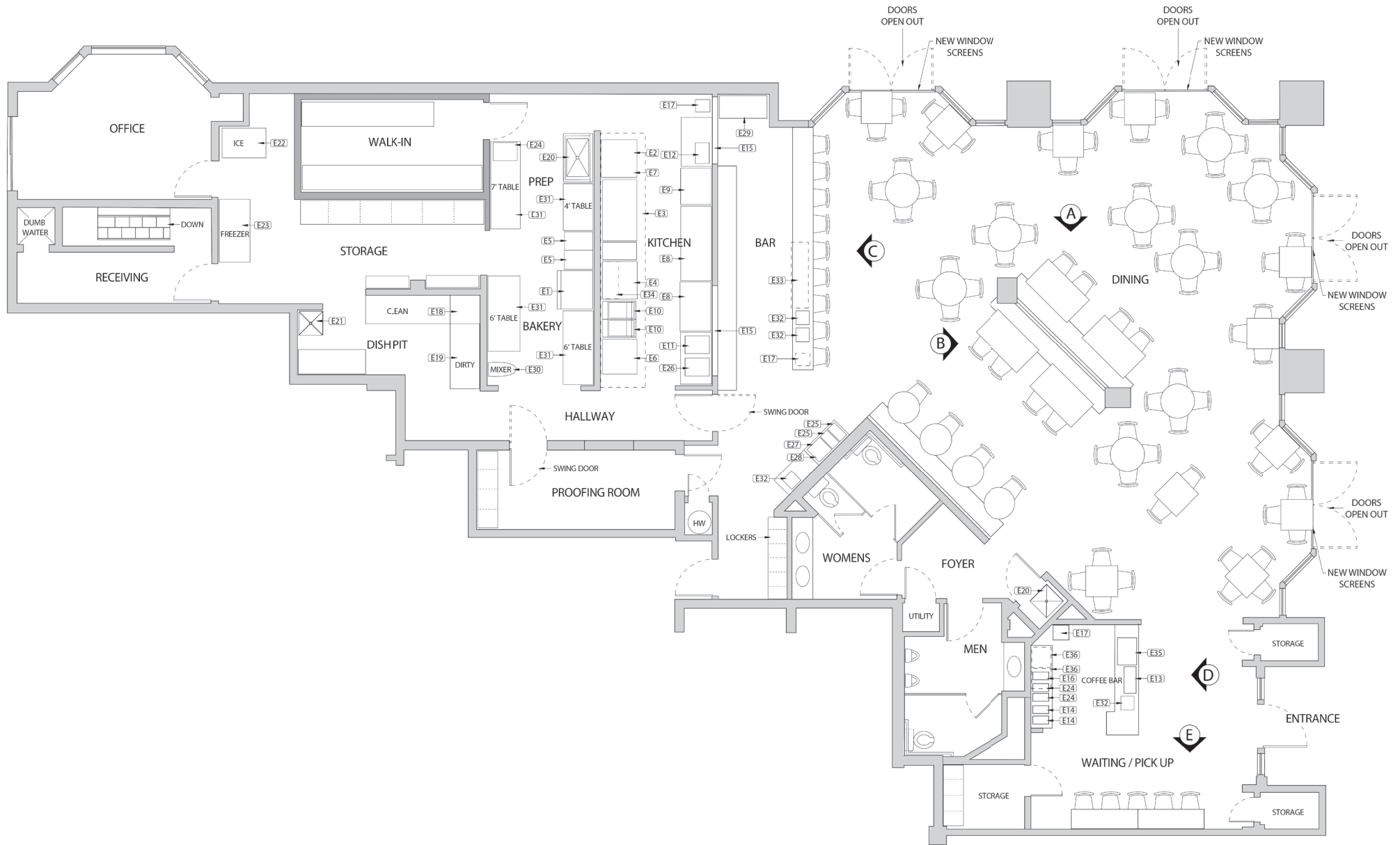

AERIAL MAP

2619 1ST AVENUE | SEATTLE, 98121

