

AVAILABLE FOR SALE / LEASE

250 S. HICKS ROAD

PALATINE, IL 60067



BUILDING SPECIFICATIONS:

BUILDING SIZE:	±60,160 SF
OFFICE:	To suit (none currently) 1,500 SF mezzanine warehouse office
SITE SIZE:	2.92 acres
CLEAR HEIGHT:	20'
COLUMNS:	31' x 40'
LOADING:	› Four (4) docks (2 interior - 60' bay, 2 exterior) › Three (3) 14' drive-in doors, four (4) total
SPRINKLER:	Wet
CONSTRUCTION:	Masonry
PARKING:	75 spaces
POWER:	2500+ amps - heavy power
2025 TAXES:	\$3.14 PSF
LEASE RATE:	Subject to Offer
SALE PRICE:	Subject to Offer
COMMENTS:	› Great stand-alone manufacturing building › 1 mile to full interchange onto Route 53, I-355 and I-290 › Close proximity to Metra stops - Arlington Heights and Palatine › Cross dock loading

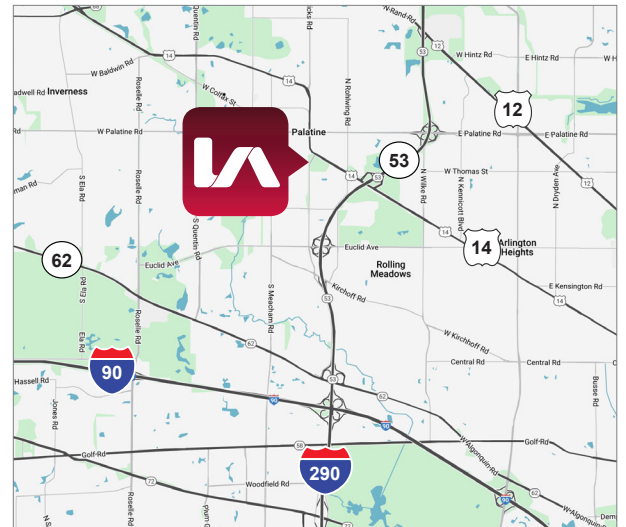

Todd Hendricks
Senior Vice President
thendricks@lee-associates.com
D 773.355.3025

Jeff Provenza
Principal
jprovenza@lee-associates.com
D 630.747.6350

All information furnished regarding property for sale, rental or financing is from sources deemed reliable, but no warranty or representation is made to the accuracy thereof and same is submitted to errors, omissions, change of price, rental or other conditions prior to sale, lease or financing or withdrawal without notice. No liability of any kind is to be imposed on the broker herein.

AVAILABLE FOR SALE / LEASE

250 S. HICKS ROAD

PALATINE, IL 60067

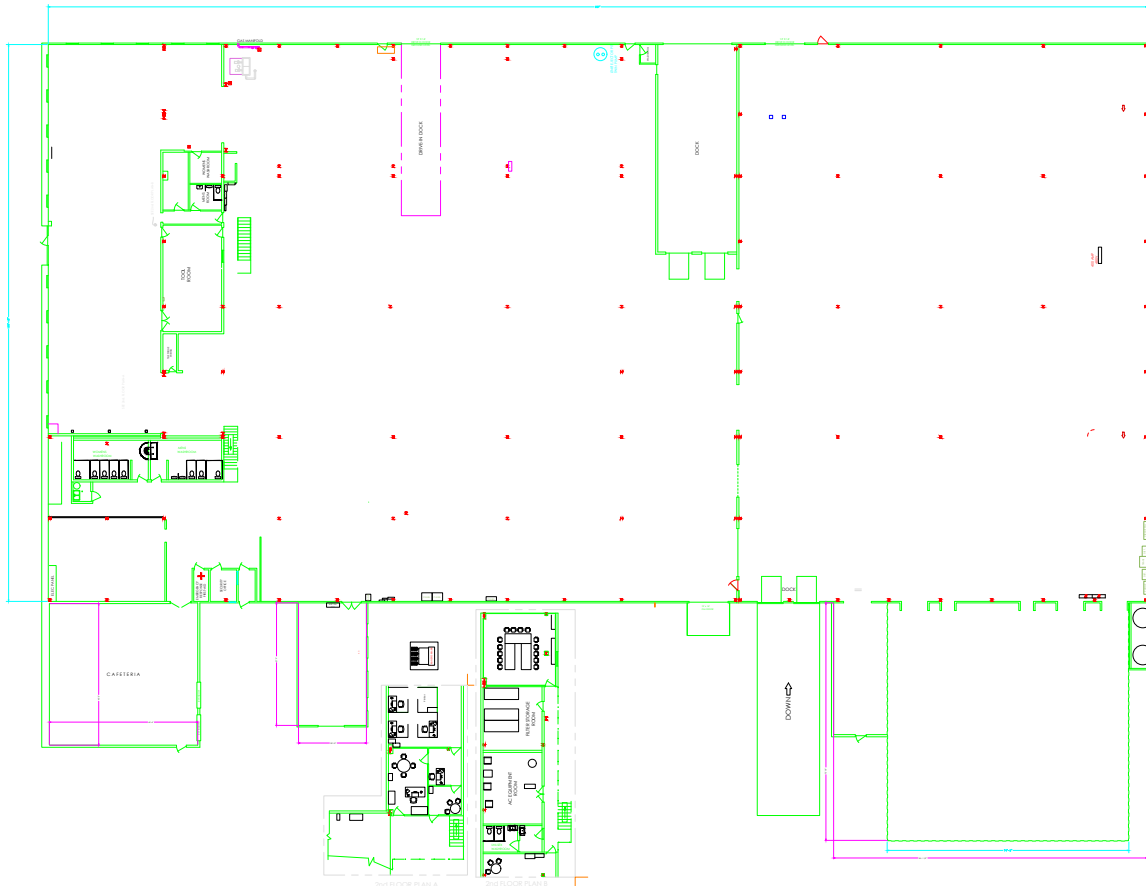

Todd Hendricks
Senior Vice President
thendricks@lee-associates.com
D 773.355.3025

Jeff Provenza
Principal
jprovenza@lee-associates.com
D 630.747.6350

All information furnished regarding property for sale, rental or financing is from sources deemed reliable, but no warranty or representation is made to the accuracy thereof and same is submitted to errors, omissions, change of price, rental or other conditions prior to sale, lease or financing or withdrawal without notice. No liability of any kind is to be imposed on the broker herein.