

RETAIL/OFFICE SPACE FOR SUBLEASE



---

# 415 Centre Street

WINNIPEG, MB



**PRESLEY BORDIAN**, *Vice President, Sales & Leasing*  
(204) 985-1356  
[presley.bordian@capitalgrp.ca](mailto:presley.bordian@capitalgrp.ca)

**RENNIE ZEGALSKI**, *Principal*  
(204) 985-1368  
[rennie.zegalski@capitalgrp.ca](mailto:rennie.zegalski@capitalgrp.ca)  
*Services provided by Rennie Zegalski Personal Real Estate Corporation*

# Property Overview

## PROPERTY DETAILS

<b>AREA AVAILABLE (+/-)</b>	5,000 sq. ft.
<b>NET RENTAL RATE</b>	Current - October 31, 2028: \$30.00 per sq. ft. November 1, 2028 - October 31, 2030: \$31.00 per sq. ft. November 1, 2030 - October 31, 2033: \$32.00 per sq. ft.
<b>ADDITIONAL RENT</b>	\$11.37 per sq. ft. plus 5% mgmt. fee (est. 2026)
<b>SIGNAGE</b>	Building signage available
<b>PARKING (+/-)</b>	195 stalls
<b>ZONING</b>	MMU
<b>ELECTRICAL</b>	400 Amp, 120/208V, 3-Phase 4-Wire
<b>MECHANICAL</b>	Four (4) 4-ton natural gas rooftop HVAC
<b>HEAD LEASE EXPIRY</b>	October 31, 2033
<b>AVAILABILITY</b>	Immediately

## PROPERTY HIGHLIGHTS

- High-profile, standalone building ready for tenant fixturing
- Located adjacent to a new, first-class 43,000 sq. ft. (+/-) office/flex building currently under construction, and directly across from Winnipeg's new Altea Active Centre
- Excellent signage visibility along a high-traffic thoroughfare with over 25,400 vehicles per day (*City of Winnipeg 2024 Traffic Flow Map*)

## SITE PLAN

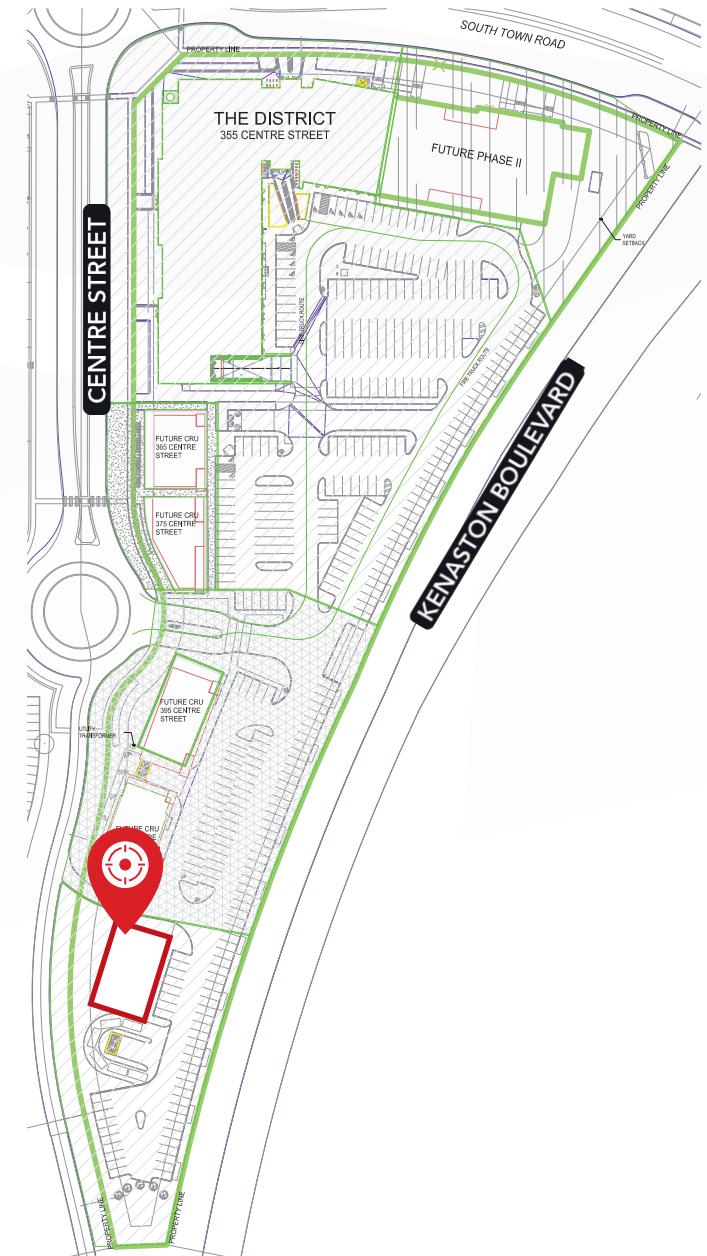

# Floor Plan

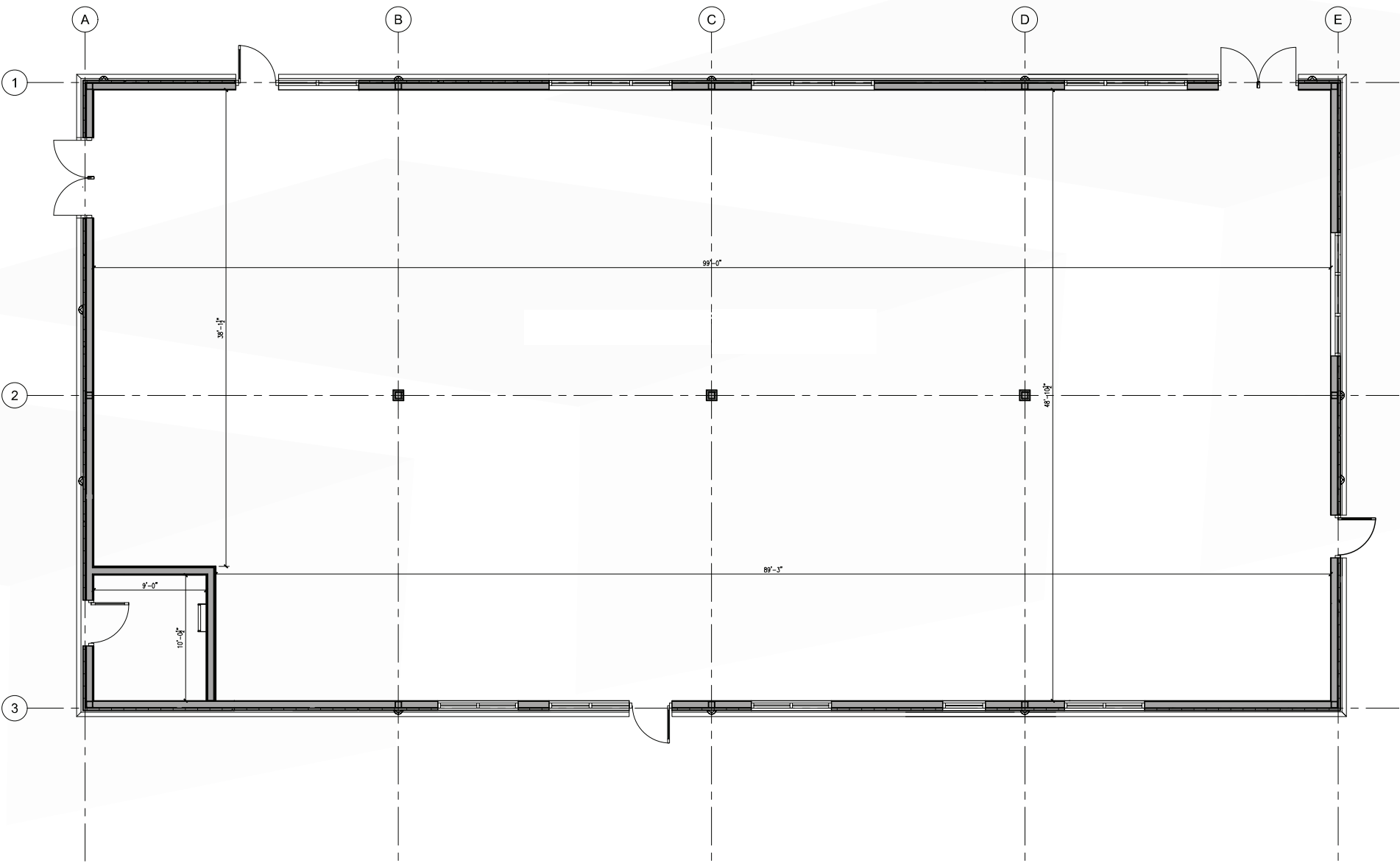

# Interior Photos



# The District at Bridgewater



# Location Aerial



#	Name	Address	Units
1	The Bridgwater	250 Centre St.	160
2	The Bravado	15 Cooper's Town Rd.	180
3	The Allure	70 Park East Dr.	200
4	The Rise Condominiums	300 Centre St.	150
5	The Pinnacle at Bridgwater (3.4 km west of site)	355 Bridge Lake Dr.	300+
6	The Tradition at Bridgwater (3.9 km west of site)	186 Appleford Gate	250

# Demographic Analysis



## POPULATION

Total Population

1 km	3 km	5 km
9,669	57,229	96,037

Projected Population (2030)

1 km	3 km	5 km
10,501	61,312	103,312



## MEDIAN AGE

Median Age

1 km	3 km	5 km
30.5	32.3	32.9



## HOUSEHOLD INCOME

Avg. Household Income

1 km	3km	5km
\$146,062	\$157,833	\$142,383

Proj. Household Income (2030)

1 km	3km	5km
\$170,662	\$181,475	\$164,755



## HOUSEHOLDS

Total Households

1 km	3 km	5km
2,942	18,737	33,057

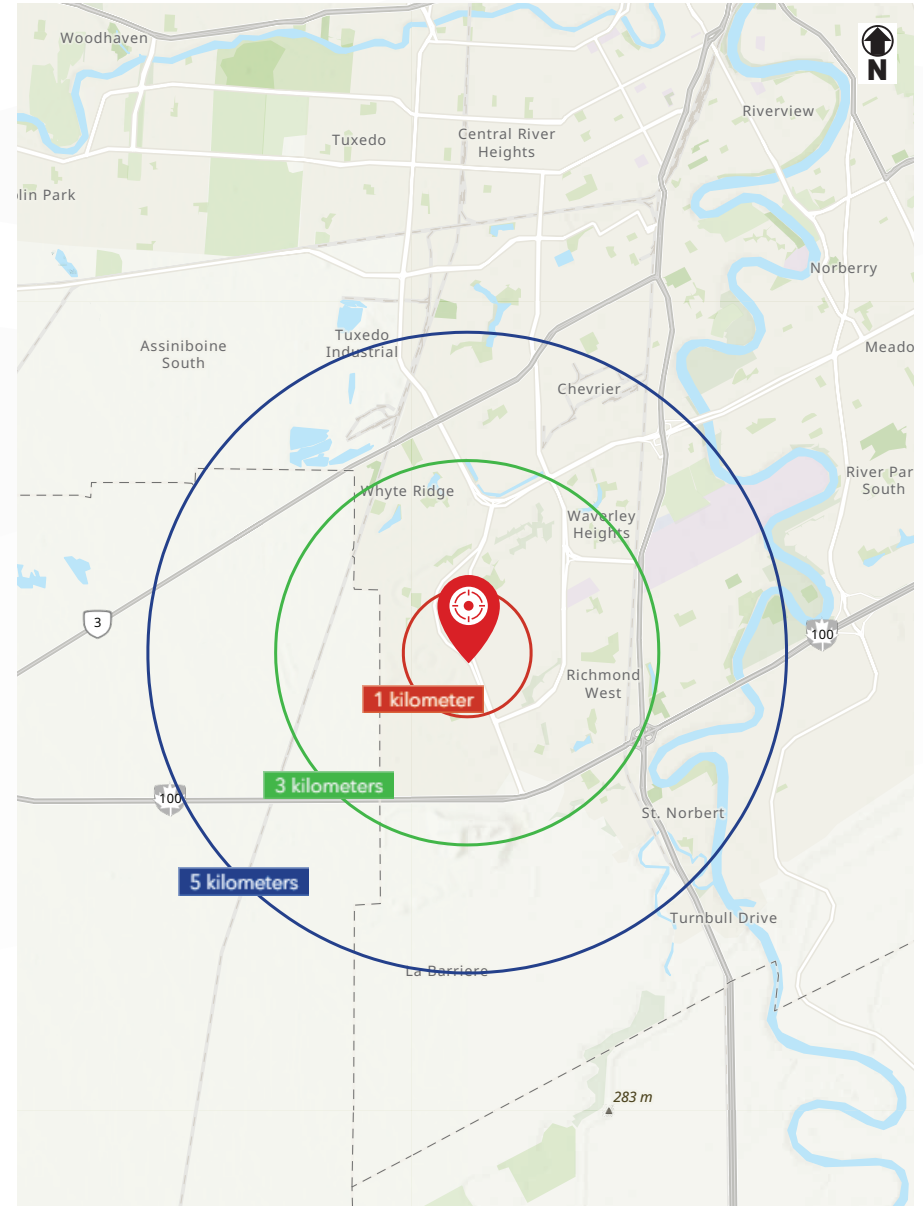



---

## Contact

PRESLEY BORDIAN, Vice President, Sales & Leasing

(204) 985-1356

[presley.bordian@capitalgrp.ca](mailto:presley.bordian@capitalgrp.ca)

RENNIE ZEGALSKI, Principal

(204) 985-1365

[rennie.zegalski@capitalgrp.ca](mailto:rennie.zegalski@capitalgrp.ca)

*Services provided by Rennie Zegalski Personal Real Estate Corporation*

## CAPITAL COMMERCIAL REAL ESTATE SERVICES INC.

300-570 Portage Avenue, Winnipeg, MB R3C 0G4 | T (204) 943-5700 | F (204) 956-2783 | [capitalgrp.ca](http://capitalgrp.ca)

Disclaimer: Capital Commercial Real Estate Services Inc. ("Capital") does not accept or assume any responsibility or liability, direct or consequential, for the information set out herein, including, without limitation, any projections, images, opinions, assumptions and estimates obtained from third parties. This information has not been verified by Capital, and Capital does not guarantee the accuracy, correctness and completeness of this information. The recipient of this information should take such steps as the recipient may deem necessary to verify the information in this document prior to placing any reliance upon it. The information may change and any property described in this document may be withdrawn from the market at any time without notice or obligation to the recipient from Capital.