

BEDFORD-STUYVESANT, BROOKLYN, NY

48 SOMERS STREET

MOD



SPACE DETAILS

LOCATION

Between Lewis Avenue and Marcus Garvey Boulevard

SPACE

Ground Floor - 1,707 SF

POSSESSION

Immediately

ASKING RENT

Upon Request

NEIGHBORS

Dunkin', Crown Fried Chicken, Subway, Key Food Supermarket, Fulton Ale House, Bravo Supermarkets

TRANSPORTATION



COMMENTS

- Brand new building on high-traffic Fulton Street
- 800A electric – suitable for high-power commercial use
- Strong foot traffic with dense residential area
- TI Available for right Tenant

CONTACTS

MEYER DAGMY

718-249-3613

m@modcre.com

EDDIE MAMIYE

917-379-6719

e@modcre.com

JACK DAGMY

718-249-3614

j@modcre.com



INTERIOR PHOTOS



CONTACTS

MEYER DAGMY

718-249-3613

m@modcre.com

EDDIE MAMIYE

917-379-6719

e@modcre.com

JACK DAGMY

718-249-3614

j@modcre.com



FLOOR PLAN

SOMERS STREET

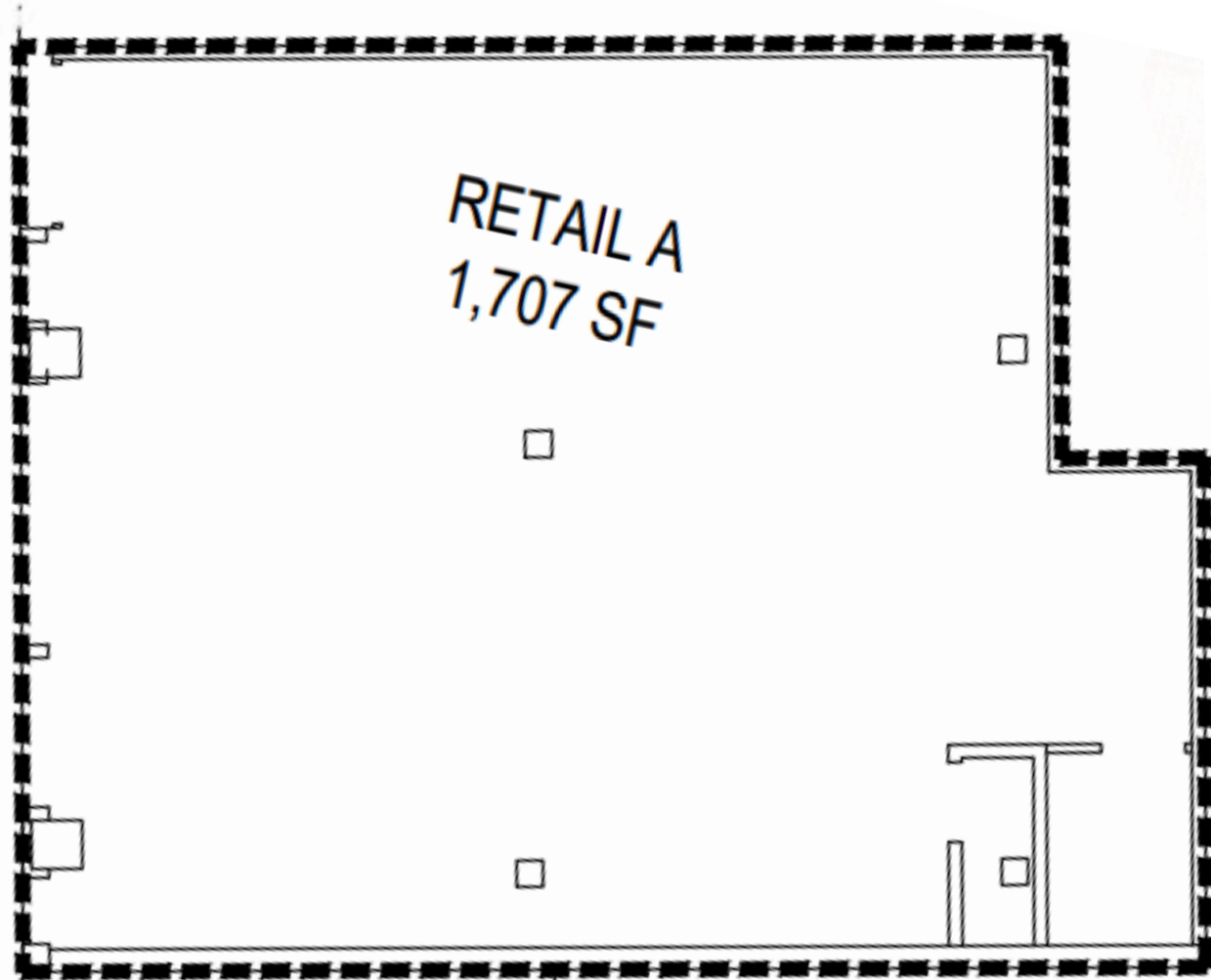

CONTACTS

MEYER DAGMY

718-249-3613

m@modcre.com

EDDIE MAMIYE

917-379-6719

e@modcre.com

JACK DAGMY

718-249-3614

j@modcre.com



AREA MAP

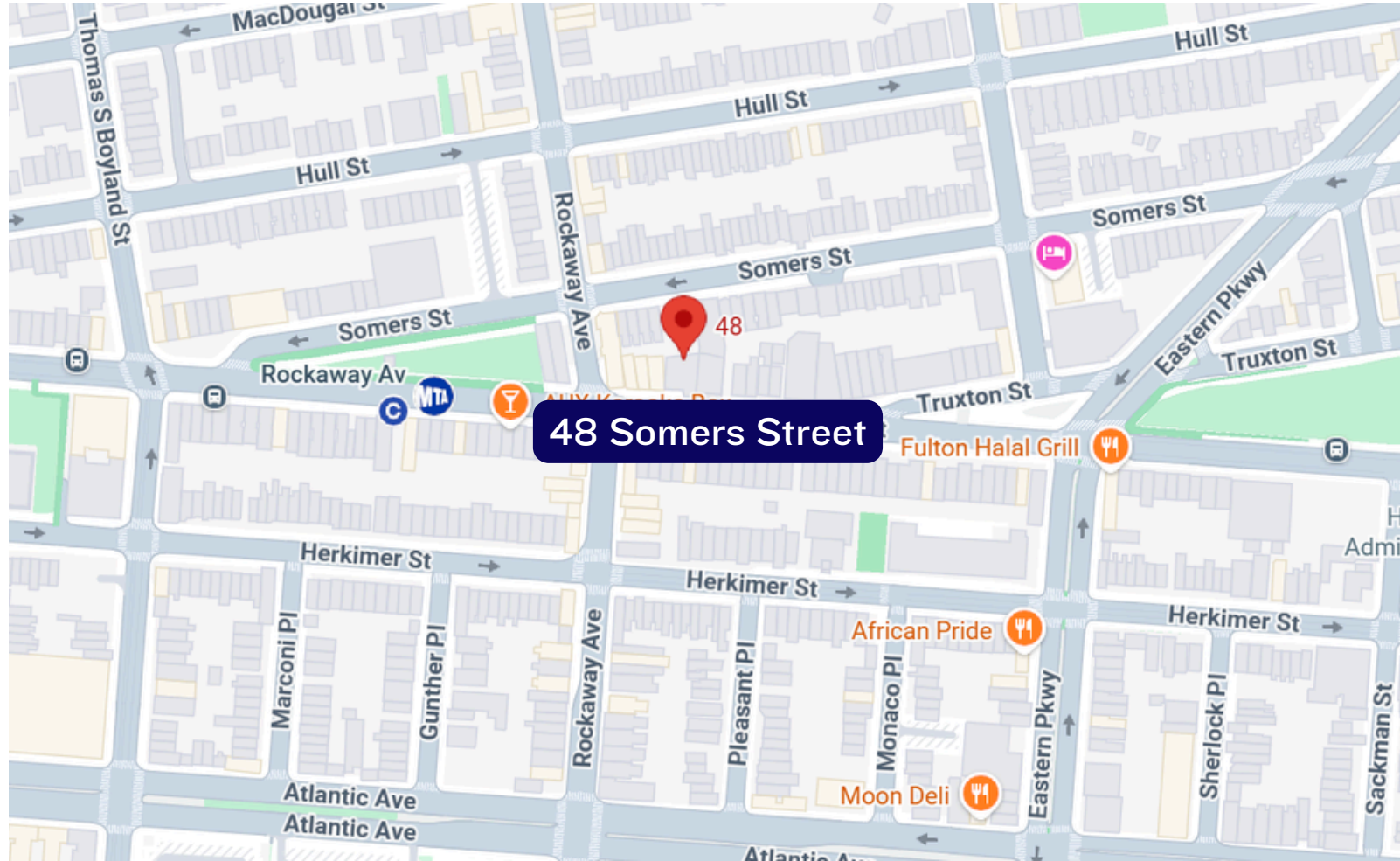

CONTACTS

MEYER DAGMY

718-249-3613

m@modcre.com

EDDIE MAMIYE

917-379-6719

e@modcre.com

JACK DAGMY

718-249-3614

j@modcre.com

