

- SUITE 100 - AVAILABLE  
3,054 SF
- COMMON AREA

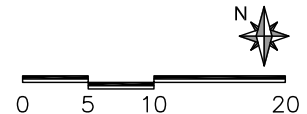
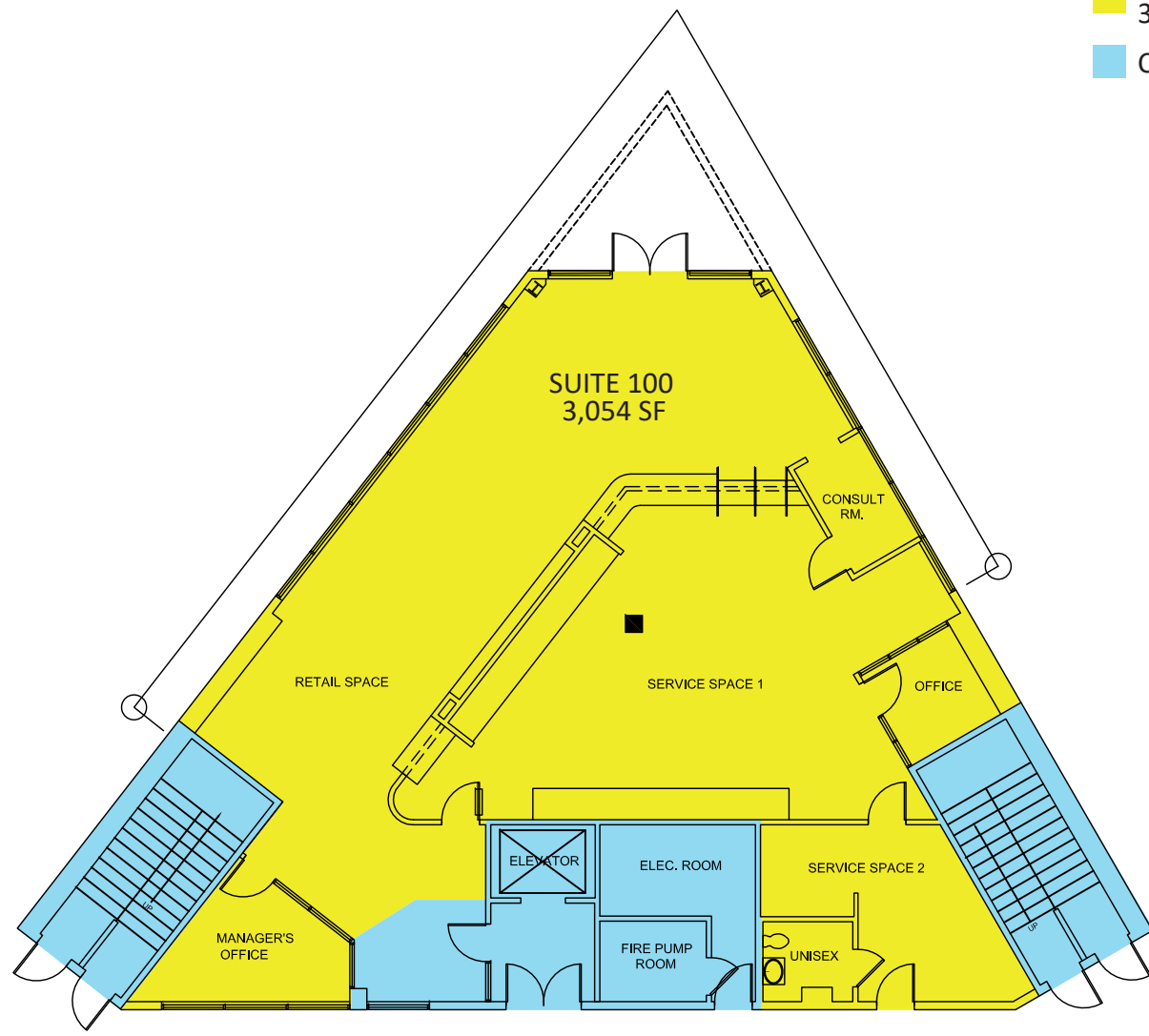

FLOOR PLANS ARE FOR CONCEPTUAL PURPOSES ONLY; THEY ARE NOT TO SCALE AND MAY NOT REFLECT EXISTING CONDITIONS. AS BUILTS MUST BE VERIFIED.

# SOUTHSIDE OFFICE BUILDING 7700 SOUTH MAIN ST., HOUSTON, TX. LEVEL 01

**CDPI**  
DOUGLASS • PYE  
Architecture • Interiors • Planning  
5065 Westheimer Rd.  
Suite #1100  
Houston, Tx. 77046  
Tel: 713-783-5900  
Fax: 713-783-5066  
www.cdpi-dougllass-pye.com

CB220509.01- CD  
SEPT. 4, 2020

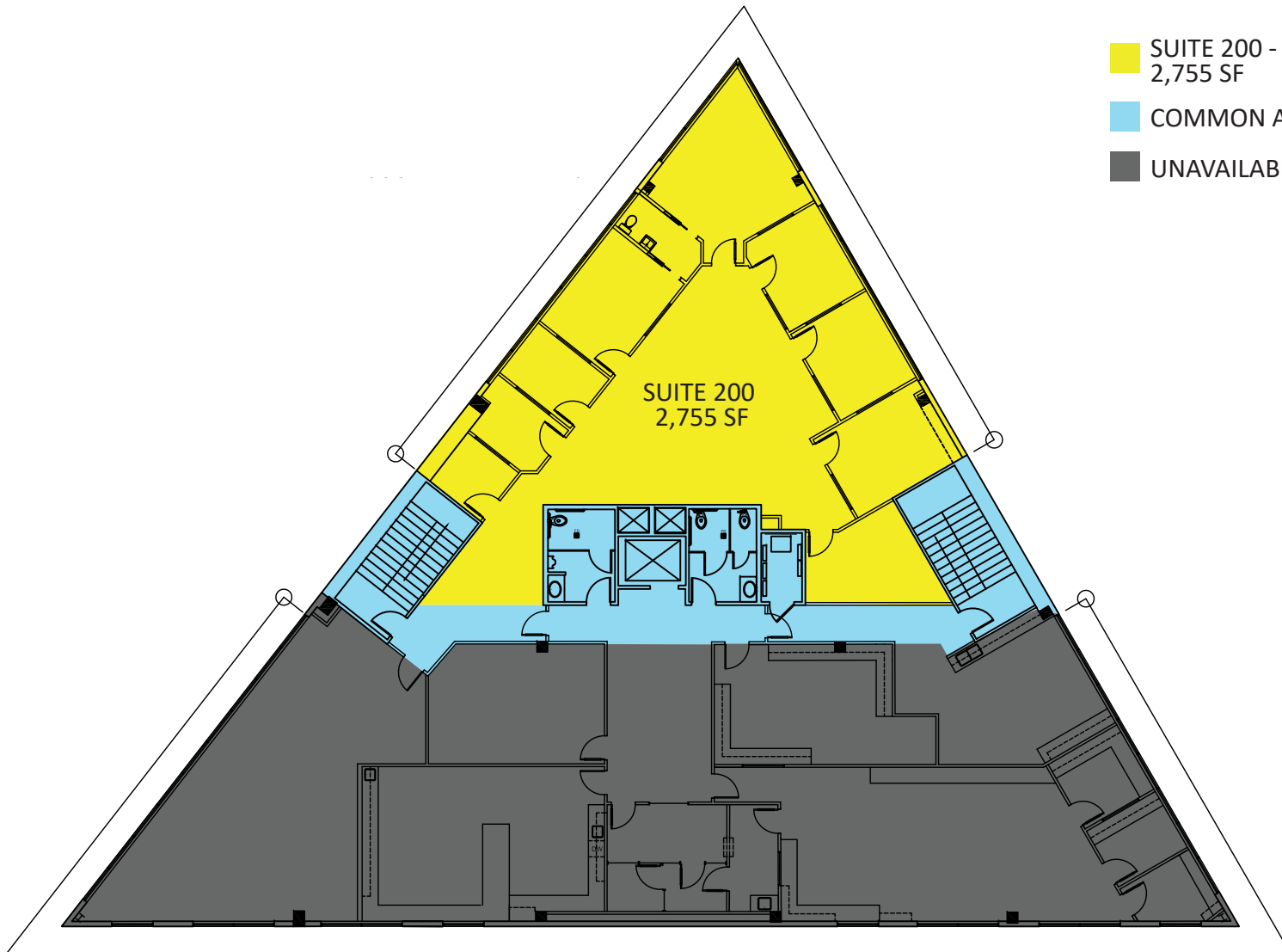

- SUITE 200 - AVAILABLE  
2,755 SF
- COMMON AREA
- UNAVAILABLE

SUITE 200  
2,755 SF

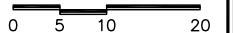

FLOOR PLANS ARE FOR CONCEPTUAL PURPOSES ONLY; THEY ARE NOT TO SCALE AND MAY NOT REFLECT EXISTING CONDITIONS. AS BUILTS MUST BE VERIFIED.

# SOUTHSIDE OFFICE BUILDING 7700 SOUTH MAIN ST., HOUSTON, TX. LEVEL 02

**CDPI**  
DOUGLASS • PYE  
Architecture • Interiors • Planning  
5065 Westheimer Rd.  
Suite #1100  
Houston, Tx. 77046  
Tel: 713-783-5900  
Fax: 713-783-5066  
www.cdpi-dougllass-pye.com

CB220509.01- CD  
SEPT. 4, 2020



- SUITE 330 - AVAILABLE  
1,052 SF
- SUITE 333 - AVAILABLE  
1,703 SF
- SUITE 320 - AVAILABLE  
2,452 SF
- SUITE 346 - AVAILABLE  
2,625 SF
- COMMON AREA

FLOOR PLANS ARE FOR CONCEPTUAL PURPOSES ONLY; THEY ARE NOT TO SCALE AND MAY NOT REFLECT EXISTING CONDITIONS. AS BUILTS MUST BE VERIFIED.

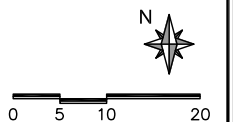

# SOUTHSIDE OFFICE BUILDING 7700 SOUTH MAIN ST., HOUSTON, TX. LEVEL 03

**CDPI**  
 Architecture • Interiors • Planning  
 5065 Westheimer Rd.  
 Suite #1100  
 Houston, Tx. 77046  
 Tel: 713-783-5900  
 Fax: 713-783-5066  
 www.cdpi-douglas-pye.com

CB220509.01 - CD  
 SEPT. 4, 2020

