



6,094 SF AVAILABLE

2038 - 2048 Weems Road
Suite C2044-B
Tucker, GA 30084

FOR LEASE



PROPERTY INFORMATION

Total Size: 6,094 SF
Office: 1,700 SF
Warehouse: 4,394 SF
Loading: Two (2) Dock High Doors
Clear Height: 20'
Available: Immediately
Power: 800 amps

HVAC THROUGHOUT WAREHOUSE
COLD STORAGE OPPORTUNITY



For more information, please contact:

CLARK OWEN

Office: (404) 595-1553
Cell: (706) 474-3727
cowen@apexindustrialre.com

MORGAN MCMENAMY

Office: (404) 806-6631
Cell: (404) 771-1199
mmcmenamy@apexindustrialre.com



Although the information contained therein was provided from sources believed to be reliable, Apex Industrial makes no representation, expressed or implied, as to its accuracy and said information is subject to errors, omissions or changes.



6,094 SF AVAILABLE

2038 - 2048 Weems Road

Suite C2044-B

Tucker, GA 30084

FLOOR PLAN

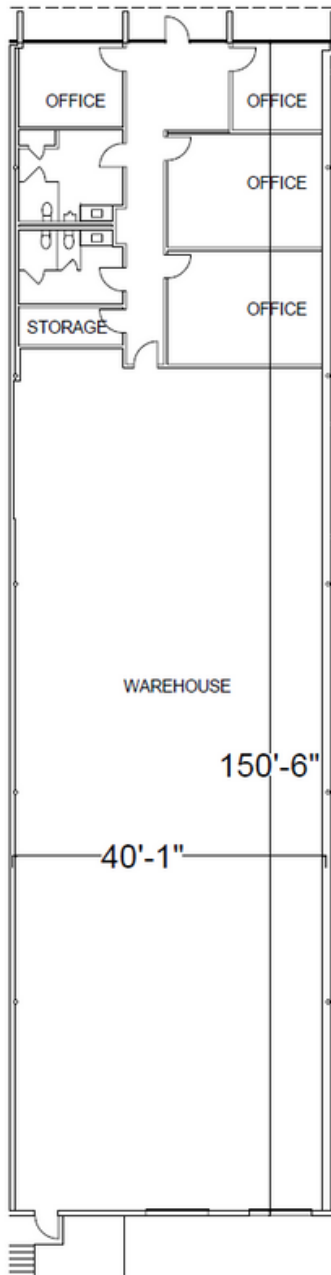

MAP



For more information, please contact:

CLARK OWEN

Office: (404) 595-1553
Cell: (706) 474-3727
cowen@apexindustrialre.com

MORGAN MCMENAMY

Office: (404) 806-6631
Cell: (404) 771-1199
mmcmenamy@apexindustrialre.com



Although the information contained therein was provided from sources believed to be reliable, Apex Industrial makes no representation, expressed or implied, as to its accuracy and said information is subject to errors, omissions or changes.