

2,000 - 6,430 SF



# Holiday GALLERY

1575-1595 HOLIDAY LANE  
FAIRFIELD | CA

FOR INFORMATION, CONTACT:

**BRIAN ALT**

Senior Leasing Manager  
Direct: 916-200-9446  
balt@crosspointrealty.com  
DRE #01504949

**CARTER HEMMING**

chemming@crosspointrealty.com  
CA DRE #01123464

**COURTNEY JONES**

cjones@crosspointrealty.com  
CA DRE #01232209



SUITE	SF	RENT	NNN
B4	2,000 - 6,430 *divisible	Inquire	\$8.35

- Excellent 1-80 Exposure (206,441 ADT)
- End-cap Space on Fairfield's Best Intersection
- Adjacent to Travis Blvd. Exit





2,000 - 6,430 SF

Your Bay Area Flooring Authority  
**THE FLOORSTORE**

**5.11** 

**MATTRESS FIRM**

the **HOT TUB** store

**COSMO PROF**

**HARBOR FREIGHT**

Holiday Ln

Holiday Ln

Holiday Ln

Dwight D. Eisenhower

45

INTERSTATE  
**80**

206,441 ADT



# *Holiday* GALLERY

 = AVAILABLE



Suite B4

AVAILABLE  
SUITE B4  
2,000 - 6,430 SF



SIGNAGE

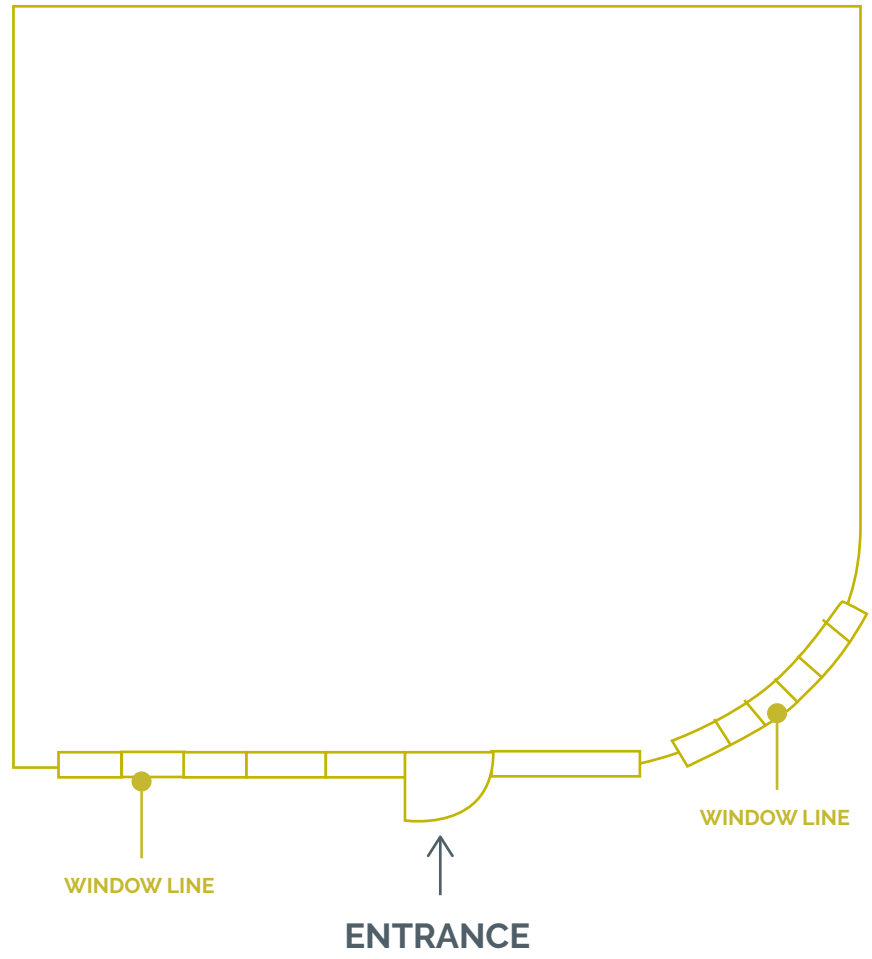

WINDOW LINE

ENTRANCE

WINDOW LINE



TO VACAVILLE

**BARNES & NOBLE** **SPORTSMAN'S WAREHOUSE**

**CHIPOTLE MEXICAN GRILL** **PETSMART**



**GATEWAY PLAZA**

**HOBBY LOBBY** **TRADER JOE'S** **ROSS DRESS FOR LESS**

**85°C** **Michaels** **petco**

**HEALTH NorthBay**  
154-beds

**Food4Less**

*Holiday*  
**GALLERIA**



I-80 206.444 ADT

**SOLANO MALL**

**REGAL** **DICK'S SPORTING GOODS**

**JCPenney** **H&M** **TESLA**

**macy's** **SHOEPALACE** **WAVE & MASTER'S**

**Raley's** **IN-N-OUT BURGER**

**Staples**



**ARMIJO HIGH**  
1,967 students

LOCATION MAP  
*Holiday*  
GALLERIA

TO SAN FRANCISCO

PRINCIPAL TRADE AREA

# Highlights

This center is positioned just off the Travis Blvd. / Interstate 80 interchange and draws shoppers from Fairfield and the greater Solano County area due to its excellent freeway visibility and accessibility.

- **Multi-tenant retail center** covering about 42,657 square feet across three buildings with frontage on I-80.
- **Strong freeway signage and visibility**

<b>PRINCIPAL TRADE AREA</b>	
<b>AVG. HH INCOME</b>	<b>\$118,231</b>
<b>POPULATION</b>	<b>227,498</b>

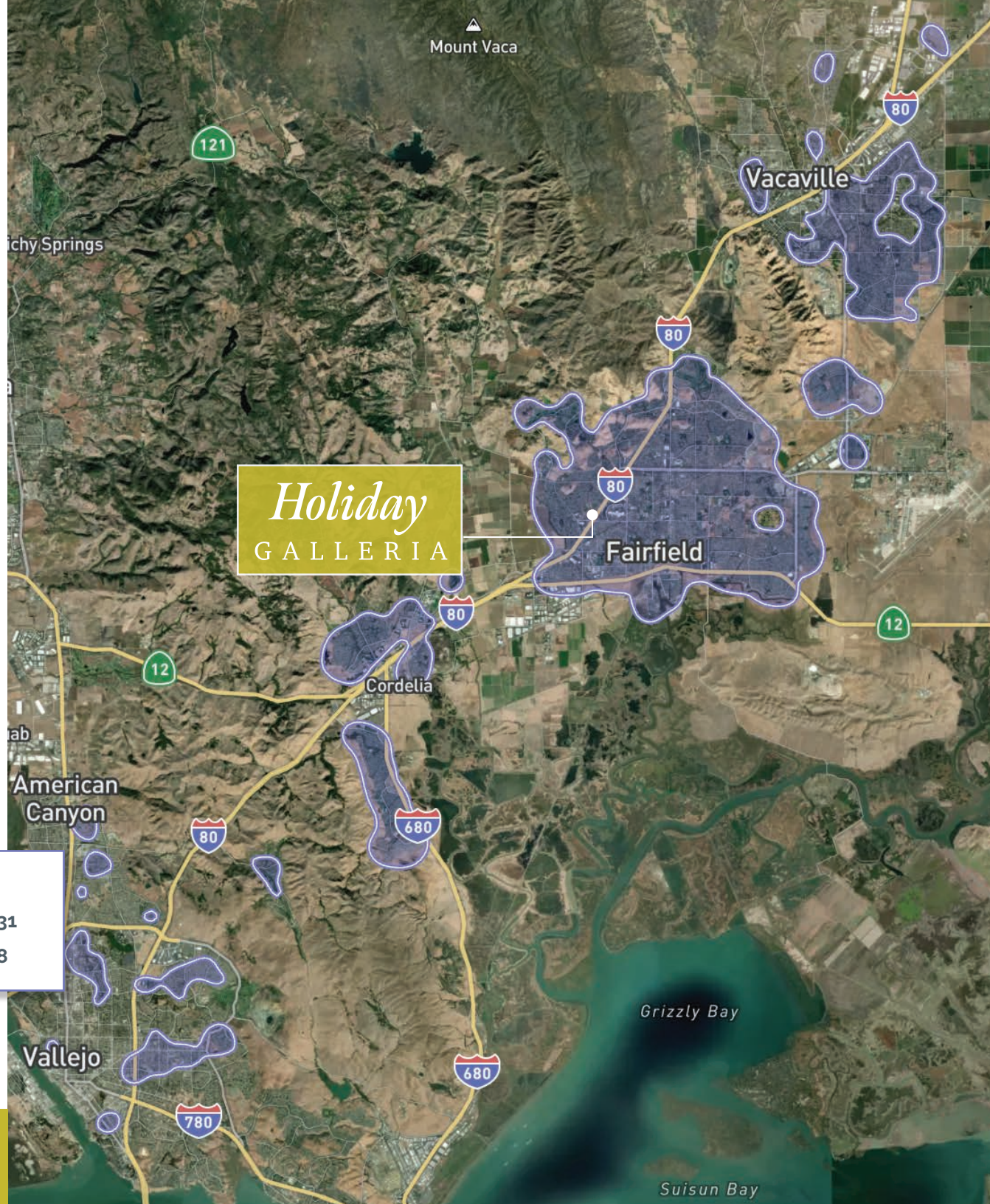



**CROSSPOINT REALTY SERVICES, INC.**

415-288-6888

[www.crosspointrealty.com](http://www.crosspointrealty.com)

FOR INFORMATION, CONTACT:

**BRIAN ALT**

Senior Leasing Manager

Direct: 916-200-9446

[balt@crosspointrealty.com](mailto:balt@crosspointrealty.com)

DRE #01504949

**CARTER HEMMING**

[chemming@crosspointrealty.com](mailto:chemming@crosspointrealty.com)

CA DRE #01123464

**COURTNEY JONES**

[cjones@crosspointrealty.com](mailto:cjones@crosspointrealty.com)

CA DRE #01232209