



PROPERTY DESCRIPTION

TRACT 2

BEING a 105.981 acre tract of land situated in the JOHNSON COUNTY SCHOOL LAND SURVEY, ABSTRACT NO. 722, JOHNSON COUNTY, TEXAS, being more particularly described as follows: ...

PROPERTY DESCRIPTION

TRACT 1

BEING a 667.112 acre tract of land situated in the JOSEPH D. ROBERTSON SURVEY, ABSTRACT NO. 435, JOHNSON COUNTY, TEXAS, being more particularly described as follows: ...

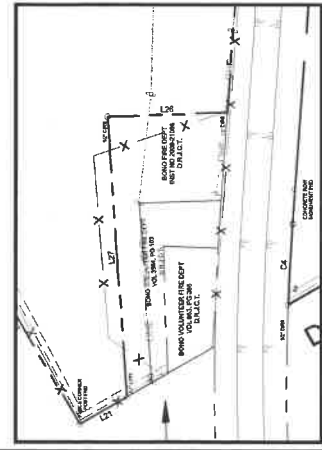

DETAIL "A"

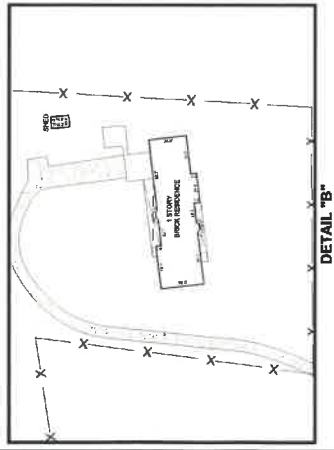

DETAIL "B"

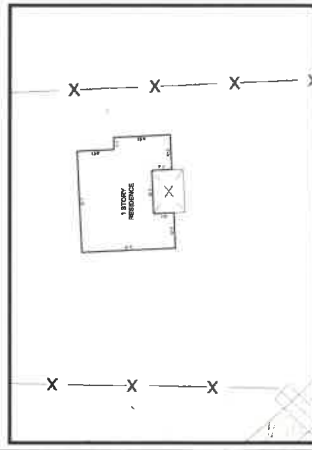

DETAIL "C"

- LEGEND
1. BELLAND CRYSTAL
2. BELLAND CRYSTAL
3. BELLAND CRYSTAL
4. BELLAND CRYSTAL
5. BELLAND CRYSTAL
6. BELLAND CRYSTAL
7. BELLAND CRYSTAL
8. BELLAND CRYSTAL
9. BELLAND CRYSTAL
10. BELLAND CRYSTAL
11. BELLAND CRYSTAL
12. BELLAND CRYSTAL
13. BELLAND CRYSTAL
14. BELLAND CRYSTAL
15. BELLAND CRYSTAL
16. BELLAND CRYSTAL
17. BELLAND CRYSTAL
18. BELLAND CRYSTAL
19. BELLAND CRYSTAL
20. BELLAND CRYSTAL
21. BELLAND CRYSTAL
22. BELLAND CRYSTAL
23. BELLAND CRYSTAL
24. BELLAND CRYSTAL
25. BELLAND CRYSTAL
26. BELLAND CRYSTAL
27. BELLAND CRYSTAL
28. BELLAND CRYSTAL
29. BELLAND CRYSTAL
30. BELLAND CRYSTAL
31. BELLAND CRYSTAL
32. BELLAND CRYSTAL
33. BELLAND CRYSTAL
34. BELLAND CRYSTAL
35. BELLAND CRYSTAL
36. BELLAND CRYSTAL
37. BELLAND CRYSTAL
38. BELLAND CRYSTAL
39. BELLAND CRYSTAL
40. BELLAND CRYSTAL
41. BELLAND CRYSTAL
42. BELLAND CRYSTAL
43. BELLAND CRYSTAL
44. BELLAND CRYSTAL
45. BELLAND CRYSTAL
46. BELLAND CRYSTAL
47. BELLAND CRYSTAL
48. BELLAND CRYSTAL
49. BELLAND CRYSTAL
50. BELLAND CRYSTAL
51. BELLAND CRYSTAL
52. BELLAND CRYSTAL
53. BELLAND CRYSTAL
54. BELLAND CRYSTAL
55. BELLAND CRYSTAL
56. BELLAND CRYSTAL
57. BELLAND CRYSTAL
58. BELLAND CRYSTAL
59. BELLAND CRYSTAL
60. BELLAND CRYSTAL
61. BELLAND CRYSTAL
62. BELLAND CRYSTAL
63. BELLAND CRYSTAL
64. BELLAND CRYSTAL
65. BELLAND CRYSTAL
66. BELLAND CRYSTAL
67. BELLAND CRYSTAL
68. BELLAND CRYSTAL
69. BELLAND CRYSTAL
70. BELLAND CRYSTAL
71. BELLAND CRYSTAL
72. BELLAND CRYSTAL
73. BELLAND CRYSTAL
74. BELLAND CRYSTAL
75. BELLAND CRYSTAL
76. BELLAND CRYSTAL
77. BELLAND CRYSTAL
78. BELLAND CRYSTAL
79. BELLAND CRYSTAL
80. BELLAND CRYSTAL
81. BELLAND CRYSTAL
82. BELLAND CRYSTAL
83. BELLAND CRYSTAL
84. BELLAND CRYSTAL
85. BELLAND CRYSTAL
86. BELLAND CRYSTAL
87. BELLAND CRYSTAL
88. BELLAND CRYSTAL
89. BELLAND CRYSTAL
90. BELLAND CRYSTAL
91. BELLAND CRYSTAL
92. BELLAND CRYSTAL
93. BELLAND CRYSTAL
94. BELLAND CRYSTAL
95. BELLAND CRYSTAL
96. BELLAND CRYSTAL
97. BELLAND CRYSTAL
98. BELLAND CRYSTAL
99. BELLAND CRYSTAL
100. BELLAND CRYSTAL

3900 W. U.S. HIGHWAY 67
TRACT 1
TRACT 2
667.112 ACRES 105.981 ACRES
LAND TITLE SURVEY

SITUATED IN THE
JOSEPH D. ROBERTSON SURVEY, ABSTRACT NO. 722
& THE JOHNSON COUNTY SCHOOLLAND SURVEY, ABSTRACT NO. 435
CITY OF CLEBURNE, JOHNSON COUNTY, TEXAS

BLUESTAR SURVEYING logo and contact information including phone number 817-234-1111 and website www.bluestarsurveying.com.

Professional Engineer Seal for Joseph D. Robertson, State of Texas, License No. 105981, Commission Expires 09/01/2024.

1/7 CHS 1/2" IRON ROD SET
STAMPED BLUESTAR SURVEYING
DATE: 08/15/24