



Warner Industrial Corporate Center – Phase 4

8300 – 8350 WARNER ROAD
PLAIN CITY, OHIO

Building Size

26,000 SF (80' x 325')

Lease Rate

\$13.25/SF Net

Operating Expenses

\$2.90/SF

Completion Date

July 2026

Property Highlights

- Varo Pruden metal wall panel, clear span – no column poles
- Suite sizes available range from 4,000 SF to 14,000 SF
- Grade Level 12' x14' overhead doors
- Tenant Improvement Allowance of \$18.00/SF (15% office at \$120.00/SF)

For information, please contact:

Eric J. Shea, SIOR

Managing Director

t 614-883-1011

m 614-560-9471

eric.shea@nrmk.com

150 East Broad Street
Suite 500,
Columbus, Ohio 43215
nrmk.com



NEWMARK

The information contained herein has been obtained from sources deemed reliable but has not been verified and no guarantee, warranty or representation, either express or implied, is made with respect to such information. Terms of sale or lease and availability are subject to change or withdrawal without notice.

WARNER INDUSTRIAL CORPORATE CENTER - PHASE 4



NEWMARK

WARNER INDUSTRIAL CORPORATE CENTER - PHASE 4

Availability



WARNER INDUSTRIAL CORPORATE CENTER - PHASE 4

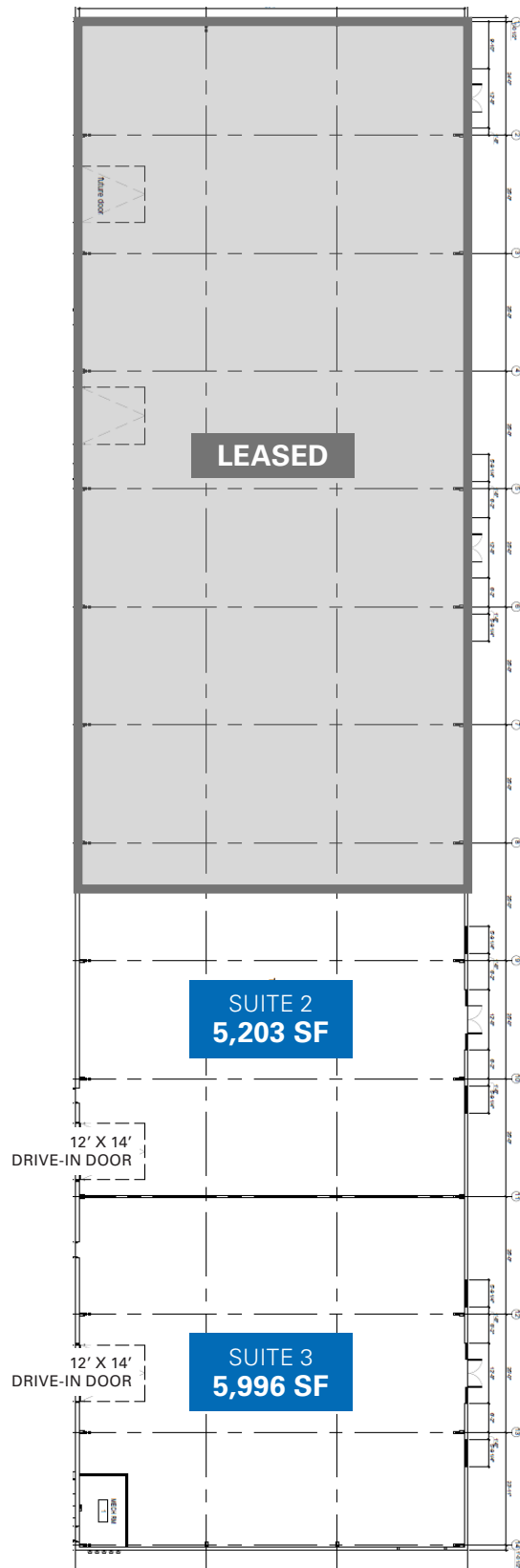
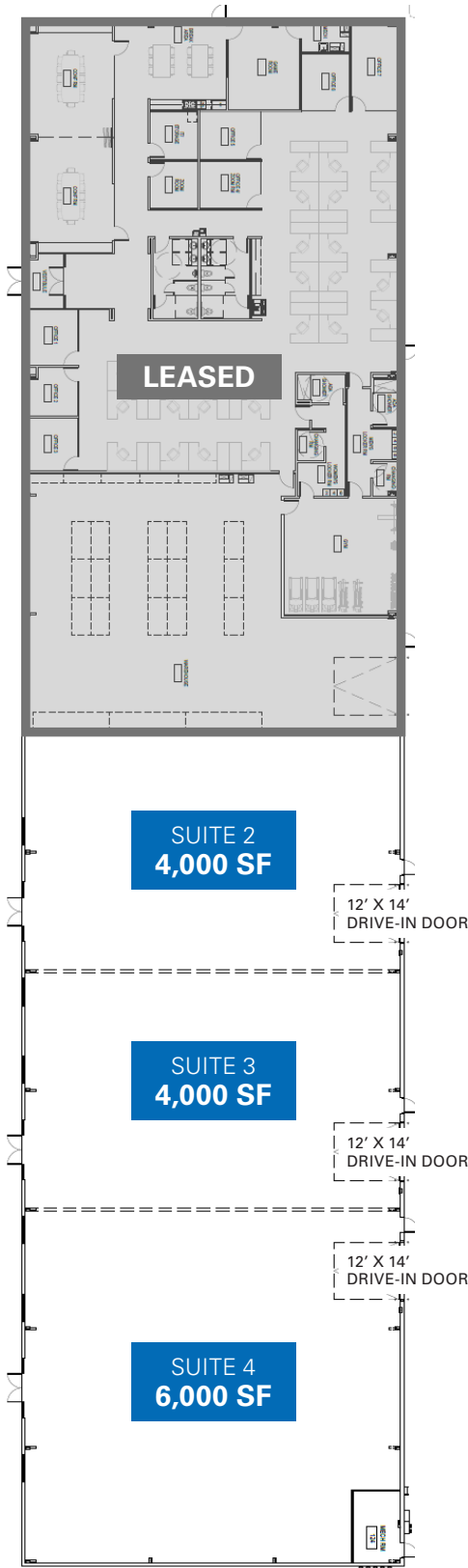

WARNER INDUSTRIAL CORPORATE CENTER - PHASE 4

