

# PLAZA 59

5825-5897 W. Indian School Road | Phoenix, AZ 85031



CAPITAL ASSET MANAGEMENT  
2701 E Camelback Rd • Suite 170 • Phoenix, AZ 85016



NATALIE JAAFAR  
602.386.5710 • njaafar@camcre.com

# PROPERTY SUMMARY

## PROPERTY HIGHLIGHTS

- 2,036 SF - 4,511SF Available  
(Suites 5851 & 5877 contiguous to 7,573SF)
- High trafficked retail center
- Anchored by CVS
- 126,000 +/- on the hard corner

## TRAFFIC COUNTS

N 59th Ave:	25,807 VPD
E Indian School Rd:	38,471 VPD
S 59th Ave:	30,088 VPD
W Indian School Rd:	32,431 VPD



## NEIGHBORING TENANTS



# SITE PLAN

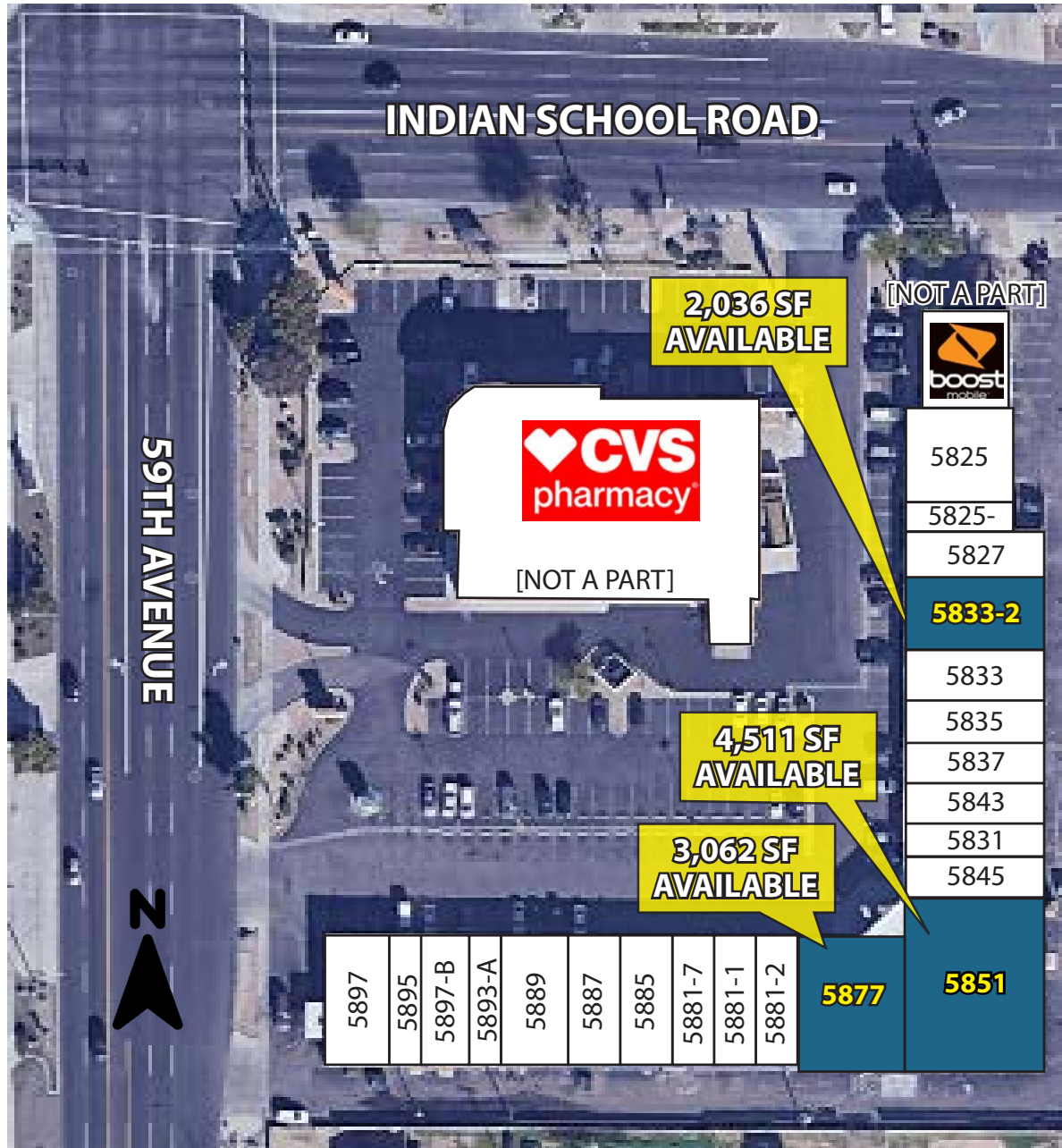

Suite	Tenant	SF
PAD2	Boost Mobile	NAP
5825	Tienda Santaneca	2,400
5825-	Mayte Alterations	--
5827	Aurora Laser Medical Spa	1,260
<b>5833-2</b>	<b>AVAILABLE</b>	<b>2,036</b>
5833	Premium Cutz Barber	1,100
5835	Rate Crushers	1,100
5837	Julie's Spa & Nails	1,100
5843	Boutique Anna's	1,100
5831	Karlo Luna Makeup Studio	1,100
5845	T-Mobile	1,100
<b>5851</b>	<b>AVAILABLE</b>	<b>4,511</b>
<b>5877</b>	<b>AVAILABLE (Contiguous to 7,573SF)</b>	<b>3,062</b>
5881-2	Cha Cha Cha Nutrition	1,100
5881-1	Azteca Bakery	1,100
5881-7	Beauty Salon	1,175
5885	Annabella's Income Tax & MVD Service	1,659
5887	Raspasados El Zalate	1,364
5889	Dona Mary Papiusas	2,022
5893-A	Sammy's Jewelry	600
5893-B	Smoke Shop	1,000
5895	Taco Fit	910
5897	RL Liquors	1,329
PAD	Clearly Water LTD	NAP



## DEMOGRAPHICS

POPULATION	1-MILE	3-MILE	5-MILE
2029 Projection	24,915	231,666	503,271
Current Year	23,205	215,667	467,649
Growth Current Year - 2029	1.5%	1.5%	1.5%

HOUSEHOLDS	1-MILE	3-MILE	5-MILE
2029 Projection	6,133	65,647	147,943
Current Year	5,705	61,019	137,172
Growth Current Year - 2029	1.5%	1.5%	1.6%

INCOME	1-MILE	3-MILE	5-MILE
Avg Household Income	\$72,536	\$62,190	\$66,162
Median Household Income	\$59,570	\$49,116	\$50,864