

**FOR LEASE**

# **GREEN VALLEY CIVIC CENTER**

2501-2651 N. Green Valley Parkway  
Henderson, NV 89014



**Pete Janemark, CCIM**

Senior Vice President

D: 702.527.7923 | C: 702.885.7383

[pete.janemark@svn.com](mailto:pete.janemark@svn.com)

NV #S.76731



All SVN® offices are independently owned and operated.

# PROPERTY SUMMARY



## OFFERING SUMMARY

<b>BUILDING SIZE:</b>	106,920 SF
<b>AVAILABLE SF:</b>	Contact Listing Broker
<b>LOT SIZE:</b>	5.96 Acres
<b>ZONING:</b>	CC
<b>APN:</b>	178-06-512-001, 002, 003, 004 and 178-06- 510-003

## PROPERTY OVERVIEW

Green Valley Professional Center is conveniently located single story office complex located at the intersection of Green Valley Parkway and Sunset Road in Henderson. The grounds are open and spacious with upgraded landscaping and break areas. The area offers substantial shopping, services and eateries in all direction, many within walking distance. The property is flanked by the Green Valley Library, and the intersection is served by two major bus routes.

## PROPERTY HIGHLIGHTS

- Signalized entrance
- Ample dedicated parking
- Ample shopping and services
- Central Location

**PETE JANEMARK, CCIM**  
O: 702.527.7923 | C: 702.885.7383  
pete.janemark@svn.com  
NV #S.76731

# 2551 GREEN VALLEY PARKWAY - SUITE 202 - ±2,237 SF

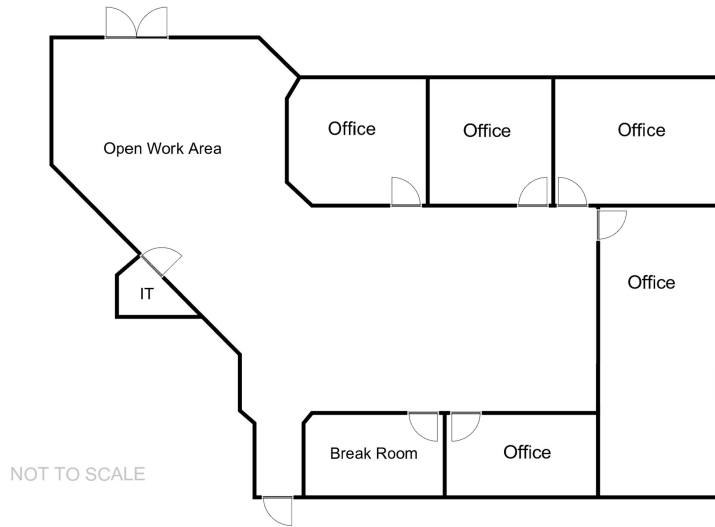

## SUITE DESCRIPTION

This suite features a double door glass entrance directly from the parking lot, a large open reception and work area, four closable offices, a conference room, a break room, an IT closet, and a second entrance.



**PETE JANEMARK, CCIM**

O: 702.527.7923 | C: 702.885.7383

pete.janemark@svn.com

NV #S.76731

# RETAILER MAP



**PETE JANEMARK, CCIM**  
 O: 702.527.7923 | C: 702.885.7383  
 pete.janemark@svn.com  
 NV #S.76731